

The original documents are located in Box 117, folder “New Hampshire - 8/6/1971 - Manchester - (Nashua; Bangor; Minot Island, ME)” of Byron M. "Red" Cavaney Files, Domestic Trips at the Gerald R. Ford Presidential Library.

Copyright Notice

The copyright law of the United States (Title 17, United States Code) governs the making of photocopies or other reproductions of copyrighted material. Gerald R. Ford donated to the United States of America his copyrights in all of his unpublished writings in National Archives collections. Works prepared by U.S. Government employees as part of their official duties are in the public domain. The copyrights to materials written by other individuals or organizations are presumed to remain with them. If you think any of the information displayed in the PDF is subject to a valid copyright claim, please contact the Gerald R. Ford Presidential Library.

August 5, 1971

3:00 p.m.

DETAILED STAFF SCHEDULE

PRESIDENT'S TRIP TO
MANCHESTER/NASHUA, NEW HAMPSHIRE
BANGOR, MAINE AND MINOT ISLAND

Friday, August 6, through Sunday, August 8, 1971

Friday, August 6, 1971

Washington, D. C. to Manchester/Nashua to Bangor to Minot Island

10:30 a.m.

Baggage Call, West Basement

12:30 p.m.

The following are requested to be on board
Marine One on the South Lawn:

H. R. Haldeman
D. Moore
R. Ziegler
D. Chapin
P. Buchanan
L. Higby
Doctor Tkach
Military Aide

The following staff and guests are requested
to be on board S '76 at Andrews AFB.

Mrs. George P. Shultz
Senator Norris Cotton (R-N. H.)
Senator Thomas J. McIntyre (D-N. H.)
Congressman Louis C. Wyman (R-N. H.)
Congressman James C. Cleveland (R-N. H.)
J. Cavanaugh
S. Bull

BAGGAGE NOTE: Passengers boarding S '76 at
12:30 p.m. are requested to
have their baggage at the DV lounge
not later than 12:15 p.m. in order
that it may be flouroscooped and
placed on board the aircraft.

NATIONAL ARCHIVES AND RECORDS SERVICE
WITHDRAWAL SHEET (PRESIDENTIAL LIBRARIES)

FORM OF DOCUMENT	CORRESPONDENTS OR TITLE	DATE	RESTRICTION
SCHEDULE	MOTORCADE ROUTE pg 2-3	8/5/71	B

FILE LOCATION

RED CAVANEY FILES, DOMESTIC TRIP, BOX 117, FOLDER: NEW HAMPSHIRE - 8/6/1971 -
 MANCHESTER - (NASHUA, BANGOR, MINOT ISLAND, ME)

RESTRICTION CODES

- (A) Closed by Executive Order 12356 governing access to national security information.
- (B) Closed by statute or by the agency which originated the document.
- (C) Closed in accordance with restrictions contained in the donor's deed of gift.

JJO
2/10/16

STAFF AND GUEST INSTRUCTIONS

Motorcade assignments are the same as on arrival at the Nursing Home, except delete Mrs. Shultz.

4:15 p. m.

ARRIVE MANCHESTER AIRPORT.

Board S '76.

STAFF AND GUEST INSTRUCTIONS

The passenger list for S '76 will be the same as on arrival with the exceptions of the following additions and deletions:

Additions: R. Walker
M. Goode

Deletions:

Senator Cotton
Senator McIntyre
Congressman Wyman
Congressman Cleveland
Mrs. Shultz

4:25 p. m.

S '76 DEPARTS EN ROUTE BANGOR, MAINE.

(Flying time: 55 mins.)
(No time change)

5:20 p. m.

ARRIVE BANGOR, MAINE

The President and Mrs. Nixon will be met by:

Governor and Mrs. Kenneth Curtis (D-Maine)
Mayor and Mrs. John H. Cox (R-Bangor)

A CROWD IS EXPECTED AT THE AIRPORT

5:35 p. m.

DEPART BANGOR, MAINE via helicopter en
route Minot Island.

(Flying time: 20 mins.)

Helicopter assignments are as follows:

The President and Mrs. Nixon
Ensign and Mrs. Eisenhower
H. R. Haldeman
L. Higby
Doctor
Military Aide

STAFF INSTRUCTIONS

Staff returning to Andrews Air Force
Base will board Convair at Bangor
Airport for the return flight.

5:55 p. m.

ARRIVE MINOT ISLAND.

WEEKEND

Sunday, August 8, 1971
Minot Island to Washington, D. C.

4:30 p. m. DEPART MINOT ISLAND via helicopter en route Bangor, Maine.

STAFF AND GUEST INSTRUCTIONS

Helicopter assignments are as follows:

The President and Mrs. Nixon
Ensign and Mrs. Eisenhower
H. R. Haldeman
L. Higby
Doctor
Military Aide

4:50 p. m. ARRIVE BANGOR AIRPORT.

Board S '76.

4:55 p. m. S '76 DEPARTS BANGOR, MAINE en route Andrews Air Force Base.

(Flying time: 1 hr. 20 mins.)
(No time change)

STAFF AND GUEST INSTRUCTIONS

The following passengers will be on board:

The President and Mrs. Nixon
Ensign and Mrs. Eisenhower
Senator Margaret Chase Smith
H. R. Haldeman
L. Higby
Doctor
Military Aide

DINNER WILL BE SERVED ON BOARD

6:15 p. m.

ARRIVE ANDREWS AFB.

The President and Mrs. Nixon board
helicopter.

Ensign and Mrs. Eisenhower board
Jetstar en route Florida.

6:20 p. m.

HELICOPTER DEPARTS ANDREWS AFB
en route South Lawn.

6:35 p. m.

ARRIVE SOUTH LAWN.

AIRPORT DIAGRAM MANCHESTER N. H.

LEGEND :
 X - STAKES
 O - BARREL

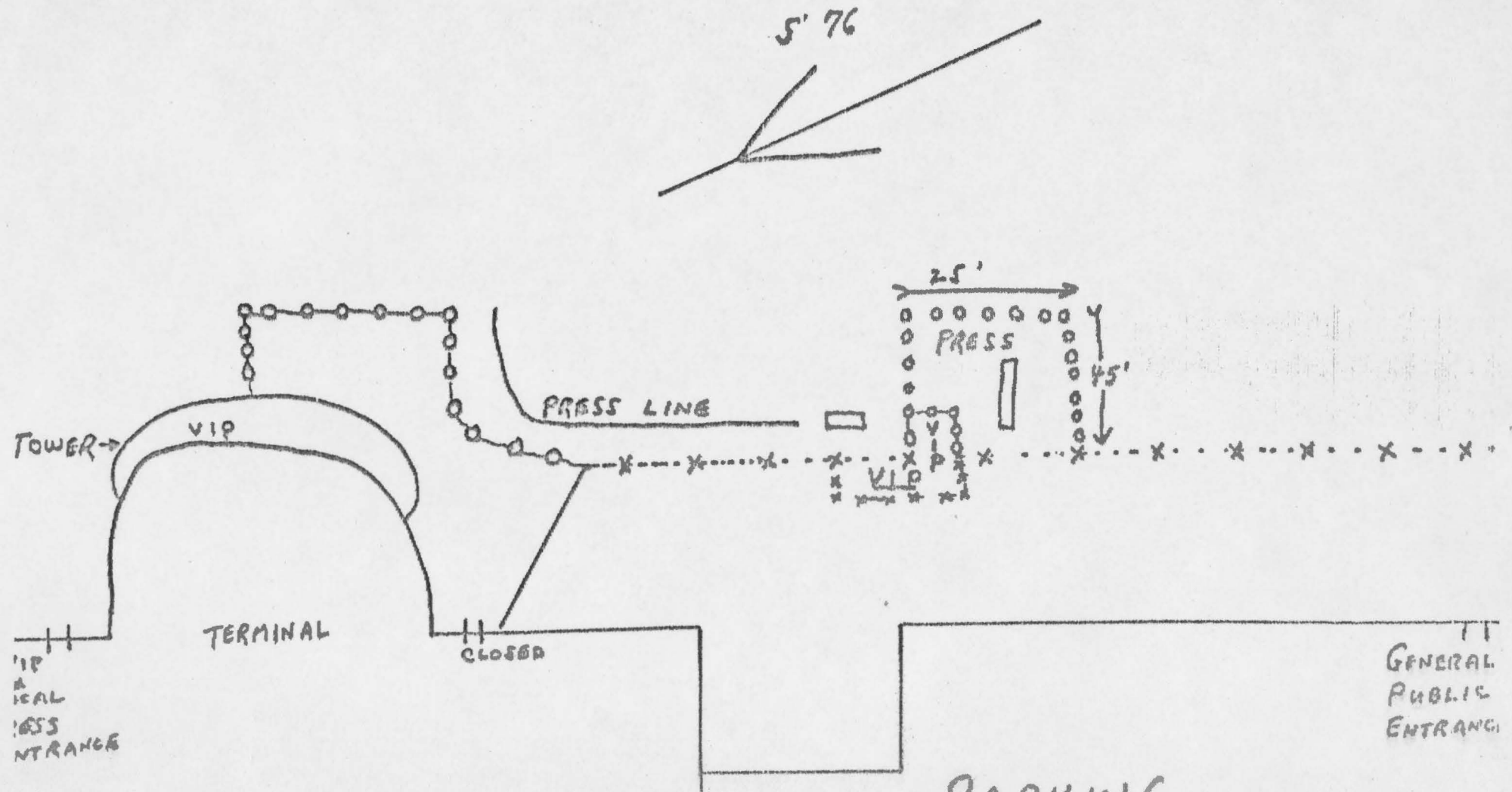

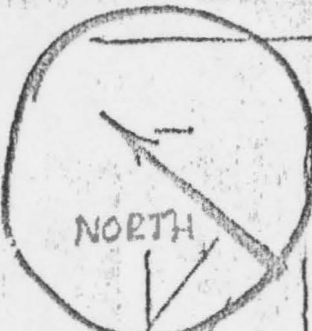
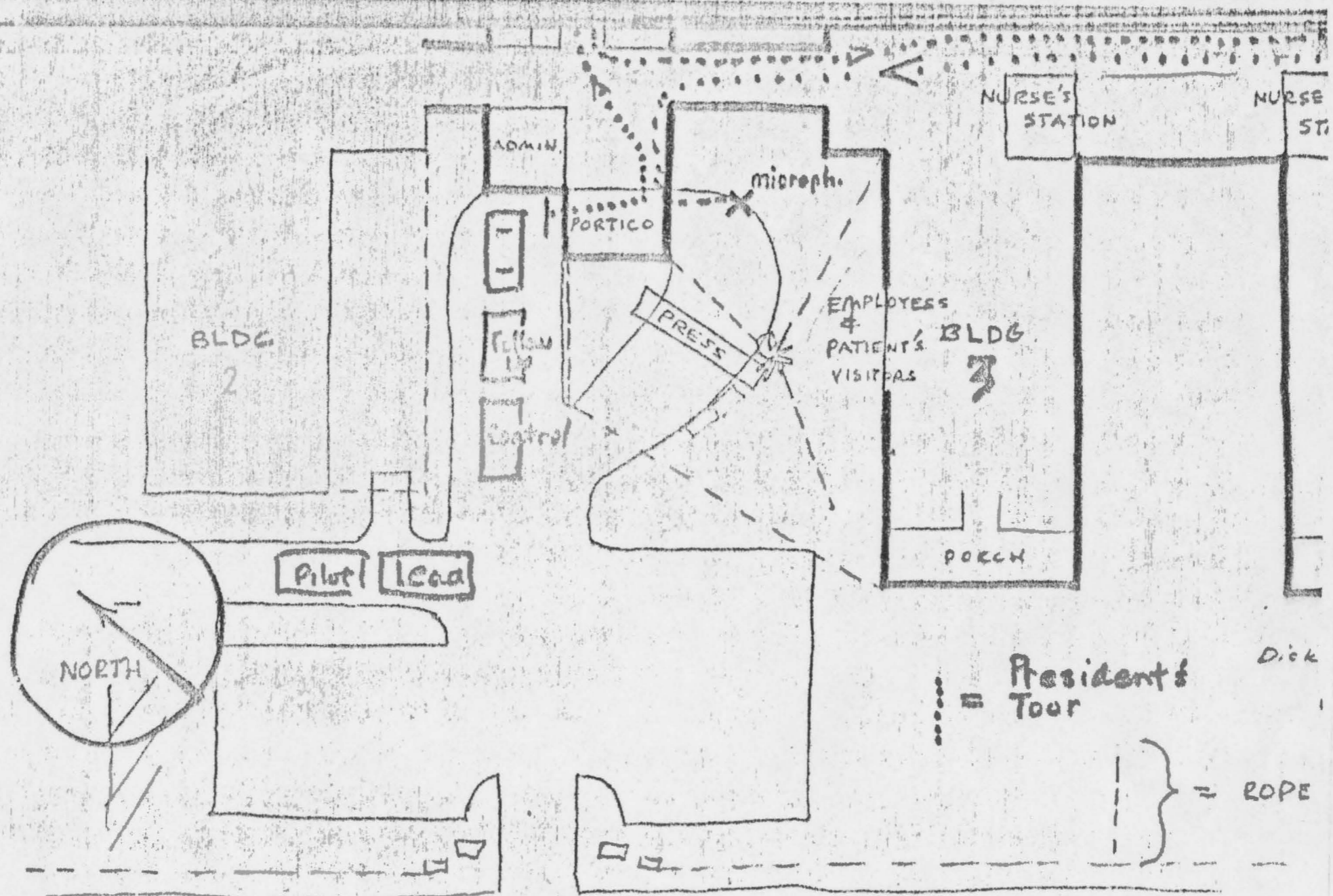

55 HARRIS ROAD

6:30

8-5-71

GREENBRIAR NURSING HOME

8/6/71
7:50 AM

PRESS PLANE
←

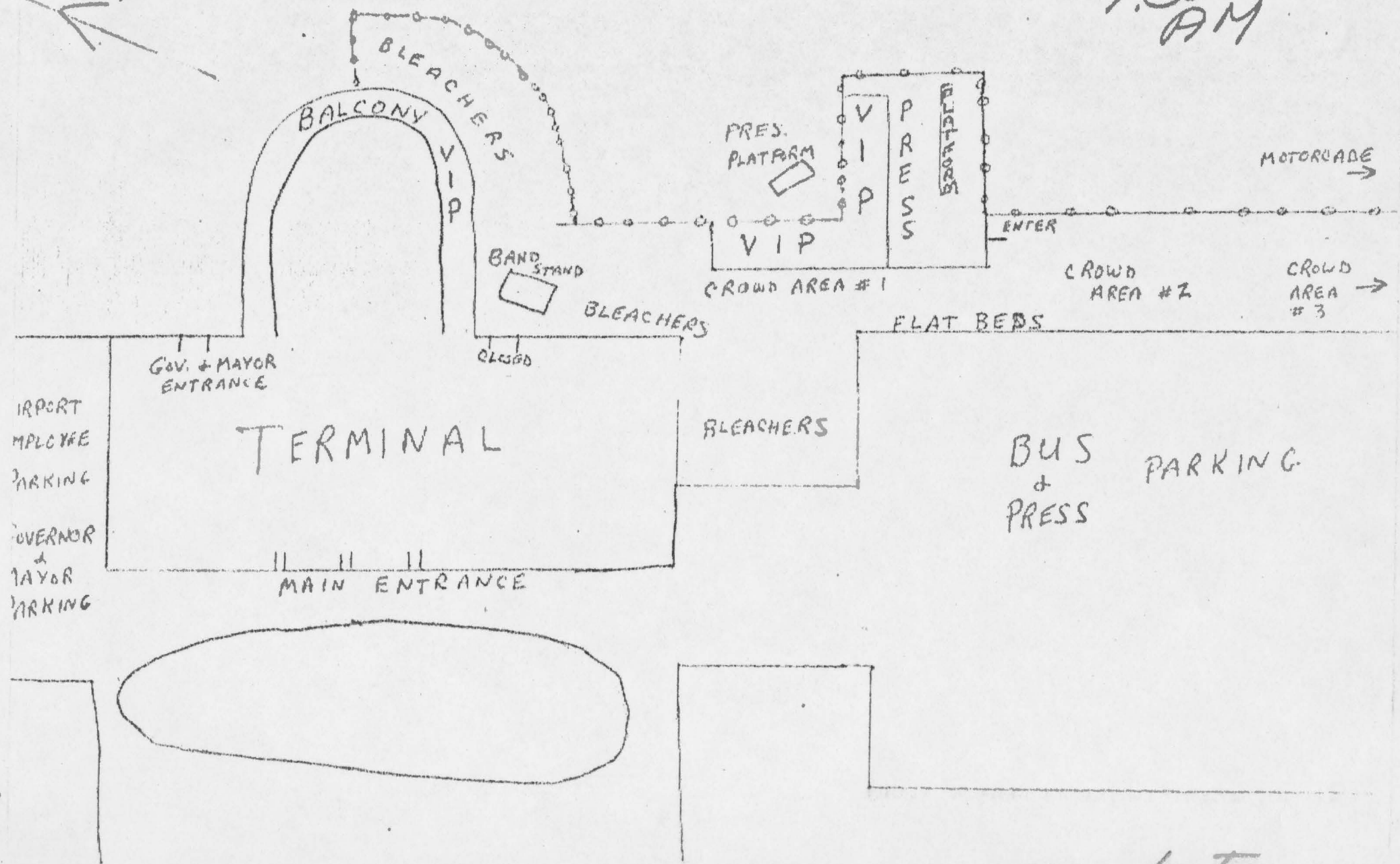

Manchester

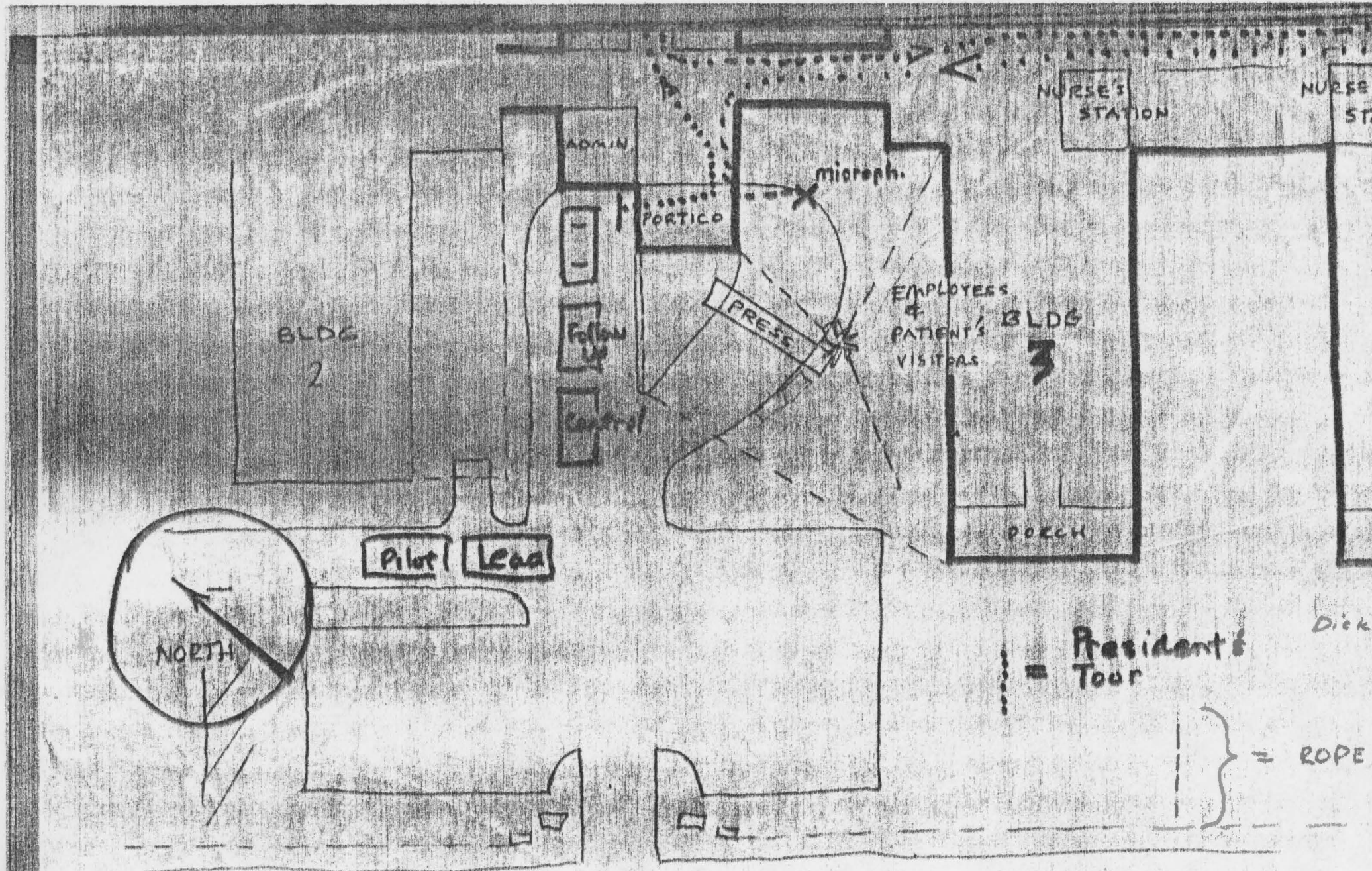

55 HARRIS ROAD

6:30

8.5.71

GREENBRIAR NURSING HOME

MANCHESTER AIRPORT

8/5/71

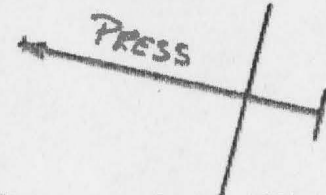
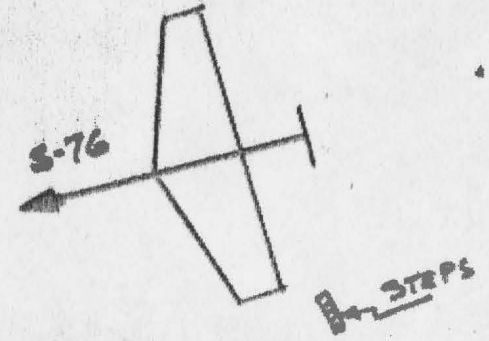

MOTORCADE

AIRPORT
EMPLOYEE
PARKING

PARKING
GOV. & MAYOR

BALCON
CROWD
AREA
#1

GOV.
MAYOR
ENTRANCE



STEPS

VIP

CROWD AREA #1
ELEVATION

BLEACHERS FLAT BEDS

CROWD
AREA
#2

CROWD
AREA
#3

BUS
&
PRESS
PARKING



August 9, 1971

TO: MIKE SMITH
FROM: JULIE ROWE
RE: PRESIDENTIAL THANK YOU CARDS

Event: Manchester/Nashua, New Hampshire

James Barakis
72 N. Adams St.
Manchester, NH 03104

Mrs. Theresa Fradette
167 Moore St.
Manchester, NH 03102

Paul L. Michaud
64 Merrimack St.
Manchester, NH 03101

Mrs. Mary Mongan
22 Elizabeth Ave.
Manchester, NH. 03103

Joseph C. Chevalier
Prospect St.
Manchester, NH 03104

Mrs. Ellen Pariseau
51 Mercier Ave. 03102
Manchester, NH. 03102

Earl A. Rinker III
851 N. Chestnut St.
Manchester, NH 03104

Mrs. Esther Hurd
136 N. Main St.
Concord, NH

Alfred R. Francoeur
101 Garfield St.
Manchester 03101

Mrs. Nancy Hebert
Cohen-Kelley Assoc.
Suite 200
Carpenter Hotel 03101

Senator Richard Ferdinando
827 Beech St.
Manchester, NH. 03104

Honorable Bernard Streeter, Jr.
26 Indiana Dr.
Nashua, NH

John G. Mongan
22 Elizabeth Ave. 03103
Manchester, NH. 03103

Miss Helen Martin
P. O. Building
Manchester, NH

Mrs. Carol Acorace
410 Bremer St.
Manchester, NH 03102

Mrs. Carol Bennett
P. O. Building
Manchester, N. H.

Hionia Pipilas
4 Denise Street
Nashua, NH

Pamela Feriz
4 Stevens Street.
Nashua, NH

Ed Lecius, Jr.
16 Grove Street
Nashua, NH.

Raymond Ennis
Accurate Printing Company
111 Lock St.
Nashua, N. H.

Donald Davidson
71 Browning Ave.
Nashua, N. H.

August 9, 1971

TO: MIKE SMITH
FROM: JULIE ROWE
RE: PRESIDENTIAL THANK YOU LETTERS
Event: Manchester/Nashua, New Hampshire
Date: August 6, 1971
Advancements: Bill Henkel, Dewey Clower

The Honorable Walter R. Peterson
Governor, State of New Hampshire
State House
Concord, New Hampshire 03301

Governor Peterson greeted RN and Mrs. Nixon at the airport. Gov. Peterson accompanied the Pres. to the Greenbriar Nursing Home. (NOTE: he did not ride with RN or did he tour the home with RN.) Mrs. Peterson also greeted at the airport.

The Honorable Charles R. Stanton
Mayor, Manchester, New Hampshire
City Hall
Manchester, New Hampshire 03101

Greeted the President at the airport. Presented the Pres. with the key to the city. Mrs. Stanton also was in the receiving line.

Miss Cynthia A. Frink
1063 Union
Manchester, New Hampshire 03104

Was in the receiving line that greeted the Pres. RN asked Cynthia to join him on the platform while he spoke of her idealism and qualities. (RN used an excerpt from her valadictory speech in his speech at the National Archives on July 3, 1971.)

Mr. William H. Thoms
Main Street
New Ipswich, New Hampshire 03071

Bill Thoms is the Administrator of the Greenbriar Nursing Home. He greeted RN. He conducted the Pres. on the tour of the facility. He introduced the Pres. to the various patients. (NOTE: the Pres. stated that he would send an HEW representative to examine more closely the facility.)

Mr. Gerald P. Carmen
308 Crestview Circle
Manchester, N. H. 03104

Carmen was Overall Ch-Chairman of the Manchester Welcome Nixon Committee. He is the city Republican leader and provided his organization and his leadership. He worked long and hard to make the arrival a success. He also will be the Republican candidate for Mayor of Manchester. (NOTE: RN might wish him good luck) He met RN at the airport as RN was departing for ~~MA~~ Maine.

Mr. Joseph J. Acorase
410 Bremer Street
Manchester, N. H. 03102

Was Co-Chairman of the Manchester Welcome Nixon Committee. He was the indispensable individual who always got the job done.

The Honorable Dennis Sullivan
Mayor, City of Nashua
City Hall
Nashua, New Hampshire

Issued Welcoming Proclamation and on extremely short notice had key to the City of Nashua made. He met RN in front of the Nashua City Hall and presented the key.

Mr. Robert Whalen
Rye, New Hampshire

Bob Whalen is the Republican State Chairman. He was cooperative and made available the key personnel. He met RN at the airport.

Mr. Richard L. Fortin
441 Bartlett Street
Manchester, N. H. 03102

Was chairman of the airport arrangement committee.

~~Mr. Robert F. Thibault~~
Mr. Robert F. Thibault
645 Amory Street
Manchester, New Hampshire 03102

Was physical facilities chairman at the airport. Was instrumental in making arrangements for the summer camp children getting to the airport.

Mr. Robert J. Cohen
12 Rebel Lane
Manchester, NH 03104

Was Press and Publicity Chairman. Prepared the news releases (they were excellent) and made all the arrangements for the New England press.

Mrs. Yolanda Guthera
WSMN
502 Hollis Street
Nashua, NH

Advance Secretary. Was great providing the Advance Team with local information and volunteers. Arranged radio spots and public service announcements.

Mr. D. Allan Rock
WSMN
502 Hollis St.
Nashua, NH

Was responsible in large measure for the great crowd and reception the Pres. received in Nashua. Obtained and distributed handbills and turned his radio station, WSMN, over to almost full time public service announcements regarding RN's visit.

Mrs. Kathy Unzeld
Danbury Circle
Amherst, NH

Advance Staff Secretary.

Hand del to

Jerry Warren

DETAILED TOUR ITINERARY

GREENBRIAR NURSING HOME

Mrs. Nixon
Mrs. George P. Shultz
Mrs. Blanche D'Amour-Director Nursing Services
Ginger Kanzer-Ass't D.N.S.

3:05PM Start tour from main entrance proceed to building #2 - Nurse station

Mrs. D'Amour will outline the basic function of building #2 which houses those patients with little or no rehabilitation potential, but needing great amount of personal care. Possibility exists to meet John West, 23 year old wheelchair patient who would like to make an afghan for Mrs. Nixon. If this is possible, he will offer her a choice of colors.

Another possibility may have Mrs. Nixon meet a young girl with multiple sclerosis who is one of the very few patients under "remotivattinn" (putting extreme cases back in touch with reality). ei: getting them to read magazines etc.

3:15PM Proceed through dining area towards nurses's station in building #1.

Mrs. D'Amour will explain that building #1 houses patients who are immediate post hospital and require generally the most medical attention.

Possibility exists to have Mrs. Nixon meet Jim Atwood a young victim of multiple sclerosis, also, and a former advertising executive. After suffering several strokes, as recently as two weeks ago, Mr. Atwood has finally completed a book of poems which he has typed by using a pencil in his mouth. (perhaps it would be appropriate for Mrs. Nixon to request that she be sent a copy.

3:20PM Depart building #1 area and return to front entrance and await Presidential tour.

DETAILED TOUR ITINERARY

GREENBRIAR NURSING HOME

DEVED
8/6/71
7:15 AM

7:05PM Start tour from main entrance - proceed to physical therapy area

Mr. Thoms will explain that with relatively inexpensive equipment and a good registered physical therapist, Greenbriar has been extremely successful in restoring patients to maximum capability.

7:10PM Proceed through corridor toward building #3 and nurses's station

Mr. Thoms will explain the basic functions of the first three buildings as follows: Building #1 houses patients who are immediate post-hospital and require generally, the most medical attention. Building #2 houses those patients with little or no rehabilitation potential but needing great amount of personal care. Building #3 has those patients who have made partial recoveries but still require skilled daily care.

7:15PM - Arrive at Nurse's Station. (opportunity to greet nurses if desired).

7:18PM - Proceed through dining area to Nurse's Station in building #4

Mr. Thoms will explain that this building houses "intermediate patients." The people who can do more for themselves, ambulate safely, etc., consequently the least costly because of reduced requirements in medical and skilled care.

7:20PM Mr. Thoms will relate the importance of quality lounge areas

7:20PM MR. THOMS TO DIRECT PRESIDENT'S ATTENTION TO TV LOUNGE AREA

7:23PM - Proceed down southern wing of building #4 (possibility exists for Mr. Thoms to show the President a typical patient's room.

If so, Mr. Thoms will explain that patient's are encouraged to bring personal articles, furniture, TV's (excepting beds) for for their own comfort and convenience.

Option also exists to see a standard bathing area where Mr. Thoms would show that there had been no accidents in the 7 1/2 year history of Greenbriar since all patients are assisted by attendants or orderlys.

7:26PM - Arrive at porch area (southern end of building #4 meeting with Richard (Dick) Chaput.

7:28 - Departs porch and returns to front entrance to deliver statement.