

The original documents are located in Box 13, folder “2/7-8/76 - New Hampshire (2)” of the Betty Ford White House Papers, 1973-1977 at the Gerald R. Ford Presidential Library.

Copyright Notice

The copyright law of the United States (Title 17, United States Code) governs the making of photocopies or other reproductions of copyrighted material. Betty Ford donated to the United States of America her copyrights in all of her unpublished writings in National Archives collections. Works prepared by U.S. Government employees as part of their official duties are in the public domain. The copyrights to materials written by other individuals or organizations are presumed to remain with them. If you think any of the information displayed in the PDF is subject to a valid copyright claim, please contact the Gerald R. Ford Presidential Library.

THE WHITE HOUSE

WASHINGTON

VISIT TO NEW HAMPSHIRE

Saturday - Sunday - February 7 and 8, 1976

Departure: 9:55 A.M.

From: Terry O'Donnell

TOD



BACKGROUND

WASHINGTON DEPARTURE/MANCHESTER, NEW HAMPSHIRE, ARRIVAL

You, Mrs. Ford and Susan will depart the South Lawn at 9:55 a.m. via helicopter for Andrews Air Force Base and the 1 hour, 5-minute flight aboard Air Force One to Grenier Field, Manchester, New Hampshire.

Air Force One will arrive Grenier Field at 11:15 a.m. where you will be met by State Representative Richard Hanson (R), Mayor Charles Puksta (R) Claremont, N.H., Mr. Ralph Southwick, Rockingham County Commissioner, and Mr. Paul Ryan, Danbury Selectman. The arrival will be open to the public in order to afford the people of New Hampshire an opportunity to greet you. Although no remarks are planned, it is suggested that you greet the crowd and chat briefly with the local media prior to boarding the motorcade.

Following the greeting, *Mrs. Ford will proceed independently to Old Town Hall, Salen Center, New Hampshire to view a Senior Citizens' Program and Childrens' Recreation Program, then on to Nashua where she will visit the President Ford Committee Headquarters to observe a phone center operation. From there, she will go to the Thurber Residence to await your arrival later on in the afternoon. Mike and Gayle will also be there when you arrive.

Susan will go by motorcade to Mt. Cranmore, North Conway, New Hampshire (approximately 3 hours, 20 minutes' driving time) to present awards to winners of the Men's and Women's Slalom competition. She will overnight at Mt. Cranmore and join you and Mrs. Ford at Rundlett Junior High School in Concord, at 12:40 p. m. on Sunday.

BUDGET BRIEFING/RECEPTION, CONCORD, NEW HAMPSHIRE

The drive from Grenier Field To Rundlett Junior High School in Concord requires 35 minutes. Representative Cleveland and Former Governor Walter Peterson will accompany you.

You will make brief opening remarks and then be questioned by members of the audience for approximately 75 minutes. You will have a General Revenue Sharing chart, the Health Services "before" chart and the Education Programs "after" chart available to assist in your briefing. Following the briefing, you will spend twenty minutes informally greeting the guests at a reception. The audience of 250 will be composed of selectmen, mayors, members of the State House of Representatives and Senate, country commissioners and city councilmen.

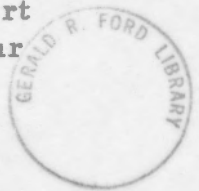

PFC DELEGATE RECEPTION

At 2:30 p. m. you proceed to Room 400, Rundlett Junior High School, where you will greet and mingle informally with 40 PFC Delegates for 30 minutes.

At the conclusion of the PFC Delegate Reception, you depart Rundlett Junior High School via motorcade for the 1-hour drive to the Thurber Residence in Nashua, New Hampshire, arriving there at 3:35 p. m. Dick Cheney will ride with you for staff work. The Thurber Residence is a typical New England house whose owner died in December and it has been vacant since then. Her son, Davis S. Thurber, lives about a block away. He and his wife, Mr. Fred Cox, and residents of the neighborhood will be on hand to greet you upon arrival.

GREATER NASHUA CHAMBER OF COMMERCE RECEPTION/DINNER

Attire: Business Suit

You and Mrs. Ford will depart the Thurber Residence at 6:05 p. m. for the 10-minute drive to the Nashua Senior High School to attend the 50th Annual Reception/Dinner of the Nashua Chamber of Commerce. Upon arrival, you proceed to a Reception Room and informally greet Head Table Guests and Dinner Committee Members (approximately 60) prior to being announced to the dinner which is expected to be attended by some 1200 persons, largely from the Nashua-Southern New Hampshire region including representatives of nearly 200 firms.

Former speakers include Presidential Candidate Richard Nixon, Governor Nelson Rockefeller, Senator Barry Goldwater, Governor John Volpe, and Paul Harvey. This event, which is "non-political" will be the first major civic event to take place in the new Nashua senior high school.

A highlight of this evening's program will be the presentation of a "Citizen of the Year Award". The recipient is chosen by an anonymous committee and his identify is considered one of the best kept secrets in New Hampshire.

Dinner Chairman, Frank Harvey, introduces you for your remarks.

You and Mrs. Ford are expected to arrive back at your residence at 9:35 p. m.



SEQUENCE - WASHINGTON DEPARTURE/MANCHESTER ARRIVAL

- 9:55 a.m. You, Mrs. Ford and Susan board helicopter on South Lawn and depart en route Andrews Air Force Base.
- 10:10 a.m. Arrive Andrews AFB and board Air Force One.
- 10:15 a.m. Air Force One departs Andrews AFB en route Grenier Field, Manchester, New Hampshire.

PRESIDENTIAL GUESTS

Mr. and Mrs. William Baroody
 Mr. Roy Hughes, Rogers Morton's Staff
 Mr. Stewart Spencer, PFC Deputy Chairman
 Mr. Peter Kaye, PFC Press Secretary
 Mr. James Lynn
 Mr. Jim Parcell, Washington Post Photographer
 (Flying Time: 1 hour, 5 minutes)



- 11:20 a.m. Arrive Grenier Field, Manchester, New Hampshire.

OPEN PRESS COVERAGE
 OPEN ARRIVAL

You, Mrs. Ford and Susan will be met by:
 Rep. James C. Cleveland (R-N.H.)
 Former Governor Walter Peterson (Unofficial Escort)
 Hon. Vesta Roy, PFC Co-Chairman
 Mr. Lou Georgopolus, Manchester Alderman (R)
 Mr. Peter Parady, Manchester Alderman (D)
 Mr. Lou D'Allesandro, Governor's Counsellor
 Mr. John Michaels, Campaign Manager of
 New Hampshire PFC
 Miss Vicki Zachos, GOP Nationalcommittee-
 woman
 Mr. Andre Verville, Manchester Alderman (D)
 You bid farewell to Mrs. Ford who will proceed
 independently to Nashua via Salem and to Susan
 who will proceed independently to North Conway,
 New Hampshire.

SATURDAY, FEBRUARY 7, 1976 - CONTINUED

NOTE: En route motorcade, you may wish to pause to talk with the local press.

You, Representative Cleveland, and Former Governor Walter Peterson proceed to motorcade. They will ride with you in your car.

BUDGET BRIEFING/RECEPTION - CONCORD, NEW HAMPSHIRE

11:35 a.m.

Motorcade departs Grenier Field en route Rundlett Junior High School, Concord, New Hampshire.

(Driving Time: 35 minutes)

12:10 p.m.

Arrive Rundlett Junior High School where you will be met by State Representative Richard Hanson (R), Mayor Charles Puksta, Claremont, Mr. Ralph Southwick, Rockingham County Commissioner, and Mr. Paul Ryan, Danbury Selectman.

PRESS POOL COVERAGE
CLOSED ARRIVAL

12:15 p.m.

Arrive holding room.

PERSONAL TIME: 10 minutes

12:25 p.m.

You depart holding room en route off-stage announcement area to await announcement.

12:30 p.m.

Announcement.

12:30 p.m.

You proceed to podium and open Budget Briefing for State of New Hampshire elected officials with a statement.

NOTE: Representative Hanson will have pre-briefed the audience.

FULL PRESS COVERAGE
ATTENDANCE: 250



SATURDAY, FEBRUARY 7, 1976 - CONTINUED

12:40 p.m.

Your remarks conclude.

Question and Answer Session begins, with questions alternating from stage right to stage left microphone.

FULL PRESS COVERAGE

1:40 p.m.

Question and Answer Session concluded by Rep. Hanson. You depart platform en route holding room, while guests proceed to Reception Room.

1:45 p.m.

You arrive holding room.

1:50 p.m.

You depart holding room and proceed to Reception Room.

1:53 p.m.

You arrive Reception Room and informally greet guests. .

PRESS POOL COVERAGE
ATTENDANCE: 250

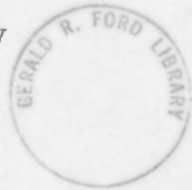

2:30 p.m.

You thank the guests and depart Reception Room en route Room 400 for Delegate Reception.

PFC DELEGATE RECEPTION

2:31 p.m.

Arrive PFC Delegate Reception.

OFFICIAL PHOTO COVERAGE
ATTENDANCE: 40

3:00 p.m.

You thank the Delegates and depart Room 400, escorted by Former Governor Walter Peterson, en route motorcade for boarding. Dick Cheney will ride with you for staff work.

SATURDAY, FEBRUARY 7, 1976 - CONTINUED

3:05 p.m.

Motorcade departs Rundlett Junior High School en route Thurber Residence, Nashua, New Hampshire.

(Driving Time: 1 hour)

4:05 p.m.

Motorcade arrives Thurber Residence, Nashua, New Hampshire.

PRESS POOL COVERAGE
OPEN ARRIVAL

You will be met by Mr. and Mrs. Davis Thurber and Mr. Fred Cox. Residents of the neighborhood will also be on hand to greet you.

Proceed inside Residence.

PERSONAL TIME: 2 hours.

NOTE: Mrs. Ford will have arrived Thurber Residence at 2:00 p.m. ; Mike and Gail will have arrived at 3:00 p.m.

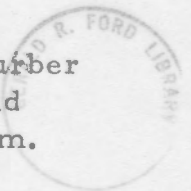

GREATER NASHUA CHAMBER OF COMMERCE RECEPTION/DINNERSATURDAY, FEBRUARY 7, 1976 - CONTINUED

6:05 p. m. You and Mrs. Ford depart Residence and proceed to motorcade for boarding.

PRESS POOL COVERAGE
CLOSED DEPARTURE

6:10 p. m. Motorcade departs Thurber Residence en route Nashua Senior High School.

6:20 p. m. Arrive Nashua Senior High School where you will be met by Mr. and Mrs. Ross A. Tait, President, Nashua Chamber of Commerce.

NOTE: There is No Smoking in the gym.
PRESS POOL COVERAGE
CLOSED ARRIVAL

Escorted by Mr. and Mrs. Tait, proceed to Head Table Reception.

6:25 p. m. Arrive Reception Room and informally greet Head Table Guests and Dinner Committee Members.

PRESS POOL COVERAGE
ATTENDANCE: 60

6:50 p. m. You and Mrs. Ford depart Reception Room and proceed to holding room.

6:53 p. m. Arrive holding room.

6:55 p. m. Members of the 1st New Hampshire Regiment Color Guard are positioned in front of dais.

7:00 p. m. Members of the Head Table are introduced onto the dais.



SATURDAY, FEBRUARY 7, 1976 - CONTINUED

- 7:05 p. m. You and Mrs. Ford depart holding room and proceed to off-stage announcement area, where you are met by Ross Tait, and pause for announcement.
- 7:07 p. m. Ruffles and Flourishes
Announcement
"Hail to the Chief"
- 7:07 p. m. You and Mrs. Ford, escorted by Ross Tait, proceed onto dais and remain standing. (Your seat: 2nd seat, stage right between Gene Kerrigan and Barbara Tamposi.)
OPEN PRESS COVERAGE
ATTENDANCE: 1,200
- 7:09 p. m. Introduction of the Pledge of Allegiance, by Frank Harvey, Dinner Chairman.
- 7:10 p. m. Pledge of Allegiance by the Nashua Boys Club Boy of the Year, Joseph Bissonnette.
- 7:11 p. m. National Anthem Medley, sung by Ann Harvey and Chester Lopez.
- 7:15 p. m. Invocation by The Reverend Robert D. Schenkel, Jr.
- 7:17 p. m. You and Mrs. Ford take your seats.
- 7:18 p. m. Dinner Service begins.
- 8:23 p. m. Dinner concludes.



SATURDAY, FEBRUARY 7, 1976 - CONTINUED

- 8:24 P.M. Welcoming remarks by Frank Harvey, concluding in the introduction of Mayor Dennis J. Sullivan.
- 8:29 p.m. Remarks by Mayor Sullivan.
- 8:33 p.m. Remarks by Rep. James C. Cleveland (R-N.H.)
- 8:37 p.m. A special presentation by Charles A. Glenday.
- 8:42 p.m. Presentation to Immediate Past President and remarks by Ross Tait.
- 8:52 p.m. Presentation of the Citizen of the Year by Joseph M. Kerrigan.
- 8:59 p.m. Introduction of you by Frank Harvey.
- 9:00 p.m. PRESIDENTIAL REMARKS.
FULL PRESS COVERAGE.
- 9:20 p.m. Your remarks conclude. You remain standing while Frank Harvey thanks you.
- NOTE: Mrs. Ford and Ross Tait proceed to podium.
- 9:22 p.m. You and Mrs. Ford, escorted by Ross Tait, depart dais and proceed through audience to motorcade for boarding.
- NOTE: Ross Tait will bid goodbye at the motorcade.



SATURDAY, FEBRUARY 7, 1976 - CONTINUED

9:30 p. m.

You and Mrs. Ford board motorcade and depart Nashua Senior High School en route Thurber Residence.

9:40 p. m.

Arrive Thurber Residence.

OVERNIGHT.



THE WHITE HOUSE
WASHINGTON

VISIT TO NEW HAMPSHIRE

Sunday - February 8, 1976

First Event: 10:15 A.M.

From: Terry O'Donnell

TOD

BACKGROUND

At 10:15 a.m., You and Mrs. Ford, and Mike and Gayle, will depart the Residence via motorcade for the 35-minute drive to the Bedford Presbyterian Church, Bedford, New Hampshire. Upon arrival, you will be met by Reverend Jim Scotland, Pastor, and escorted to your Pew (#34). The service will last 50 minutes.

At the conclusion of the Service, Mike and Gayle will return to Massachusetts, and you and Mrs. Ford will go to the Rundlett Junior High School (Driving Time: 30 minutes).

PFC VOLUNTEER MEETING

You and Mrs. Ford will arrive at Rundlett Junior High School at 12:30 p.m. where some 500 PFC campaign workers and their families will be gathered. After an hour of informally greeting the attendees, Mr. J. Sanders Haas, Executive Director of the White Mountains, 93 Association, will present you with a life-time Gold Ski Pass. After accepting the Ski Pass, you offer brief informal remarks, thanking the volunteers for their support and hard work and soliciting their efforts in the task ahead.

At the conclusion of this event, you and Mrs. Ford board the motorcade for the 45-minute drive to the President's Residence at Durham, New Hampshire, arriving there at 2:50 p.m. Personal Time: 1 hour, 5 minutes.



PRESS CONFERENCE - UNIVERSITY OF NEW HAMPSHIRE

You depart the Residence at 3:55 p.m. en route the Memorial Union Building for a Statewide Press Conference. Only fully accredited members of the New Hampshire media will be allowed to participate. Attendance: 120. Members of the National Press Corps will observe. The Press Conference will last an hour.

Following the Conference, you return to your Residence for 1 hour, 33 minutes Personal Time.

UNIVERSITY OF NEW HAMPSHIRE RECEPTION/ADDRESS

Accompanied by President and Mrs. Mills, you and Mrs. Ford depart your residence at 6:40 p.m. for the Lundholm Gymnasium. Upon arrival at the Gymnasium, you will proceed to a reception room for brief refreshments.

After opening remarks by David Farnham, President of the UNH Student Government, President Mills will introduce you for remarks. Some 3,000 persons, including students, faculty, alumni and guests will be present for your address. At the conclusion of your remarks, you will take questions from the audience for 40 minutes, then depart by motorcade for Pease AFB, Portsmouth, New Hampshire.

#####

Pease AFB is located 3 miles west of Portsmouth, New Hampshire and is a SAC base. Major operations: medium bomber and tanker, air rescue squadron; tactical airlift group, Air National Guard.

Pease AFB was activated in 1956. It was named for Captain Harl Pease, Jr. WW II B-17 pilot and Medal of Honor winner. A native of New Hampshire, his B-17 failed to return to the base after attacking enemy airfield on New Britain.

#####

The flight to Washington requires 1 hour, 15 minutes, with arrival at Andrews AFB at 9:45 p.m. The helicopter will arrive on the South Lawn at 10:00 p.m.



CHURCH SERVICES - BEDFORD PRESBYTERIAN CHURCHSEQUENCE

- 10:15 a.m. You, Mrs. Ford, Mike and Gayle Ford depart Residence en route motorcade for boarding.
- 10:20 a.m. Motorcade departs Thurber Residence en route The Bedford Presbyterian Church, Bedford, New Hampshire.

(Driving Time: 35 minutes)

- 10:55 a.m. Motorcade arrives The Bedford Presbyterian Church, Bedford, New Hampshire.

OPEN PRESS COVERAGE
OPEN ARRIVAL

You, Mrs. Ford, Mike and Gayle Ford will be met by Reverend Jim Scotland, Pastor, and escorted to Pew # 34.

- 10:58 a.m. You, Mrs. Ford, Mike and Gayle enter Pew # 34 and are seated.

PRESS POOL COVERAGE
(WRITING PRESS)

11:00 a.m. Service begins.

Organ Prelude.

Introit.

Call to Worship.

Invocation and The Lord's Prayer.

Stand for the Hymn, Responsive Reading, and the Gloria Patre.

NOTE: You and Mrs. Ford will stand.



SUNDAY, FEBRUARY 8, 1976 - CONTINUED

Children's Sermon

Scripture Lesson.

Pastoral Prayer.

The Offertory Service
 Announcements
 The Offertory
 Stand for Doxology and
 Dedicatory Prayer

NOTE: You and Mrs. Ford
 will stand.

Remain standing for Hymn.

Sermon.

Stand for Hymn, Benediction,
 Organ Postlude.

11:50 a.m.

Service concludes.

11:50 a.m.

You and Mrs. Ford, and Mike and Gayle, escorted
 by Rev. Scotland, depart Church en route motorcade
 for boarding.

11:55 a.m.

Motorcade departs The Bedford Presbyterian
 Church, Bedford, New Hampshire, en route
 Rundlett Junior High School, Concord, New
 Hampshire.

(Driving Time: 30 minutes)

NOTE: Mike and Gayle will not accompany you;
 they will return to Massachusetts.



PFC VOLUNTEER MEETINGSUNDAY, FEBRUARY 8, 1976 - CONTINUED

12:25 p. m. Motorcade arrives Rundlett Junior High School,
Concord, New Hampshire.

PRESS POOL COVERAGE
CLOSED ARRIVAL

You and Mrs. Ford will be met by Rep.
James C. Cleveland, PFC Chairman; Hon.
Vesta Roy, PFC Co-Chairman; John Michaels,
Campaign Manager; and Linda Kenniston, Event
Chairman.

12:30 p. m. You and Mrs. Ford, escorted by Rep. Cleveland,
proceed inside school en route PFC volunteer
reception.

12:35 p. m. You and Mrs. Ford arrive Reception Room and
informally greet campaign volunteers and their
families.

FULL PRESS COVERAGE
ATTENDANCE: 500

1:25 p. m. You and Mrs. Ford, escorted by Rep. Cleveland,
arrive stand-up microphone and remain standing.

1:26 p. m. Introduction of you by Rep. Cleveland.

1:28 p. m. YOU OFFER BRIEF INFORMAL REMARKS.

FULL PRESS COVERAGE.

1:35 p. m. Your remarks conclude.

1:36 p. m. Rep. Cleveland calls upon Mr. J. Sanders
Haas, Executive Director of the White
Mountains 93 Association, to present the
lifetime Gold Ski Pass to you.



SUNDAY, FEBRUARY 8, 1976 - CONTINUED

1:38 p. m. You and Mrs. Ford, escorted by Rep. Cleveland, depart reception en route motorcade for boarding.

1:45 p. m. Motorcade departs Rundlett Junior High School, Concord, New Hampshire en route University of New Hampshire President's Residence, Durham, New Hampshire.

(Driving Time: 1 hour)

2:45 p. m. Motorcade arrives Campus Residence of Eugene S. Mills, President of the University of New Hampshire, Durham, New Hampshire.

PRESS POOL COVERAGE
CLOSED ARRIVAL

You and Mrs. Ford will be met by President and Mrs. Mills, who escort you inside.

2:50 p. m. You and Mrs. Ford, escorted by President and Mrs. Mills, arrive inside Residence. After a brief conversation, President and Mrs. Mills take their leave.

PERSONAL TIME: 1 hour, 5 minutes



PRESS CONFERENCE - UNIVERSITY OF NEW HAMPSHIRESUNDAY, FEBRUARY 8, 1976 - CONTINUED

3:55 p. m. You depart Residence and proceed to motorcade for boarding.

Motorcade departs Residence en route Memorial Union Building for Statewide Press Conference.

3:57 p. m. Motorcade arrives Memorial Union Building.

PRESS POOL COVERAGE
CLOSED ARRIVAL

You proceed inside building en route off-stage announcement area.

4:00 p. m. You arrive announcement area and pause for announcement.

4:01 p. m. Announcement.

4:01 p. m. You enter and proceed to podium.

FULL PRESS COVERAGE
ATTENDANCE: 250

4:02 p. m. Statewide Press Conference begins.

NOTE: The first questions will be delivered from the stage right microphone. All subsequent questions will alternate between stage right and stage left microphones. Only full accredited members of the New Hampshire media will be allowed to participate. Members of the National Press Corps will observe.



SUNDAY, FEBRUARY 8, 1976 - CONTINUED

5:00 p. m.

Statewide Press Conference concludes. You depart podium and proceed to motorcade for boarding.

NOTE:

Prior to boarding motorcade, you will be presented with a UNH Football Jersey, a Fraternity Certificate, and a Fraternity Pin by Representatives of the Sigma Beta Fraternity.

PRESS POOL COVERAGE

5:05 p. m.

You board motorcade and depart Memorial Union Building en route Residence.

5:07 p. m.

Arrive Residence. Proceed inside.

PERSONAL TIME: 1 hour, 33 minutes



UNIVERSITY OF NEW HAMPSHIRE RECEPTION/ADDRESSSUNDAY, FEBRUARY 8, 1976 - CONTINUED

- 6:35 p. m. President and Mrs. Mills arrive Residence.
- 6:40 p. m. You and Mrs. Ford depart Residence en route motorcade for boarding, accompanied by President and Mrs. Mills.
- 6:43 p. m. Motorcade arrives Lundholm Gymnasium.

PRESS POOL COVERAGE
CLOSED ARRIVAL

- You and Mrs. Ford, escorted by President and Mrs. Mills, proceed to reception room for brief refreshments.
- 6:47 p. m. You and Mrs. Ford arrive reception room.

OFFICIAL PHOTO COVERAGE

- 6:57 p. m. You and Mrs. Ford, escorted by President and Mrs. Mills, depart reception room and proceed to off-stage announcement area.
- 6:59 p. m. You and Mrs. Ford, escorted by President and Mrs. Mills, arrive off-stage announcement area.

- 6:59 p. m. President and Mrs. Mills proceed to dais.
- 7:00 p. m. "Ruffles and Flourishes"
Announcement
"Hail to the Chief"
- 7:00 p. m. You and Mrs. Ford proceed onto dais and take your seats.

OPEN PRESS COVERAGE
ATTENDANCE: 3,500

SUNDAY, FEBRUARY 8, 1976 - CONTINUED

7:02 p. m. Opening remarks by David Farnham,
President of the UNH Student Government.

7:05 p. m. Remarks by President Mills, concluding
with the introduction of you.

7:10 p. m. PRESIDENTIAL REMARKS.

 FULL PRESS COVERAGE

7:20 p. m. Remarks conclude. You take questions from
the Student Body.

NOTE: The first question will come
 from stage right microphone and
 alternate thereafter.

 DURATION: 40 minutes

8:00 p. m. Thank you by David Farnham.

8:00 p. m. You and Mrs. Ford, escorted by President and
Mrs. Mills, depart dais and proceed to motorcade
for boarding.

 You and Mrs. Ford bid farewell to President and
Mrs. Mills and board motorcade.

8:05 p. m. Motorcade departs Lundholm Gymnasium
en route Pease AFB, Portsmouth, New Hampshire.

8:20 p. m. Arrive Pease AFB where you and Mrs. Ford
will be met by BG and Mrs. Jack L. Watkins,
Base Commander, and Col and Mrs. Fredric
Roth, Wing Commander.

OPEN PRESS COVERAGE
CLOSED DEPARTURE

SUNDAY, FEBRUARY 8, 1976 - CONTINUED

8:25 p.m.

You and Mrs. Ford board Air Force One and depart Pease AFB, Portsmouth, New Hampshire, en route Andrews AFB.

(Flying Time: 1 hour, 15 minutes)

9:40 p.m.

Arrive Andrews AFB. You and Mrs. Ford board helicopter and depart en route the South Grounds.

10:00 p.m.

Arrive South Grounds.

#####



New Hampshire Schedule

Saturday

9:50 Board helo & depart w/President (South Lawn)

(1 hr. 5 min. flight on Air Force 1)

11:15 Arrive Grenier Field, Manchester, New Hampshire

11:45 Mrs. Ford boards motorcade en route Salem Center, New Hampshire to Old Town Hall to view Senior Citizens' Program and Childrens' Recreation Program.

12:45 Depart Old Town Hall en route Nashua, New Hampshire (30 min. drive)

1:15 Arrive President Ford Committee Headquarters, Nashua, New Hampshire (Observe phone center operation)

1:45 Depart phone center en route Thurber Residence (15 min. drive)

2:00 p.m. Arrive Thurber residence.

STAFF TIME: 4 hrs. 15 Minutes

Business Suit

6:15 Depart w/President for Nashua Senior High School for ~~black-tie~~ dinner by Chamber of Commerce

10:05 Depart for Thurber Residence -- Arrive 10:15 p.m.



Sunday

9:20 Depart residence enroute Church, New Boston, New Hampshire
(11:50 Services conclude)

12:30 35 minute drive to National Guard Armory, Concord, N.H.
(Greet campaign workers & their families)
(Go to stand-up microphone w/President who accepts
Gold Ski Pass) FULL PRESS COVERAGE

1:45 Depart for 1 hr. drive en route University of New Hampshire
President's Residence, Durham, N.H. for 1 hr. 5 min. Personal Time
until 3:55

3:55 Depart residence en route University Auditorium for State Press
Conference (3 min)

5:00 Statewide Press Conference concludes

5:18 Arrive residence for 1 hr. 22 min. personal time

6:40 depart residence en route University Gymnasium for ~~speech~~ (Speech) Students
on (on dais) Short dress -
Grey Stripes?

8:00 Depart for Pease AFB

9:50 arrive South Lawn



New Hampshire Schedule

Saturday

9:50 Board helo & depart w/President (South Lawn)

(1 hr. 5 min. flight) on Air Force 1)

11:15 Arrive Grenier Field, Manchester, New Hampshire

11:45 Mrs. Ford boards motorcade en route Salem Center, New Hampshire to Old Town Hall to view Senior Citizens' Program and Childrens' Recreation Program.

12:45 Depart Old Town Hall en route Nashua, New Hampshire (30 min. drive)

1:15 Arrive President Ford Committee Headquarters, Nashua, New Hampshire (Observe phone center operation)

1:45 Depart phone center en route Thurber Residence (15 min. drive)

2:00 p.m. Arrive Thurber residence.

STAFF TIME: 4 hrs. 15 Minutes

6:15 Depart w/President for Nashua Senior High School for black tie dinner by Chamber of Commerce

10:05 Depart for Thurber Residence -- Arrive 10:15 p.m.



Sunday

9:20 Depart residence enroute Church, New Boston, New Hampshire
(11:50 Services conclude)

12:30 35 minute drive to National Guard Armory, Concord, N.H.
(Greet campaign workers & their families)
(Go to stand-up microphone w/President who accepts
Gold Ski Pass) FULL PRESS COVERAGE

1:45 Depart for 1 hr. drive en route University of New Hampshire
President's Residence, Durham, N.H. for 1 hr. 5 min. Personal Time
until 3:55

3:55 Depart residence en route University Auditorium for State Press
Conference (3 min)

5:00 Statewide Press Conference concludes

5:18 Arrive residence for 1 hr. 22 min. personal time

6:40 depart residence en route University Gymnasium for reception (on dais)

8:00 Depart for Pease AFB

9:50 arrive South Lawn



NASHUA ROOM LIST

| |
|-----------------------------|
| RES - Thurber Residence |
| B - Berkshire (889-1111) |
| S - Susse Chalet (889-4151) |
| HI - Holiday Inn (888-1551) |
| GH - Guest House (883-0167) |
| SH - Staff House (883-5665) |
| T - Thunderbird (888-1200) |

| | |
|-------------------|--------|
| PRESIDENT FORD | RES |
| MRS. FORD | RES |
| MIKE FORD | RES |
| GAYLE FORD | RES |
| BALL, J. | B-20 |
| BAUTISTA, A. | RES |
| BAROODY, B. (M/M) | SH |
| BISHOP, B. | S-65 |
| CARLSON, J. | HI-106 |
| CAVANEY, R. | SH |
| CHENEY, D. | GH |
| COATES, B. | T-42 |
| DELACRUZ, V. | RES |
| DOMINA, L. | GH |
| EASTLAND, L. | B-57 |
| FISHER, M. | B-55 |
| GERRARD, C. | HI-107 |
| HUGHES, R. | SH |
| KEISER, D. | B-64 |
| KENNERLY, D. | B-59 |
| KINLEY, D. | B-20 |
| LUKASH, DR. | GH |
| LUZANIA, E. | B-68 |
| MADDOX, C. | B-23 |
| MAHONEY, DR. | HI-150 |
| MCLAUGHLIN, T. | B-18 |
| NESSEN, R. | HI-105 |
| O'DONNELL, T. | SH |
| OLDENBERG & STENO | B-35 |
| ORBEN, R. | SH |
| POREMBKA, C. | RES |
| RILEY, COL. L. | B-14 |
| RIPPPIE, B. | SH |
| ROSENBERGER, E. | HI-216 |
| SANVICTORES, S. | RES |
| SERRANO, E. | B-31 |
| SMITH, J. | B-70 |
| SORUM, P. | B-53 |
| SPENCER, S. | SH |
| STERN, A. | B-57 |
| WEIDENFELD, S. | HI-146 |
| WELCH, W. | T-41 |
| WENDELL, D. | HI-216 |
| WILLIAMS, A. | T-43 |
| WOOTEN, K. | SH |
| WRIGHT, G. | HI-214 |
| ZOOK, R. | HI-214 |



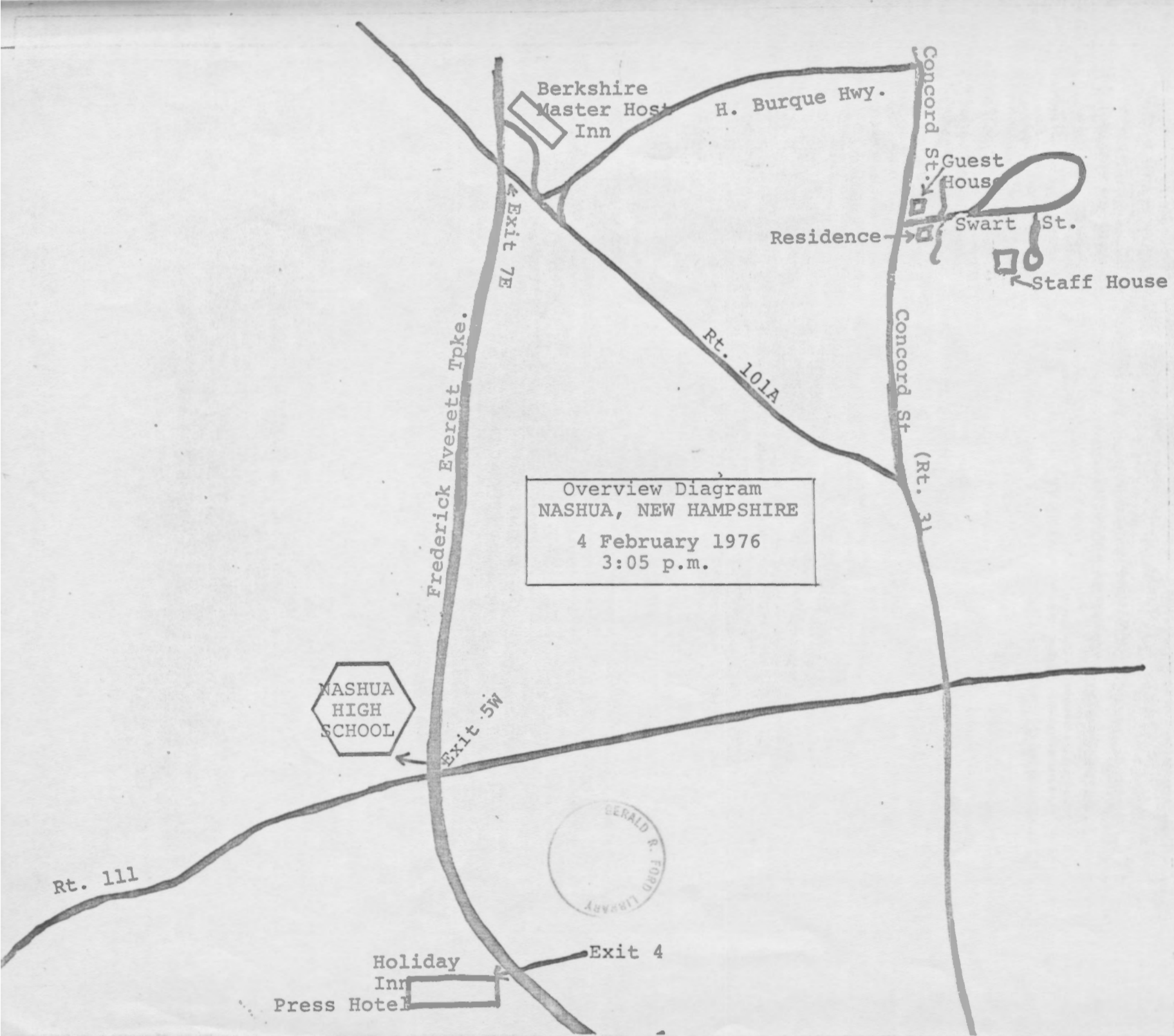

Overview Diagram
NASHUA, NEW HAMPSHIRE
4 February 1976
3:05 p.m.



david currier - '72 olympic

(10 mi so)
from Madison, NH

23-yrs-old

'74 world cup team

'76 olympic team

cracked a phylia
innsbruck

est?
xfor

3:30 arrival in north Conway at Mt Cranmore
- 4pm

4pm awards presentation - new Hamp State Ski
Racing Championship

4:30 new England Inn 19yrs + under

a couple hours to relax

(or local radio interv - 5:30-6)

6 awards + 1 to currie
outdoors by placque
hannes schneider
who developed area

7pm - currier take to dinner

is high dance - drop by - reception/dance
at

no. Conway community ctr -

rest of evening free



SUN

8:15 to Mt. Cranmore

8:30 herbert schneider take + show mtn
puts boots on +

to skimobile to 1/2way point on hill

ski down
currier with her - for photos - then

practice - then race course - then to

no. Conway train stat + meet people

... (on a ...) to ...

LANCASTER SCHOOL - SALEM, NEW HAMPSHIRE

Children with severe problems about 20
 Younger children ages 6-13 Special prog sponsored by Assoc. for Retarded Citizens

8-13 pp. Ages 16-28. They are young & supervised & trained on job. They are having shown skills to adapt to job.

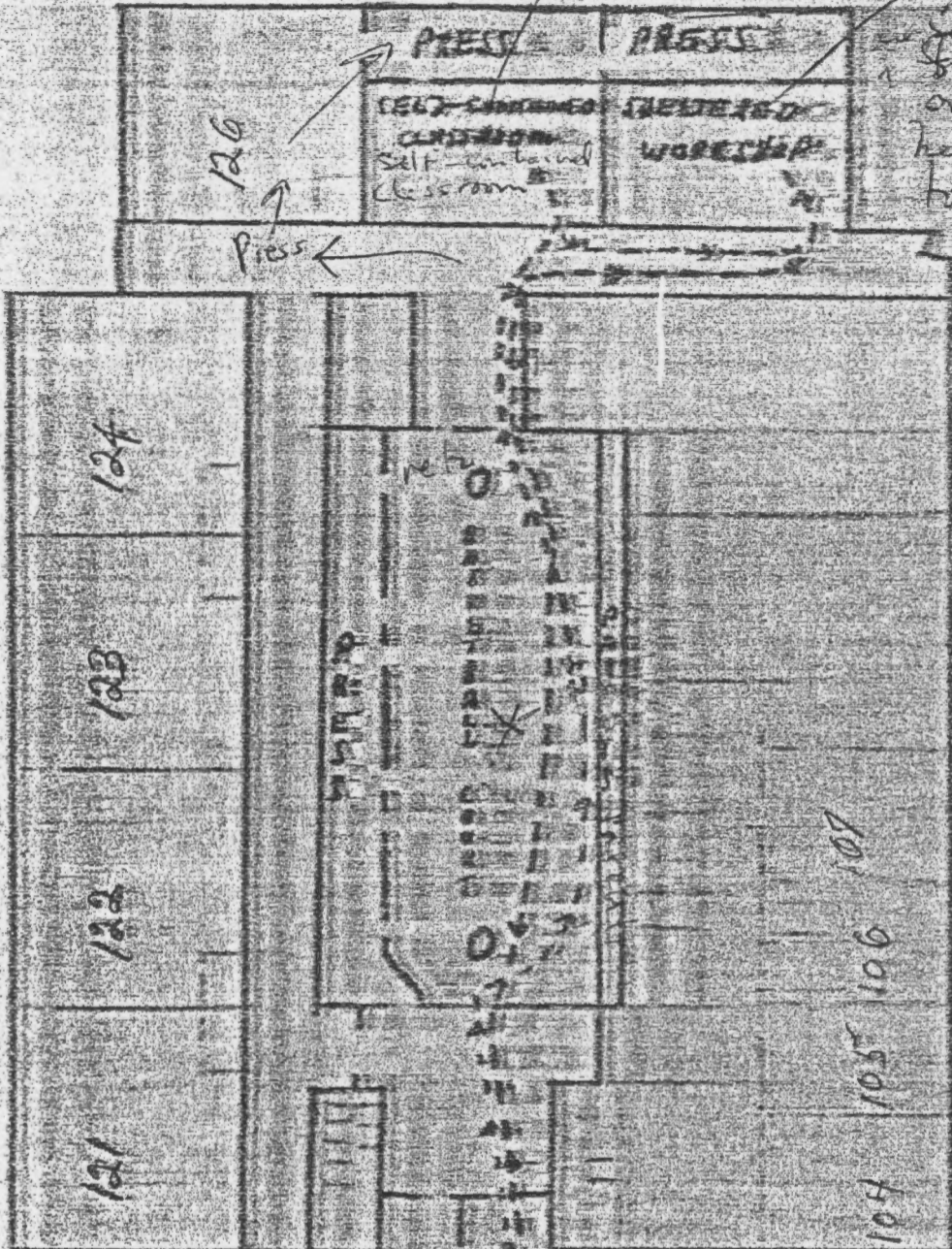

Need 70,000 \$/yr as away from goal - that is a big worry interest want to break ground & build building

Handed kids playing basketball

Mr. Ford will ride with Vesta Roy - state Co-chairmen for PFC
 Staff car - radio

Mr. Ford will be met by:

- Joan Sabatini - head of Salem Assoc. for Retarded Citizens
- John Walsh - Principle of Lancaster
- George Kowry - Chairman of the Fund Drive

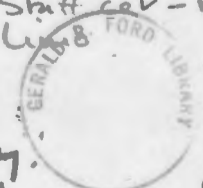

MRS. FORD'S VISIT TO THE NASHUA, NEW HAMPSHIRE PFC PHONE CENTER 2-7-76

PHOTO POSITION

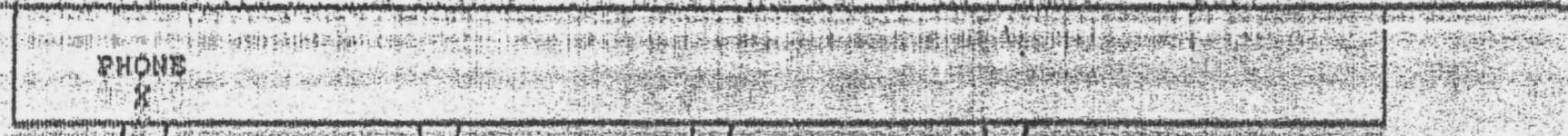

MRS. FORD

VOLUNTEER

VOLUNTEER

VOLUNTEER

VOLUNTEER

VOLUNTEER

VOLUNTEER

BRIEFING POSITION

MRS. MARY BARRETT
MRS. FORD

Chairman
head of
the phone
Bank in
Nashua

8' table

8' table to barrier

20 min on phone

PRESS

1 pool reporter - post in Nashua hotel

dd slide
up the stairs
to PF
headquarters.
About the
size 1/2 of
my office



computer
vent-out
from previous
cells made
indications
ended
computer

will make
2 sent 12
phone calls

move
press
one by
one - 2
by 2 to
photo position

THE WHITE HOUSE

WASHINGTON

February 5, 1976

MEMORANDUM FOR: C. POREMBKA
FROM: *RED CAVANE*
SUBJECT: THE PRESIDENT & MRS. FORD'S
VISIT TO NEW HAMPSHIRE
Saturday & Sunday, February 7-8, 1976

You are manifested on Air Force One and requested to report to the Distinguished Visitors Lounge at Andrews AFB no later than 9:15 am. Air Force One is scheduled to depart at 10:15 am on Saturday, February 7th and will return at approximately 9:40 pm on Sunday, February 8th.

WEATHER REPORT: Cold, temperature in low 20s with a 50% chance of blowing snow or rain.

ATTIRE: Business Suit. (Cold weather attire is necessary.)

BAGGAGE CALL: All baggage is to be left in an unlocked condition in the West Basement no later than 8:00 am or taken to Andrews AFB with you.

A Detailed Guest & Staff Schedule will be handed out on board Air Force One.

Car: 9:00 West Basement



FOR IMMEDIATE RELEASE
Wednesday, February 4, 1976

THE WHITE HOUSE
Office of the Press Secretary to Mrs. Ford

NEW HAMPSHIRE SCHEDULE

MRS. FORD

Saturday, Feb. 7

12:15 PM

Salem: She will be visiting Lancaster Public School where there is a workshop for handicapped children.

1:15 PM

Nashua to visit the President Ford Committee Phone bank.

Sunday, Feb. 8

SCHEDULE COINCIDES WITH PRESIDENT'S

Transportation for press will be provided for a maximum of twelve. Press will need regular Presidential Credentials. DEADLINE for credentials is noon today. Those who still need credentials call: Mr. Bellevance; 603-882-8106.

SUSAN FORD

Saturday, Feb. 7

4:00 PM

Mount Cranmore in North Conway. She will be presenting the awards in the New Hampshire State ski championships.

EVENING

Will attend local events.

Sunday, Feb. 8

8:30 AM

Possible practice runs on slopes.

10:00 AM

Susan will open the grand slalom.

EVENING

Press will be responsible for finding their own transportation.



Some items in this folder were not digitized because it contains copyrighted materials. Please contact the Gerald R. Ford Presidential Library for access to these materials.

N-12

Ford to Project Busy Image in N.H.

BY RUDY ABRAMSON
Times Staff Writer

WASHINGTON—President Ford plans to attend only one overtly political event when he makes his first political jaunt to New Hampshire this weekend, barely more than two weeks before the state's intensely watched presidential primary.

saying that his travels were "presidential."

In recent months, he has stayed more in Washington. White House officials Monday left open the possibility of scheduling a second Ford visit to New Hampshire if it is considered necessary.

The President's campaign has encountered difficulties in New Hampshire as well as Florida—two key primary

CP
N.H. file

This Copy For _____

NEWS CONFERENCE

#427

AT THE WHITE HOUSE

WITH RON NESSEN

AT 11:36 A.M. EST

FEBRUARY 2, 1976

MONDAY

MR. NESSEN: The President made a phone call today that you may be interested in, to President Giscard at 9:58. It lasted to 10:04. Today is Giscard's birthday, and it was a happy birthday phone call.

Q How old is Giscard?

MR. NESSEN: We will find out.

Q What did he have to say for six minutes?

MR. NESSEN: He wished him happy birthday.

Q Is that all?

MR. NESSEN: Mostly.

Q Was it in French or English?

MR. NESSEN: I think probably English. Giscard speaks pretty good English.

I think you know they established a friendship at Martinique and have continued it elsewhere, and they do, from time to time, talk on the telephone.

Q Was it a better connection this time?

MR. NESSEN: I think they got a pretty good line this time.

Q Was that talked about in the phone call?

MR. NESSEN: I don't believe so.

At 2:00 this afternoon, as you know, there is the swearing-in for Elliot Richardson as the Commerce Secretary in the East Room, and that is open coverage.

At 3:30 the President will meet with his advisers in the area of intelligence, and this is to continue finalizing the recommendations that he will be sending and announcing on revising the intelligence community.

MORE

#427



Q Will there be any pictures?

MR. NESSEN: No, I don't think so.

Q Who will be there?

MR. NESSEN: We will post a list of participants, but basically I think Scowcroft, Rumsfeld and others involved in the intelligence area.

Q When do you look for these recommendations to go out?

MR. NESSEN: I think we are very close, John, and I would say in the next couple of weeks.

Q How about the State of the World? How close on that?

MR. NESSEN: I don't have a date.

Q Any chance this week?

MR. NESSEN: No.

Q Will Kissinger be represented in that meeting?

MR. NESSEN: Yes.

Q Will he be there?

MR. NESSEN: I will have to look at the list of participants.

Q He is out of town.

MR. NESSEN: As I say, if he is not there, he will be represented at the meeting.

At 6:00 the President has asked the Republican Congressional leaders to come in and discuss what he believes is an extremely important piece of legislation to increase and assure the supply of natural gas.

If you want to have some pictures at the beginning of that, we could, and I think we will bring down Congressman Brown, who is the manager of the bill, and Frank Zarb, afterwards, if you would like to hear from them.

Q How long is the meeting?

MR. NESSEN: I don't have a time. I would say somewhere around an hour or possibly longer.

Q Will the GOP Senators be in on this?

MR. NESSEN: Yes, I think both sides.

Isn't that right, Margaret?

Q Will they be in to see us afterwards?

MR. NESSEN: Yes, we will bring some people down to talk to you afterwards.

You know about the President going over to see the display of gifts for the Bicentennial that have been sent by other countries.

I can give you a rough outline of the New Hampshire schedule, if you would like to hear that.

Q Was Mrs. Ford there this morning?

MR. NESSEN: She was supposed to be. She did not go, I guess.

On Saturday, I think the President will be leaving a little before 10:00 from the South Lawn, and he will fly in to the Manchester Airport and have a mid-day meeting there with State and local officials of both parties.

Q Of both parties?

MR. NESSEN: Yes, that is right.

Q Why?

Q Who is sponsoring this meeting?

MR. NESSEN: It is to discuss legislation, the budget and so forth as it affects the State.

Q They announced in New Hampshire that meeting would take place in Concord.

MR. NESSEN: He is motoring to Concord, I believe, from Manchester.

That will be, as I say, on the budget and other domestic issues, and I will check on the place.

Q What Democratic officials will be there, can you tell us?

MR. NESSEN: I don't have the participants list now.

Then there will be a short reception for those people who attend that. He then, in the evening, will go to Nashua for the speech to the Fiftieth Anniversary Meeting of the New Hampshire Chamber of Commerce and will stay overnight in Nashua. I am sorry, it is the Nashua Chamber of Commerce.

Q Is it New Hampshire or Nashua? You said both.

MR. NESSEN: It is the Nashua Chamber of Commerce and the meeting is in Concord. He will motor to Concord.

Q Is that a political speech?

MR. NESSEN: I haven't seen the text yet, Jim. The pro rated share of the trip is being paid for by the PFC, but clearly there are some nonpolitical events, such as the meeting with the bipartisan State officials.

Q You are saying those meetings are taking place in Concord now?

MR. NESSEN: Yes.

He will arrive in Manchester, drive to Concord and have the meeting.

Q Where will it be in Concord?

MR. NESSEN: I don't have the location. We will fill in the details later in the week. I just want to give you a rough outline.

Giscard is 50 years old today, incidentally.

Q Do you have an approximate arrival time in Manchester?

MR. NESSEN: This is a rough schedule. We arrive up there at Manchester about 11:10. These times may vary a little bit because this was an early version of the proposed schedule.

Then, as I say, he will motorcade to Concord, New Hampshire to the Rundlett Junior High School.

Q Where is this now?

MR. NESSEN: Motor to Concord, and the place in Concord will be the Rundlett Junior High School. It is a 35-minute drive.

Then the President will talk a little bit about his budget and other domestic matters and then will answer questions from the State and local officials of New Hampshire.

Then, as I say, there will be a short reception. That briefing, incidentally, begins at 12:30.

Q Open?

MR. NESSEN: Yes. About 350 people are expected to be there.

I don't have the names yet, Jim, but I will by the end of the week.

Then, as I said, there is a short reception right there at the school. Then the President will have some staff time in the afternoon and will drive over -- let me back up a minute.

After the event in Concord, the President will drive to Nashua -- and it takes about an hour to drive there -- where he will then have almost three hours of staff time and then will go to the Nashua Senior High School.

Q Ron, I am told before he goes to Nashua he plans to meet with his workers in Concord, where the Ford headquarters are. Is that right?

MR. NESSEN: It is not on the Saturday schedule, but let me come to Sunday and I think you will see what happens.

Q Is that his staff from Washington for three hours?

MR. NESSEN: Working with his staff and some personal time and Mrs. Ford will be with him, of course.

Q Then to what high school?

MR. NESSEN: Nashua Senior High School.

Q For the Chamber of Commerce thing?

MR. NESSEN: That is where the Chamber of Commerce is. The dinner, as I said, begins at -- well, on the early schedule it began at 7:00, but it may begin slightly later than that.

Q Where will he be headquartered in Nashua?

MR. NESSEN: He will be staying at a private house.

Q Do you have the subject of his speech?

MR. NESSEN: I don't at this point. He will begin speaking at around 9:00 or 9:10. After that, he will get back to his Residence about 10:00 and will spend the evening there.

On Sunday morning, it is possible he may go to church.

Q In Nashua?

MR. NESSEN: Let me hold back on the church for a day or so, Fran, until we nail that down.

Then he will drive back to Concord -- what was that?

Q I am accusing you of crucifying the President.

MR. NESSEN: How is that?

MORE

Q Nailing it down. (Laughter)

MR. NESSEN: He will be driving back to Concord at about mid-day Sunday, going back to the same junior high school where he was the day before. That is where his campaign workers and their families will be gathered. He will talk to them and say hello to them and shake hands with them.

Q How many?

MR. NESSEN: About 700, counting families.

Q Is that open?

MR. NESSEN: Yes.

Then we will drive to Durham, New Hampshire to the University of New Hampshire. It is about a 45-minute drive, getting there about 2:30 where he will have some staff time and personal time. He then will go to the University auditorium where he will have a news conference for local reporters beginning at about 4 o'clock. Full coverage of that, of course.

Then he will go back to the residence of the President of the University where he will have about another hour and 25 minutes of free time, and then he goes to the University gymnasium, getting there about 6:45, where he will speak at about 7:00 or 7:10. About 3,500 people will be there.

Q What is his topic?

MR. NESSEN: I don't have the text of that yet. It is a speech to the University students.

Q Is that political?

MR. NESSEN: I don't think so. I think he was invited to speak at the school.

Okay, then he is going to go and meet some student leaders for about a half hour, and then will drive to Pease Air Force Base in Portsmouth, New Hampshire, about a five-minute drive. He will leave there at about 8:30 and get back to Andrews at about 9:45 and back to the White House at about 10:05.

Q What is the departure time?

MR. NESSEN: Take-off is at about 8:30, arrive at Andrews about 9:45 and at the White House at about 10:05.

Q Will that meeting with the students be open?

MR. NESSEN: For pool coverage, yes.

Q Is he going to do any campaign work there?

MR. NESSEN: He is meeting with his campaign workers.

Q His meeting with students, will that be open?

MR. NESSEN: I just said it will be pool coverage.

Q There is a lot of driving. Will there be a lot of stopping on those drives?

MR. NESSEN: I don't know whether there will be or not.

Q You say Mrs. Ford is going along. Will she have a separate schedule?

MR. NESSEN: Mrs. Ford is going along, Susan and probably Jack. Susan and Jack will have a separate schedule and Mrs. Ford will have a couple of events of her own.

Q Who is the distinguished citizen in Portsmouth that will be favored with the President's --

MR. NESSEN: I need to check that. I don't have a name and description of who he is.

Q Will the evening event at the University be open to the public or is it just for students?

MR. NESSEN: It is 3,500 people and I don't know whether they invited the public or just the students. I will check it for you by the end of the week.

Q Apart from the meeting with the Ford workers, is there any other fairly political event on this thing?

MR. NESSEN: Not that I see.

Q But you are not ruling out that either the Chamber of Commerce speech or any other speech may have a political flavor to it?

MR. NESSEN: Like what?

Q The President may give reasons why he wants to keep his office and why he wants to be elected?

MR. NESSEN: I haven't seen either speech so I don't know what he will say.

MORE

#427

Q You are not ruling out he may give a political speech?

MR. NESSEN: I don't know what you mean by political speech and I haven't seen either speech so I don't know what he will say.

Q This is the campaign trip that we have been hearing about, isn't it?

MR. NESSEN: It is being paid for by the PFC.

Q You mentioned pro rata before.

MR. NESSEN: The people who are considered political people, their transportation and expenses will be paid by the PFC.

Q Does that include the President?

MR. NESSEN: His transportation, yes, and expenses.

Q Why are they being paid? Just because of this one meeting he is going to have?

MR. NESSEN: I think you recall the ruling of the FEC of a couple of months ago that after January 1 speeches to large groups and so forth need to be counted as campaign trips.

Okay, that gets us through that.

Q Speaking of the FEC, does the President have any reaction to the Supreme Court's action?

MR. NESSEN: We put out a fairly lengthy statement Friday night, Saul, and I was just going to say I don't have anything further to give you on that. He is awaiting a report from the Attorney General and from the Legal Counsel's Office and I believe he said after he got those he would get together with Members of Congress and find out what, if any, steps were needed. Of course, in the meanwhile he said that he would follow the letter and the spirit of the 1974 law. There has been no change since Friday.

Q So far as you know, in New Hampshire, this constitutes his only political activity prior to the February 24 primary; is that right?

MR. NESSEN: He has been asked whether he planned to or would come back and he said there are no plans to but, you know, it is always possible.

Q Ron, do you have a tentative date scheduled for a meeting with the leadership on that Federal Election Commission?

MR. NESSEN: No, because it depends on when Phil Buchen and the Attorney General give the President their recommendation and report.

Q When do you expect that?

MR. NESSEN: Some time this week.

Q Can we rule out skiing?

MR. NESSEN: For the President, yes.

Q How about you?

MR. NESSEN: You can rule that out. (Laughter)

Q Will Susan be skiing?

MR. NESSEN: My understanding is she may be, and Jack also.

Q Can you tell us where they will be skiing?

MR. NESSEN: You need to check with Sheila because I frankly don't know.

A couple of other things that may interest you, I guess there was a report from Brookings on the Marine Corps and whether it was properly preparing for its role -- anticipating your questions -- the Pentagon is always reviewing the preparedness of all the services and making any changes necessary to meet the contingencies and to fulfill its role and, in addition, the Commandant of the Marines is testifying this morning before the House Armed Services Committee on the role of the Marines.

There was also a Library of Congress study over the weekend that discussed the United States military forces in relation to the Soviet military forces. Some of the things they point out are the reasons why the President has attempted to reverse the trend in military spending.

As you know, the Defense Department budget has continually become smaller in relation to other parts of the budget over the last 20 years and in real dollar terms the Defense budget has been just about completely flat over the last 20 years and that is why the President has proposed turning this trend around and that is why he has opposed so strongly the reductions made by Congress over the last couple of years in the Defense Department's budget.

Q Who did you expect to ask you that question?

MR. NESSEN: I thought somebody would. (Laughter)

Q What was the second report?

MR. NESSEN: The Library of Congress.

Q When did this come out?

MR. NESSEN: Over the weekend.

Q Are you ready for other questions?

MR. NESSEN: Yes.

Q Has the President had the record checked to determine whether President Nixon did give North Vietnam an unqualified commitment for economic assistance from the United States?

MR. NESSEN: John, it just doesn't matter. We are not going to be able to talk about what private communications went back and forth, if any, on that issue. Regardless of whether this was a private communication, there was certainly a public -- as part of the Paris peace accords. Part of the Paris peace accords dealt with possible economic aid to North Vietnam after the war, and the President was part of the delegation that went to Paris to witness the signing so he was familiar with that particular section of the Paris accords and, in fact, there were discussions which opened on the matter in 1973 with the Joint Economic Commission that was established. They discussed the matter. They never did settle on any specific numbers as far as money went.

But the whole issue then became moot for several reasons: One, because there was no feeling in Congress that they wanted to give North Vietnam economic aid under the circumstances; and secondly, because North Vietnam violated two provisions of the accords -- one, by sending arms and men into the South and then violating the accords by starting the war up again; secondly, by failing to live up to the commitment they made to account for the Americans missing in action. So the whole question of economic aid became moot.

Q Ron, do you know whether Secretary Coleman will confer with or consult the President before he makes the Concord decision?

MR. NESSEN: I don't expect him to, Peter.

Q He has not so far?

MR. NESSEN: Not that I know of.

Q Ron, can you give us anything further on this Executive Order on exports of nuclear materials, why the President decided to issue it at this time?

MR. NESSEN: Do you know that, John?

We will check on that and find out.

Q Ron, can you tell us whether the United States did, as the British report, supply \$20 million of the CIA funds for the recruiting of mercenaries for Angola?

MR. NESSEN: The United States is not giving any money to Britain to recruit mercenaries for Angola.

Q Did it?

MR. NESSEN: No.

Q That doesn't seem to square with what the Secretary of Defense said on television yesterday.

MR. NESSEN: I did not hear him say anything on that subject, Peter.

Q He was asked about it and he didn't deny it. He evaded it. He certainly didn't flatly say no money was going; in fact, he inferred, if I heard him correctly, that there had been money sent in the past.

MR. NESSEN: To whom?

MORE

#427

Q To other countries?

MR. NESSEN: The question was, have we given \$20 million to Great Britain to recruit mercenaries, and I am saying the United States has not, and is not, giving any money to Great Britain to hire mercenaries.

Q To any other countries to hire mercenaries in Great Britain?

MR. NESSEN: We have said before -- and it is still absolutely true -- the United State is not, and no agency connected with the Government is recruiting, or hiring or training American mercenaries.

We have also said limited amounts of money are being given to some countries which share our goals in Angola. We are not actually able to determine how every last cent of it is spent.

Q Do you have anything specific on messages to Congress?

MR. NESSEN: No. We are looking for one later this week, hopefully.

Q Does that include South Africa, this gift of money?

MR. NESSEN: I don't think I will go into the details, Howard.

Q Presidential press conferences?

MR. NESSEN: Not at the moment.

Q This week?

Q Do you know what the message is going to be on later this week?

MR. NESSEN: I think probably the first message that will go up will deal with problems of the elderly.

Q Ron, I have a small point, maybe, but I was wondering on the question of private assurances to North Vietnam. I just wondered, since, as you say, it was discussed publicly in the various peace accords and the fact it is all moot, what would be the basis for withholding information like that? Certainly no security could be involved.

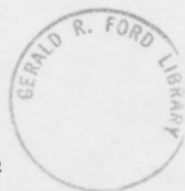

MR. NESSEN: If there was a letter or message to North Vietnam. Just a matter of policy, Bob, that if you open the door to disclosing private correspondence, or say there was no private correspondence, there is no place to stop, and you cannot conduct diplomacy by publishing all your correspondence.

Q When you say private communication, do you mean private as differentiated from public and therefore secret, or private as differentiated from official?

MR. NESSEN: I was only answering Bob's question or the other question.

Q You used the word "private" twice in your answer. What do you mean by private? Do you mean unofficial or unpublic?

MR. NESSEN: Unpublished.

Q Unpublic and therefore official. If there was a private communication, it was official, not an unofficial or personal promise, such as the issue arose in regard to South Korea at one time a couple of years ago regarding some letters from then President Nixon?

MR. NESSEN: I don't recall that one.

You know, I didn't raise the issue, but whatever people are talking about I think relates to a story that said that the former President indicated, as you say, in an unpublished message of some kind. I am not saying there was or wasn't.

Q Ron, does the President think we should give them aid?

MR. NESSEN: The President's last position on relations with Vietnam were stated in the East-West speech at Honolulu, which I think you know, or I can get it for you, if you don't. It was basically that we are looking to the future and not to the past in our relations but that our relations will depend on their actions.

On the specific question of aid, as I said, I think for the moment that is moot for the various reasons I mentioned.

Q What is the President's position on abortion?

MR. NESSEN: I am not able to give it to you today, Jim.

Q Will you be able to tomorrow?

MR. NESSEN: No.

Q How about Wednesday?

MR. NESSEN: Possibly.

Q Speaking of aid to North Vietnam, how much of our stuff did they take over when they took over South Vietnam?

MR. NESSEN: I don't have those figures, Howard. The Pentagon can give them to you.

Q I suppose for the record, as much as anything, to try to round it out, these stories, of course, come out of Congressional people that have gone to Hanoi recently, but for the record, has the United States received a request from North Vietnam, or Vietnam, I guess, you could say, a contemporary request, a recent request for any form of aid?

MR. NESSEN: I think Dr. Kissinger said at his news conference last week that we have had no communications officially with North Vietnam for some time, if I am not mistaken.

Q That refers from us to them, but what about my question?

MR. NESSEN: I am not familiar with any, but I think the State Department might be able to give you a more accurate answer.

Q In your response on abortion, is the President trying to decide what his position is or you haven't asked him?

MR. NESSEN: It is a complex matter, and he does want to word his position properly, and he is working on it.

Q I take it then he has some philosophical basis, but he just hasn't quite decided how he wants it explained, is that it, or is it that he has no philosophical basis?

MR. NESSEN: Yes, he has a view on abortion, which I would think fairly soon we will give you.

Q Does he agree with Mrs. Ford?

Q If he has an opinion, why doesn't he say what it is?

MR. NESSEN: Because it is a complex issue, and he wants to make sure his views are properly and fully explained, and it is taking him a bit of time to put down the proper words to explain his view.

Q So, in other words, what I said, that is a long way of saying what I said. He is considering how he wants to explain it. He knows what he believes, but he hasn't decided how he wants to phrase it yet?

MR. NESSEN: I think I will stick to my explanation of what the process is.

Q Is he going to issue a statement?

MR. NESSEN: The views will be known, I think.

Q Have you decided on the form for doing that?

MR. NESSEN: Why don't we wait until later in the week and see how it all turns out?

MORE

Q Hasn't he stated his view on abortion?

MR. NESSEN: Not since I have been here.

Q Yes, he has. You gave them to me.

MR. NESSEN: If I remember correctly, one of Jerry terHorst's first briefings involved the President's position on abortion.

Q I wrote the story and I will go up and get it and quote it.

MR. NESSEN: Wasn't it based on what Jerry terHorst said in one of his first briefings?

Q No, you told me.

MR. NESSEN: I don't recall it if I did.

Q Then there was another explanation when the Cardinal came down here from New York and the people in the Domestic Council talked about it.

MR. NESSEN: I don't recall it but you will have it soon, I think.

Q Is his position changed any from what it was when he expressed it a couple of years ago?

MR. NESSEN: I think we should all wait and see what it is, Ted.

Q Does he agree with Mrs. Ford on the subject of abortion?

MR. NESSEN: I think we will all wait and see.

Q Is he planning to ask for television time to explain this? Is it going to be a big policy position paper?

MR. NESSEN: He is not asking for television time and it will not be a big policy position paper.

Q Does he expect to be asked about it at his news conference he may have this week?

MR. NESSEN: Let's wait until later in the week. Don't you like surprises?

Q I understood you to say there will not be a news conference this week.

MR. NESSEN: None is planned at the moment.

Q Speaking of news conferences, what is the definition of "local reporters" that you are planning for this news press conference in New Hampshire?

MR. NESSEN: Probably New Hampshire reporters; reporters from New Hampshire.

Q Will that include reporters that cover New Hampshire such as the Boston Globe?

MR. NESSEN: I have not been putting the list together and I am not sure how wide a circle they will have at the news conference.

Q Ron, are any of the events in New Hampshire, particularly the news conference, going to be carried on kind of State television?

MR. NESSEN: I am not sure. I think perhaps so.

Q Perhaps the State educational TV network?

MR. NESSEN: I don't know.

Q Can you tell us the President's position on Metro funding, when he is going to announce what he is going to do about it?

MR. NESSEN: Is that an issue on which the President has to decide?

Q Yes.

MR. NESSEN: In what sense?

Q He is supposed to okay the amount of funding.

MR. NESSEN: I will look it up for you, Fran. I don't know myself.

THE PRESS: Thank you, Ron.

END (AT 12:07 P.M. EST)



Gerald R. Ford

Annual Dinner



February 7, 1976
Nashua Senior High School

50th Annual Dinner Committee

Frank L. Harvey, *Chairman*
Nashua Trust Company

Kenneth Spaulding
Spaulding Associates, Inc.

Maurice L. Arel
Sanders Associates, Inc.

Norman Chapdelaine
Indian Head National Bank

Frank Collins, Jr.
Collins Flowers, Inc.

Charles Glenday
Sanders Associates, Inc.

Robert McLaughlin
McLaughlin Real Estate

Gerald Q. Nash
Nash Real Estate

Samuel A. Tamposi
Realtor/Developer

Thomas Z. Winther
Nashua, N.H. Foundation

Lee Lewandowski
Wedgwood Real Estate

Roland Lapierre
Lapierre & Jenney



Chamber Officers 1975-1976

Ross A. Tait
President
Ingersoll-Rand, Impco
 Herbert A. Pembroke
V.P. - Community Involvement Group
Royal Business Forms, Inc.
 Philip M. Stone
V.P. - Chamber Growth Group
Indian Head National Bank
 Maurice L. Arel
Treasurer - Financial Officer
Sanders Associates, Inc.
 Fred B. Roedel, *Immediate Past President*
Chalet Susse International, Inc.

Samuel A. Tamposi
V.P. - Economic Growth Group
Realtor/Developer
 Gerald R. Prunier
V.P. - Public Affairs Group
Attorney
 Thain C. Allan
V.P. Souhegan Valley Division
Amherst Bank & Trust Co.
 J. Herman Pouliot
Clerk of Corporation
Telegraph Publishing Co.

Chamber Directors 1975-1976

Roger W. Cote
Nashua Federal Savings & Loan Assn.
 John B. Holland
Montgomery Ward & Co.
 Elsa F. Krueger
F.P. Trow News Agency, Inc.
 Norman R. Simoneau
J.W. Simoneau Sons Realty Corp.
 Robert Bloomfield
N.H. Vocational Technical College
 Robert L. Fancher, Jr.
Robwood Associates, Inc.
 Chester H. Lopez, Jr.
Hamblett, Kerrigan, LaTourette & Lopez
 Harry Rubin
Beneficial Finance Co. of Nashua
 Joseph P. Reynolds
Sanders Associates, Inc.
 Frank L. Harvey
Nashua Trust Company
 Philip D. Labombarde
International Paper Box Machine Co.
 Bernard Pastor
P.E. Fletcher Corporation
 Howard E. Walsh
First Federal Savings & Loan Assn.

Frank M. Derrickson
Gas Service, Inc.
 Angeline A. Kopka
Kopka Real Estate
 John H. McLaughlin
Mayflower Warehouse Assn.
 Carl L. Back
Horton & Hubbard Mfg. Co.
 John Cameron
Nashua Corporation
 Bankson C. Riter, Jr.
Bank of New Hampshire, NA
 George Winterson, Jr.
Hampshire Chemical Company
 Thomas Z. Winther
Nashua - N.H. Foundation
 Albert N. Dionne, Jr.
Cole Printing Co., Inc.
 Warren W. Kean
Granite State Leathers, Inc.
 Karl Norwood
The Norwood's Realtors
 Charles Stein
Dataroyal, Inc.
 Joseph C. Walier
MacMulkin Chevrolet, Inc.

ANNUAL DINNER PROGRAM

Saturday, February 7, 1976

The Evening's Program

Pledge of Allegiance Joseph Bissonnette
 American Medley and National Anthem Anne S. Harvey
 (arrangement by Ann S. Harvey) Attorney Chester H. Lopez, Jr.
 Invocation.....The Reverend Robert D. Schenkel, Jr.
 Toastmaster.....Frank L. Harvey
 Welcoming Remarks Mayor Dennis J. Sullivan
 Congressman James C. Cleveland
 Presentation of Special Recognition Charles A. Glenday
 Recognition of Chamber's
 Immediate Past President - Fred B. Roedel Ross A. Tait
 Remarks by the Chamber's President Ross A. Tait
 Citizen of the Year Award..... Attorney Joseph M. Kerrigan
 will make the presentation

Address by the President of the United States

Citizens of the Year

| | | | |
|------------------------|------|----------------------|------|
| Burt E. Warren | 1945 | James D. LeVan | 1962 |
| Walter Whipple | 1946 | Philip T. Lamoy | 1963 |
| William F. Sullivan | 1949 | Edward J. Lampron | 1964 |
| Eliot A. Carter | 1951 | Norman W. Crisp, Sr. | 1965 |
| Robert C. Erb | 1952 | Harry T. MacDuffie | 1966 |
| Mario J. Vagge | 1954 | John V. Chesson | 1967 |
| Royal Dion | 1955 | Robert B. Hamblett | 1968 |
| Sceva Speare | 1956 | Eliot A. Carter | 1969 |
| Francis P. Murphy | 1957 | Isabelle M. Hildreth | 1970 |
| Jacob C. Mandelson | 1958 | Lawrence C. Elliott | 1971 |
| Royden C. Sanders, Jr. | 1950 | George B. Law | 1972 |
| Max I. Silber | 1960 | Archie M. Slawsby | 1973 |
| Walter S. Nesmith | 1961 | Norris Cotton | 1974 |

**A Special Thanks
for help in making arrangements for this 50th Annual Dinner goes to:**

The Administration and Staff of the Nashua School District and
Nashua Senior High School

D.A. Designs

The First New Hampshire Regiment and
Nashua Revolutionary Bicentennial Commission

Pitarys True Value Home Center

Rowell & Miller, Inc.

Sanders Associates, Inc.

Vocational Carpentry Class - Nashua High School



Color Separations donated by: Gilbert Color Systems, Hudson, New Hampshire
Printing donated by: Cole Printing Company, Inc., Nashua, New Hampshire

TO REACH THE
NASHUA WHITE HOUSE
SWITCHBOARD

DIAL (603) 889-5941



Carolyn,

Welcome to Nashua

Mary⁵⁶ Larry

POREMBKA



- * Mr. Paul Agatella } Classroom visited
- * Mrs. Barbara Mooney } Instructor
- * Mr. Steve Miller } to Lancaster School
- * John Walsh, Principal

Lancaster School
 Millville St, Salem N.H. 03079

* Mrs. Donald McCreary
 33 Cove Rd, Salem

* Mrs. Albert Sabatini ✓
 6 Ruth St, Salem

- * Mrs. Pally Piment ✓
- Mr & Mrs James Webb
- Mr & Mrs Kendall Longe
- Mrs. Georgia Beaton
- Mrs. Wilfred Landry
- Mrs. Marjorie Bargek
- Mrs. Emma Lucas
- Mrs. Lillian Pennington
- Mrs. Hazel Lefebvre
- Mrs. Janet McPherson
- Mrs. Ann Hill
- Mrs. Vesta Curran
- Mrs. Irene Schofield
- Mr & Mrs Ed Novack
- Mrs. Dorothy Hanna



of
 Senior Citizen Center
 Old Town Hall
 Main St, Salem

* Mr & Mrs George Khoury flowers
 to 7 Longwood Rd, Salem

pink Carnations / yellow roses - large hot
pink ribbon

Red Roses, white Carnations

Purple orchids - Bicentennial
Print Ribbon

Senior City
Retarded Hsp.



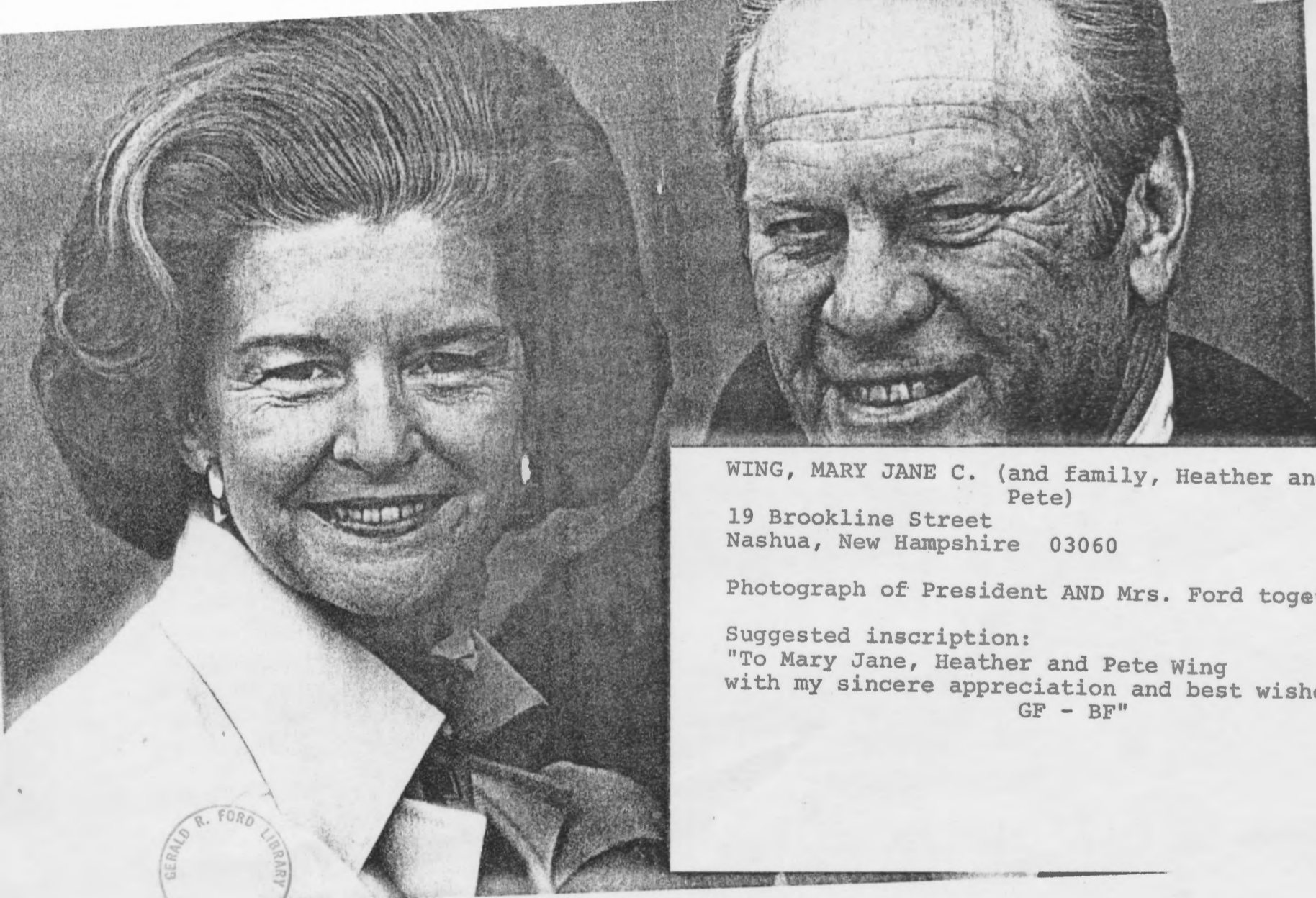

WING, MARY JANE C. (and family, Heather and
Pete)

19 Brookline Street
Nashua, New Hampshire 03060

Photograph of President AND Mrs. Ford together

Suggested inscription:

"To Mary Jane, Heather and Pete Wing
with my sincere appreciation and best wishes,
GF - BF"

*To Mary Jane, Heather and Pete Wing
With my sincere appreciation and
warmest best wishes,*

Betty Ford

winter vacation guide

Mt. Washington Valley



it's
all 
here



**New
Hampshire's
Complete
Winter**



winter vacation guide

Mt. Washington Valley



it's
all 
here



**New
Hampshire's
Complete
Winter**

Welcome...



To the exciting world of Mount Washington Valley, N.H. . . . A vacation here can take on any mood you wish.

By day . . . We are surrounded by massive mountains that offer unequaled breath-taking views and skiing that can exhilarate even the best . . .

By day's end . . . Nestled by those same massive mountains, the quaint villages of Conway, North Conway, Kearsarge, Intervale, Glen, Bartlett, Jackson and Gorham begin to bristle with excitement. Your choice of accommodations from formal "Presidential Suites" to informal bunks Numerous shops and stores that offer you a chance to bring some of the Mt. Washington Valley personality home with you. Meals from lavish "Gourmet" to romantic fireside snacks where one can talk about the day's fun.

By night . . . Entertainment abounds from the Valley Rock, Folk, Dixie, or even just a cracklin' fire. What's your favorite? Take your pick — or savor all. Whatever your mood, Mt. Washington Valley has it . . . and we want to share it with you.



SPECIAL SKI PASSES AND PACKAGES

Century Pass—5 mountains, 7 days, all season, ski pass. Limited to 100 people on a first come, first serve basis. Applications available at the Mt. Washington Valley Chamber of Commerce, Main Street, North Conway, N.H. 03860. Write, call, or stop in. 603-356-3900

The following packages are available only to guests of the Mt. Washington Valley lodging establishments listed in this winter guide. Either may be purchased at any one of the 5 mountains. Ask your lodging host for guest bonus introductory card.

5 DAYS 5 MOUNTAINS weekday package with interchangeable lift tickets. \$30. (Not valid Dec. 22-Jan. 4 or Feb. 16-20)

5 DAYS 5 MOUNTAINS 5 LIFTS 5 LESSONS weekday package, interchangeable, with an optional day of ski touring. Good Washington's birthday week. \$45. Juniors (13 & under) \$40. (Not valid Dec. 22 - Jan. 4.)



AIR SERVICE INTO MAJOR GATEWAYS

Boston, Massachusetts:

Logan Airport — Air Canada — Allegheny — Alitalia — Delta Irish — United — TWA — Pan American

Montreal, Canada:

Air Canada — Air France — BOAC — Delta — SAS — TAP

Portland, Maine: Delta — 207-744-7301

Manchester, N.H.: Delta — 603-622-1951, 603-623-7201

LOCAL AIRPORTS:

Eastern Slope Regional Airport:

Fryeburg, Maine — 206-935-9336. Open all year. 15 minutes from North Conway. 3000' lighted runway.

Berlin Airport:

Milan, N.H. — 603-449-2251. Open all year. 15 minutes from Gorham. Scheduled air service. 5000' lighted runway.

BUS TRANSPORTATION:

Daily service from Boston, Portland and Montreal on Trailways or Vermont Transit.

Vermont Transit — Burlington, Vt. 802-864-6811

Trailways: Boston — 617-482-6620

North Conway, N.H. — 603-356-2933

RENTAL CARS: Available at major airports.

Avis local office. Forbes Sunoco Station, No. Conway, 356-5516

Mt. Washington Valley Winter Guide is printed by the Mt. Washington Valley Chamber of Commerce, Box WB 385, North Conway, New Hampshire. All prices and descriptions appearing in the publication are published solely as a guide and are subject to change.



American Express honored at most establishments.



EASTERN MT. SPORTS CROSS COUNTRY SKI TOURING CENTER Intervale 356-5606
30 miles of maintained trails for all levels of ability, free to the public. Instruction, rentals, snack bar. Andy Haltof, Director.

GOOD EARTH SPORTS N. Conway 356-2850
Jct. of Rts. 16 & 302. Ski touring center: sales, rentals, instruction, trail network. We specialize in helping the beginning ski tourist.

JACKSON SKI TOURING CENTER Jackson 383-9355
Over 75 miles of ski touring trails for all abilities with trail maintenance and posted ski conditions. Variety of open touring as well as wooded mountain trails. Connecting Jackson Village with surrounding Inns and 3 Alpine areas. Rentals, Ski School. Jack Lufkin, Director.

ATTITASH Bartlett 374-2369
Free 1 1/2 mile trail from base. Rentals.

BLACK MT. Jackson 383-4490
Touring Trails on premises linked to Jackson Ski Touring Network. Rentals, Instruction.

CARROLL REED SKI SHOP N. Conway 356-5511
Free ski touring clinic and basic instruction 9 am to 12:30 pm. Groups are limited to 24. Complete ski touring rentals. Please call for information and reservations.

MT. CRANMORE N. Conway 356-5544
Free 3 mile touring trail at base; 5 mile round trip. Trail linking summit of Cranmore with Black Cap Mt. Rentals & Instruction.

DANA PLACE Jackson 383-6822
Trails connecting to Jackson Ski Touring — Ellis River Trail. Skiers lunches on weekends.

TYROL Jackson 383-4315
Touring trails on premises linked to Jackson Ski Touring Network. Rentals & Instruction.

WHITAKER WOODS N. Conway
Free 15 miles of trails for all abilities. Maintained by the Town of Conway. Just off Kearsarge St., near Mt. Cranmore.

WILDCAT MT. Pinkham Notch 466-3326
Linked to a network of touring trails surrounding the Appalachian Mt. Club, Pinkham Notch Camp, and to trails in the Jackson Ski Touring Foundation.

Ski Touring

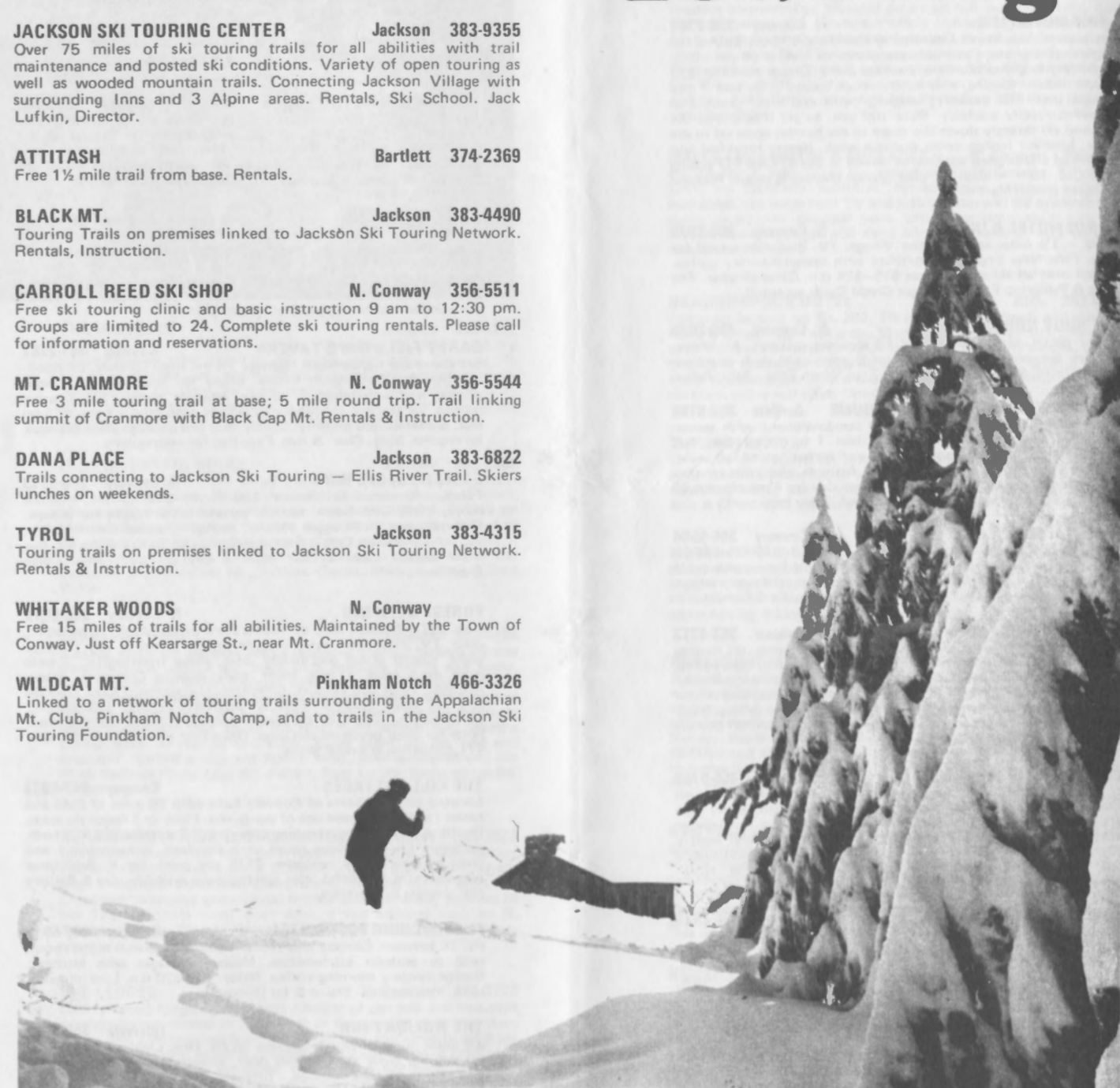

Lodging

ABBOTT'S SKI LODGE Jackson 383-4317
On Pinkham Notch Rd., Rt. 16 centrally located, 9 miles from Wildcat, 2 miles from Black and Tyrol, 9 miles from Cranmore. Low rates and offering the most for your money. Lodging and all you can eat breakfasts, \$6 pp and up. 5 day ski holidays \$55 pp and up. Your hosts, the Abbots.

ALPINE MOTOR INN N. Conway 356-2369
(Fun spot of the North Country) at the Mt. Cranmore Skimobile; complete skiers resort at moderate prices—as low as \$8 per night. Specializing in group rates and package plans. Group weekend, \$29 includes meals; lodging, plus much, much more. 3, 5, and 7 day packages from \$59 including lodging, meals and lifts, lessons and equipment readily available. Walk 100 yds. to ski lifts and at the day's end ski directly down the slope to the hottest apres ski in the Valley. Liveliest lounge seven nights a week. Hearty breakfast and economical charbroiled specialties served in the STEAK PIT dining room. Cap. 100+ — ideal for your group! Owners & Hosts: Richard DeAngelis & Neil Martin.

ARENDS MOTEL & INN N. Conway 356-2976
Rt. 16 — 1½ miles south of the Village. TV, Breakfast served for guests. Fine New England hospitality with complimentary coffee. Located near all ski areas. Prices \$15—\$24 d.o. Open all year. The Preece & Pellegrino Families. Major Credit Cards accepted.

BELL BUOY NORTH N. Conway 356-2624
A cozy motel with 7 units and 10 separate cottages. All winter activities are available nearby. Superb restaurant with excellent cuisine. Rates: \$10—\$16 d.o. Amer. Exp., Mast. Char., Bank Amer.

BLUEBERRY VILLAGE CONDOMINIUMS Bartlett 356-5156
Contemporary, beautifully decorated condominiums with panoramic views situated on Attitash Mountain. 1 to 3 bedrooms, full kitchen, fireplaced living room, wall to wall carpeting and full baths. Ski from your front door to the lift at Attitash, also cross country ski trails on premises. Rates from \$40 per day for 4 people plus \$6 for each additional person. Linens included. 3 day minimum.

BRIARCLIFF MOTEL N. Conway 356-5584
Rt. 16 & 302, ½ mile south of town. Large units with screened porch and panoramic view of mountains. Rooms have color cable TV, and Inn-Room coffee. Motel is centrally located near restaurants, lounges, and ski areas. Open all year. Hosts — Kurz Family.

CHRISTMAS FARM INN Jackson 383-4313
A complete family resort — minutes from 5 ski areas, ski touring connecting with 75 miles of trails, toboggans, skating, babysitting, all in a friendly colonial Inn with delightfully modern accommodations, fine food and drink. Rooms with bath, breakfast and dinner (box lunches available) from \$17 pp, children ½ price or less. 5 day downhill or touring packages. Rec. in AAA, Mobil Guides. Owners and Hosts — Eva & Jim Powers.

CLARENDON MOTEL N. Conway 356-9768
Rt. 16 & 302, 1½ mi. north of N. Conway Village. 17 well appointed units, TV, ind. heat control, shower-bath. Many fine restaurants nearby. Several family and efficiency units for daily or weekly rental. \$14—\$22 per day, d.o. Special 3 day and weekly rates upon request. 10 acres open touring on premises. Snowmobile trails nearby. Minutes from major ski areas. Box 138, North Conway, NH, 03860. Dan & Vanessa Noel.

CLOVER MOTEL N. Conway 356-2871
AAA approved. 14 units. Rts. 16 & 302. Minutes from 5 major ski areas. 9 channel color TV, guest controlled heat, private baths. \$16—\$21 d.o. 5 day ski holiday available. Restaurants opposite. Am. Exp., Bank Amer., Din. Club. Junior & Shirley Zepp — Hosts.

COVERED BRIDGE MOTEL Jackson 383-6630
Rt. 16 at Jackson Covered Bridge. Minutes to all 5 Alpine areas and on the Jackson Ski Touring Trail system. Morning coffee, ski locker, wax room, fireplace lobby. Rates: \$16—\$22 d.o. 5 day package with breakfast, Alpine \$74.50; Nordic \$54.50 pp d.o. Special 3 day weekend rate and the Valley Super Package. Credit cards and AAA rating. Brochure, Box 277. Hosts — Ann & Bob McManus.



CRANMORE INN N. Conway 356-5502
Charming old Inn in the Village. Excellent dining and accommodations. Recommended as "unusually good value" by Mobil Guide. Capacity 60. Daily rates \$12—\$20 MAP. Sunday to Friday package plans. Mast. Char., Bank Amer., Am. Exp. Hosts — Norm & Mary Jane Provost.

CRANMORE MT. LODGE & BARN Kearsarge 356-2044
A lovely old New England farmhouse in a picture book setting. Our recently converted barn features dormitory accommodations and a large fireplaced game room. Tobogganing and ice skating on premises. Ideal for church or school groups. Daily rates \$13—\$15 pp MAP. Learn to ski week-end \$36. Ski Holidays from \$100. All rates on the MAP. Cap. 80. Hosts: Stafford & Paula Young.

CRESTWOOD MOTOR LODGE N. Conway 356-5492
Rts. 16 & 302, 2 miles south of North Conway Village. Skating rink, ski touring, Dining room and Lounge. Cable TV for Boston sports. Snowmobile rental and facilities. Weekly rates and Package Plan. Daily rates: \$23 d.o. EP. Capacity 80. Owner operated. Write for folder, Box 555A, N. Conway, NH 03860. The Shuff family.

DANA PLACE INN Jackson 383-6822
Country elegance in elegant country. The White Mt. National Forest is our closest neighbor. Wildcat Mt. is just 3 miles away. Guest shuttle to the Mountain. Trailways Bus stop. Over 70 miles of touring trails to enjoy. Continental cuisine. Package plans available. Choose the comfort of our inn or enjoy the modern touch of one of our condominiums. Amer. Exp., Mast. Char.

DARBY FIELD INN & TAVERN Conway 447-2181
Set above the Kancamagus highway 1½ mi. from Conway, overlooking the Mt. Washington Valley. Enjoy the finest in continental dining, and entertainment in our intimate tavern. Ski Touring lessons, ice skating, snowshoeing. Rooms with private bath—\$11 pp incl. breakfast and gratuity. Group rates and package plans available on request. Mast. Char. & Am. Exp. Call for reservations.

EASTERN SLOPE INN N. Conway 356-5533
Famous American Ski Resort. 100 rooms. Skating rink, exercise room, mens' and ladies' saunas, private social rooms for groups. Entertainment in "Copper Hearth" lounge. Classical Gourmet Dining in "Le Grande Cafe". Free transportation to Cranmore Mt. Bus from Boston stops at our door. 5 day ski week plan. Color Brochure.

FOREST GLEN INN N. Conway 356-5346
New 1971—Modern Inn, all rooms have private bath, w/w carpet, color TV, reasonable rates include meals. Lower 5 day package plans, special group and family rates. Away from traffic, ½ mile from main road, 1 mile from town. Adjoins Cranmore, Black, Attitash, Tyrol and Wildcat. Complete ski equipment shop. Over 90 acres of cross country trails on property, skating, tobogganing, snowmobiling. Learn to ski special package plans at reduced rates. Write for color brochure and rates. Open Dec. 26 to mid March. Box 471. Catherine & Frank Silvey.

THE HILL COTTAGES Conway 447-5833
Located on the shores of Conway Lake with 25 acres of field and forest for the exclusive use of our guests. Close to 5 major ski areas. Facilities include housekeeping cottages, 3 & 4 bedrooms, full bath, complete kitchen, living room with fireplace. Snowmobilers and cross country skiers welcome. \$115 per week for 4. Additional persons extra. Weekend rates and brochure available. Jim & Barbara Hill, owners & operators.

THE HITCHING POST MOTEL Conway 447-5919
Rt. 16 between Conway and North Conway. Spacious motel rooms with or without kitchenettes. Modern cottages with kitchens. Complimentary morning coffee. Rates: \$14—\$20 d.o. Low midweek rates. Your hosts — Elaine & Ed Demarest.

THE HOLIDAY INN Intervale 356-9772
3½ miles north of North Conway on Rt. 16A. Lighted skating rink, ski touring trails start at our door, snowshoe trails on property. Excellent home-cooking, friendly hospitality. Daily rates, \$13—\$18.00 pp MAP. Weekly rates and package plans available. Mast. Char. Hosts — Winnie & Ed Houghton.

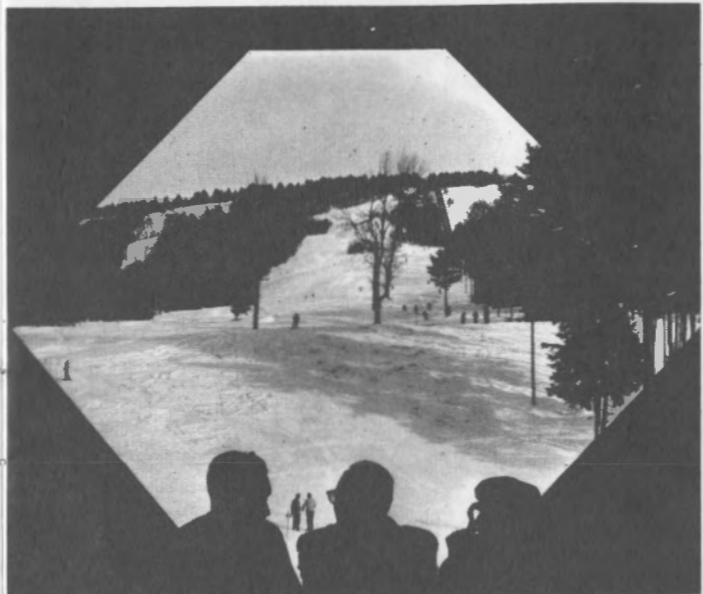

THE INN PLACE Jackson 383-4232
Enjoy the warmth of the fireplaces, the beautiful views, and the relaxed homey atmosphere in this small guest lodge. Capacity 10. Meals, if desired, are hearty, homecooked and served at your convenience. Children are most welcome and babysitting is available. Rates are very reasonable — \$6—\$13 for Adults; \$2—\$6 for Children. Brochure on request. Your Hosts — Joy & David Otis.

IRON MOUNTAIN HOUSE Jackson 383-6388
Rt. 16 centrally located to all major ski areas. Ski touring trails starting on premises. Recreation room with juke box, pool room, ping pong, knotty pine game room. Weekend \$22.50—\$29.50 pp includes 2 breakfasts and 1 supper. 5 day alpine pck. plan \$60—\$75 EP, meals available. 5 day cross country plan available. Special family and group rates. Cap. over 100. Seasonal Lodge Membership available. Ski rent shop on premises. Owner, Manager, Jack & Evie Butler.

JACKSON LODGE Jackson 383-4226
Elegant Victorian Mansion with a rare New England personality and hospitality. A unique ski lodge with spacious rooms and baths, luxury dorm and bunks, lounges, fireplaces... a friendly, immaculate and casual place where skiing is spoken fluently. Fine food and drink in Jackson Pub. All just 5 to 10 min. away from 5 major ski areas, Tuckerman, and across the road from Jackson Ski Touring Center with 70 mi. of x-c trails. Rates from \$9 pp, bed and breakfast. Special group and family rates, MAP weekends and Ski Week Package-Plans. Cap. 60. Folder. Neal Landy, Innkeeper & Ski Patrolman.

KEARSARGE WOODS CONDOMINIUMS N. Conway 356-3821
Luxurious Townhouse Mountain Resort, Furnished Contemporary two and three Bedroom units, 2 Sleeping Lofts, Complete Kitchens huge Fieldstone Fireplaced Livingrooms. Located across from Mt. Cranmore Skimobile and minutes from 4 other ski areas, 75 miles of Ski Touring Trails from your door, a few minutes walk to N. Conway Village. Weekly, Monthly, Seasonal Rates. Write for Brochure and Rate Schedule. Box R.

THE LEDGES N. Conway 356-3732
Weekly rental lodges. The Ledges consists of ten new and beautiful vacation lodges nestled in the woods at the base of Moat Mountain Range just five minutes from North Conway and close to all 5 ski areas. Each private lodge is comprised of 2 bedrooms, a fireplaced living-dining room, a complete kitchen and full bath. 6 family members can be comfortably accommodated. Color brochures available on request. Box 184.



LEDGEWOOD INN & MOTEL N. Conway 356-3666
Rt. 16 & 302, adjacent to the village of North Conway and Mt. Cranmore. 10 minutes from 5 major ski areas. Motel and Inn units all with private baths. Motel units have heat control and TV. Inn units furnished with antiques, fireplaced TV room and breakfast room. \$12—\$22 d.o. Continental breakfast included. 25 units.

LINDERHOF MOTOR INN Glen 383-4335
New England's most picturesque motor inn—warm Bavarian atmosphere throughout. Enjoy this bit of old world charm with all its modern conveniences. Situated on a high hill, away from city noise and confusion. The Linderhof offers outstanding mountain views from every comfortable accommodation. Enjoy a leisurely dinner, then join us in The Fireside Lounge for dancing or quiet relaxation. Only minutes away from 5 major ski areas. \$20—\$28 d.o. EP. 5 day Ski Holiday \$125 pp d.o. plus tip and tax. Children, \$90 plus tip and tax. MAP Group rates available. Write Box 126, Glen, NH. Free color brochure.

MAPLE LEAF MOTEL & COTTAGES N. Conway 356-5388
Rt. 16 South Main St. in the Village of North Conway. Efficiency Units are tastefully furnished. Housekeeping cottages with two bedrooms. All units have TV and kitchenettes and are available on a daily, weekly, or seasonal basis. Efficiency Units daily \$15 d.o. Housekeeping cottages \$25 daily Min. 4 persons. \$5 add. persons. Bob & Lois Wright.

MEADOWBROOK MOTEL Glen 383-4239
Centrally located on Rt. 302, 1½ miles from Attitash and minutes from 5 other major ski areas. Modern, carpeted, knotty pine units with TV and private bath. AAA approved. Some efficiencies. Coffee Shop and recreation room on premises. Daily rates: \$14—\$18 d.o. Fully equipped apartments available for ski season. Write for special ski plans and group rates. Dot and Charlie Loeschorn.

THE MINI MOTEL Intervale 356-5773
One mile off Rt. 16 on Dundee Notch Rd. New motel. Sun Deck with beautiful panoramic view. Quiet. Snowshoeing on property. Featuring "Mini Barn" dining room with fireside dining. \$15 d.o. Bob & Ellie Doyle, Owner-Hosts.

MOTEL ON THE RIVER Jackson 383-4241
All new housekeeping cottages with fireplaces and porches overlooking the Ellis River, just off Rt. 16. Away from the highway, quiet, minutes away from five major ski areas, near cross country skiing, snowshoeing, hiking. Write Box 266, Jackson, NH, 03846.

NERELEDGE INN N. Conway 356-2831
A small old fashioned mountain Inn — our capacity 25 — for serious winter sports people (downhill and cross country skiers, snowshoers, skaters, etc.) Located on River Rd. in North Conway Village — offering the finest "Home-cooking" and friendliest hospitality in the Valley. Warm comfortable guest rooms, fireplace, set up bar (BYOL) and candlelight dining. Daily Rates \$12—\$14 pp MAP. All inclusive 5 day Ski Holiday — write for particulars and folder. Box 432. Jan & Bob Greene — skiing innkeepers.

NEW ENGLAND INN Intervale 356-5541
Just minutes from all ski areas, 3½ miles from North Conway. Wide choice of accommodations from comfortable inn rooms to luxurious cottages with fireplaces. Ravine Room, cocktail lounge with live entertainment. Fireplaced dining rooms feature extraordinary meals by candlelight. Mid-week ski packages available. Moderate rates. Jim Brown, Manager.

NORTH COLONY MOTEL Bartlett 374-6679
10 units in the Scenic Mt. Washington Valley, one mile to Attitash Ski Area and minutes to other nearby ski areas. Each unit features 2 double beds, bath, tub/shower, TV, auto. heat. Good restaurants and entertainment nearby. Indoor swimming, sauna and tennis available. 5 day ski week Sunday thru Thursday \$70 d.o. Holiday weeks excluded. Reasonable daily and week-end rates. Mast. Char., Bank Amer., & Cart. Blan. Mobil Guide Approved. Hosts — Helen and Ralph Hoffman.

OLD FIELD HOUSE MOTOR LODGE Intervale 356-5478
New luxury lodge, away from traffic on Rt. 16A, 3 miles north of North Conway. Centrally located to all ski areas. Charming early American atmosphere with modern conveniences. TV, guest-controlled heat and music, private baths, some oversized beds, game room. Daily rates \$22-\$30 double occupancy. Continental breakfast included.

OLD RED INN & COTTAGES N. Conway 356-2642
Main St. Modern overnight and housekeeping cottages. Rooms \$10 and up. Close to restaurants, night life, and Village shops. Skiers welcome. Roger & Mary Marquis.

OXEN YOKE INN AND MOTEL LODGE N. Conway 356-2931
On quiet Kearsarge St. — within walking distance to North Conway Village and Mt. Cranmore Skimobile. Wide choice of accommodations, from comfortable Inn rooms to moderate motel units with individual heat control, TV. Live Entertainment, dancing, Slalom Lounge. Modest gourmet menu, in a colonial dining room, decorated in early American antiques. The OX Box is full of hand crafts. Ski packages and week rates — EP \$15-\$20 d.o. Public dining room with breakfast and dinner, lunch— brown bag gourmet. Priscilla & Ernest Kenyon — Hosts.

PUSS 'N BOOTS Conway 447-8905
5 miles east of Conway on Rts. 302 & 113. AAA approved. Coffee Shop. Close to all ski areas, restaurants, and apres ski attractions. 2½ miles of snowmobiling and cross country ski trails on the grounds. Daily rates \$14-\$22. 5 day Ski Holidays available. Norman & Rena Schwartz.

RED JACKET MOUNTAIN VIEW MOTOR INN N. CONWAY 356-5411
Rt. 16. Opened June 1971. 125 rooms plus 12 two-bedroom efficiency suites. Heated indoor pool, w/w carpeting, twin double beds, color TV, direct dial phone, heat, air cond., full baths, large dining room, cocktail lounge with entertainment, function rooms, sauna baths, game room, gift shop. \$28-\$34 d.o. Call or write for free brochure.

THE SCOTTISH LION N. Conway 356-2482
A country inn in the Scottish tradition. Bed and breakfast, \$8.50 pp d.o. Excellent public dining room. Black Watch Pub. Thistle Gift Shop featuring Scottish imports. Recommended by AAA, Mobil Guide, Guide to New England Inns, Gourmet Magazine, and Exxon. Am. Expr., Mast. Char., Bank Amer.

SWANWEIR MOTOR COURT Conway 447-2471
Off Rt. 16, West Main St., Conway. Modern efficiency units and housekeeping cottages, w/w carpeting, TV, electric heat, efficiency kitchens, convenient to all ski areas. Daily rates from \$14 d.o. Weekly, monthly and seasonal rates available on request. Open all year, Joe & Mildred Heim.

SYLVAN PINES MOTEL N. Conway 356-2878
Rts. 16 & 302. Large picture window units for panoramic view. Complimentary morning coffee. Daily rates \$16-\$22. 5 day Ski Holiday package plan \$35 pp d.o., Sunday thru Friday. The Gagnon Family.

THORN HILL LODGE Jackson 383-4242
A beautiful mountain Inn just minutes from 5 major ski areas. At the center of ski touring in Jackson with 3 trails leading from our front door. Tobogganing, ping pong and baby sitting on premises make a perfect family resort. Accommodations vary from Chalet dorms to large well appointed rooms to a private cottage. Ideal for church and school groups. Rates from \$14-\$21 pp including 2 hearty meals. 3 and 5 day Package Plans available for downhill and ski touring. Hosts — The Jacques Gagnon Family

WHITNEY'S IN JACKSON Jackson 383-4291
As part of the only ski resort complex in the Valley, this historic Inn offers the lifts and trails of Black Mt. at its door. Excellent accommodations range from small rooms to cottages with fireplaces to housekeeping suites, all available with or without 3 delicious meals. Package plans from \$90 pp. Extensive network of touring trails nearby, also available in package plans. Send for free folder. Bob Sullo, host.

page 6



WILDCAT INN & TAVERN Jackson 383-4245
Ski touring and mountaineering center of the Valley. Instruction and guides for ice climbing and cross country skiing available. Maintained touring trails start from our back door. Only minutes to 6 downhill ski areas. Comfortable rooms — good meals — cheerful Taproom with open fires and entertainment. 40 guests. Rates on request. Special 3 and 5 day plans. Bradford L. Boynton, Proprietor.

WINTER HILL LODGE Kearsarge 356-9758
Kearsarge Rd. Specializing in groups and church organizations. 2 day package plan includes rooms, meals, and snacks. Recreation room with fireplace, after ski punch, and home cooked meals. Located one mile from Cranmore, 2 day package plan \$25 pp MAP. 5 day ski package, \$85, ski equipment available. Al & Barbara Barnes.

WINWOOD LODGE N. Conway 356-9796 — 356-5617
One mile from Mt. Cranmore. Game Room, Fireplace & TV in Lounge, juke box, good food. Private practice slope with ski tow, night tobogganing, novice lesson & apres ski punch included in special weekend package — \$25 pp and up — MAP. Lower rates for non-vacation week days. Popular with Church or School groups & families. Accommodate up to 130. Ski equip. avail. We'll gladly send our brochure. Box 305. Jack & Janet Flagg.

Restaurants

ANN FROST, ETC. N. Conway 356-5295
Kearsarge St. Open 7 days, 7 am to 2:30 pm, and 5 pm to 8:30 pm. Tempting breakfasts served dawn to dusk, lunch and dinner also. Offering the best in food, service, and atmosphere. Try THE GABLES for dinner; same street, phone and management as ANN FROST.

BARNABY'S STEAK HOUSE N. Conway 356-5781
Properly aged prime western beef, char-broiled to suit the most fastidious epicure. House specialties include Chateau Briand, Steak Eugene, Baked Stuffed Shrimp, fresh baked bread and our exquisite salad bar. Top notch entertainment nightly in the lounge. Dining 5-9; Sat. 5-10. On the strip in North Conway.

BELL BUOY NORTH N. Conway 356-2624
Located on Rt. 16, this rustically renovated 1789 Barn offers you a wide variety of gourmet-style food. 32 entrees in all, with an extensive wine list. Entertainment 5 nights a week in the lounge as well as a special sandwich menu.

BERNERHOF Glen 383-4414
Rt. 302. Continental cuisine, unique cocktail lounge. Featuring Cordon Bleu, Wiener Schnitzel, Delice de Gruyere, Fondue Bourguignonne. Recommended by Gourmet, Three Star Mobil Guide. Dining room open 6:30 pm — 9 pm daily except Wednesday.

BROTHER'S II N. Conway 356-2972
A cozy, comfortable steak house with good food, good drinks, and good company. Specialized menu — moderately priced. Prime steaks, chicken, and ka-bobs to your order on our open charcoal hearth, plus delicious baked stuffed shrimp. Weekend special — prime ribs of beef. Salad and bread bar. The BROTHER'S II lounge offers entertainment and dancing nightly. On Rts. 16 & 302 just south of North Conway Village.

CAFE MEWS N. Conway 356-2313
Italian Cuisine. One of the most attractive restaurants in North Conway, the Cafe Mews sports a broad luncheon menu with specials as Cannelloni, and a sumptuous evening menu of gourmet Italian dishes like Fettucini Alla Romano, Escaloupe de Veau au Marsala, Spaghetti Alla Bolognese, Agnonotti and Ziti Alla Siciliana. Complimenting the dishes are unusual appetizers and desserts. Noontime partaking, amid nautical antiques, flags, and model ships. Drinks and wines with your meal or in Queeg's Saloon, a comfortable bar. Open noon to 1 am. Mast. Char., Am. Exp.

HEARTHSTONE DINING ROOM N. Conway 356-5495
After a busy day of tourism, dinner should provide the kind of relaxation offered by the Hearthstone. A menu virtually packed with delicacies, served with a flair by an attentive waiter. After dinner enjoy a tid-bit from our dessert cart or possibly a dessert flamed at tableside. Soft music, great imbibing, and delicious fare. Morning, Noon or Night help to make the Hearthstone Restaurant a tradition. Located at the Crestwood Motor Lodge in North Conway.

HOWARD JOHNSON'S REST. & TAVERN IN THE TOWN LOUNGE N. Conway 356-2741
Entertainment nightly in the lounge, rustic atmosphere. Special gourmet menu in addition to our popular Howard Johnson's menu. Seating cap. 250. Jct. Rts. 16 & 302 entering North Conway. Breakfast served daily at 7 am.

LITTLE GYPSY STEAK ROOM Gorham 466-9484
Rts. 2 & 16, Main St. Steaks, Shishkebob, Shrimp, Lobster, Duck, and Mountain Trout. Fine cocktails, pleasant & unique atmosphere, dancing & entertainment on weekends. Open daily & year round, 7 am — 9:30 pm. Lounge open till 1 am. Rec. by Mobil Guide, and Am. Exp. Hosts — Ron & Elaine Coury.

THE LOBSTER TRAP N. Conway 356-5578
Specializing in live Maine lobsters, "Come In & See 'EM Swim." Seafood at its best from ship to shore. For the landlubber steak, chicken. Lobsters & clams to go, live or cooked. Seldom equalled, never excelled. Open daily Noon til 9:30 pm. Located 1½ miles on West Side Rd., off Rts. 16 & 302. Your hosts: Captain Henry and Mate Harriette Thompson.



MARCELLO'S PIZZERIA N. CONWAY 356-5966
Offering authentic Neapolitan and Sicilian pizza in the Italian Tradition, Marcello's is a must for pizza lovers. Using fresh homemade pizza dough, fine herbs and tomato sauce and mozzarella cheese. A wide selection is available. Located behind the Cafe Mews, you can eat in the dining room, or to go, and enjoy a beer with your order. By the pie or the slice. Open 4 pm — 12 pm. Mast. Char.

MARIO'S OF NEW HAMPSHIRE N. Conway 356-9712
Rts. 16 & 302. Strictly self-service, family style dining, featuring New England's finest Italian pizza, spaghetti, baked lasagna and a wide variety of Italian sandwiches to fit any family budget. Sunday thru Thursday, 9 am — 10 pm. Friday and Saturday 9 am to 12 pm. Eat in or take out. Now serving Maine and New Hampshire.

MCCORMACK'S RESTAURANT & LOUNGE N. Conway 356-5737
Conveniently located on Rt. 16 in North Conway. A wide variety of foods served in the traditional New England manner. Also featuring our famous mariner's platter. Our Heather Lounge welcomes all. Serving Lunch and Dinner 7 days a week. Hosts — Sylvia & Roy McCormack.

MERLINO'S STEAK HOUSE N. Conway 356-9705
Rts. 16 & 302, South Main St. Open for dinner daily. "Serving the finest home-cooked Italian and American meals in the North Country, priced to please gourmet or family budgets." Cleanliness, friendliness, quality, quantity. Restaurant Liquor License. Dick & Audrey Luciano.

THE NEW BIG PICKLE N. Conway 356-3954
On Seavey St. Warm and Courteous service featuring New York kosher style delicatessen, party platters for home and social entertaining, ice cream favorites, and box lunches for out door convenience. Hearty eating at affordable prices. Monday thru Saturday, 6 am to 4 pm.

RED PARKA PUB Glen 383-6387
Just a few yards from the intersection of Rts. 16 & 302. Minutes from Attitash, Wildcat, Black and Tyrol ski areas. Enjoy apres ski and live entertainment in the Pub Lounge, and dine on delicious steaks, BBQ Ribs, Chicken or Shrimp steamed in beer, all combined with our super salad bar, in a relaxed casual atmosphere. Hosts — Al & Lois, and Jean & Dewey.

THE SCOTTISH LION N. Conway 356-2482
Superb American cuisine with Scottish touches. Drinks & dinner by the fire in this charming old inn will be one of the high points of your visit to North Conway. Also the Thistle Gift Shop featuring Scottish imports. One mile north of town on the Main St. Your hosts: Jack & Judy Hurley.

THE 1790 HOMESTEAD N. Conway 356-5900
Rts. 16 & 302. Dine in a home built in 1792. The charm of beamed-ceilings, wide board floors, and open fireplaces. Watch our chef prepare your steak, chops or seafood on the open hearth. Cocktails in the lounge followed by a sizzling steak make for a memorable evening in the North Country. Open daily for dinner.

SNUG HARBOR INN N. Conway 356-3000
Not just any port in a storm! A unique old inn, bringing a salty breath of the famous New England seacoast to the North Country. Come aboard and enjoy our many fresh seafood, hearty beef dishes and exciting nautical decor. Relax in "Bluebeard's Tavern." Just a few fathoms north of North Conway Village on Rt. 16. AAA approved. Closed Wednesdays. Am. Exp. & Mast. Char. Warren Matiello, your Captain.



Attitash

Location - 1 1/2 miles east of Bartlett on Route 302; North Conway, 8 miles
Elevation - 2300'
Vertical drop - 1525', North exposure
Lifts - 4 double chairlifts - 5200', 3600', 2800', and 1250'
Trails - Up to 2 miles long, 4 novice, 10 intermediate, 6 expert, 5 slopes
New double-double chair lift.
Only one of its kind in N.H.

RATES:
Limited line, reserved ticket policy on weekends and holidays. No reservations required on weekdays.
ALL DAY - ALL LIFTS - weekends and holiays: Adults \$11.00, Juniors \$7.00. Weekdays: Adults \$7.00, Juniors \$5.00.
HALF DAY (PM ONLY) - Weekends: Adults \$7.00, Juniors \$6.00 when available. Weekdays: Adults \$4.00, Juniors \$3.00.
RENTALS - RED CARPET SKI SHOP - K-2 skis, boots, poles - 1 day \$9.00, 2 days \$14.00, 5 days (Mon.-Fri.) package plan rates \$19.00.
SKI SCHOOL - MIKE BANNON - DIRECTOR
Class lessons - \$6.00 per lesson; \$25.00 for 5 lessons; \$45.00 for 10 lessons. Private lessons \$12.00 per person; \$5.00 each additional person. A.T.M. and Graduated Length Method.
FACILITIES - Base Lodge and Observation area. Restaurant at Mountain. Nursery on weekends and holiday weeks. Ticket reservations limited to insure more skiing and short lift lines on weekends and holiday weeks. All tickets not reserved in advance are sold at ticket office. Free cross-country trails.
SNOW PHONE AND RESERVATIONS - 603-374-2369
(toll free) 1-800-258-0316



Black

Location - 2 miles north of the covered bridge in Jackson on Route 16B
Elevation - 2300'
Vertical drop - 1200', Southeast exposure
Snowmaking - J-Bar slope
Lifts - Double chairlift - 4300'
2 T-Bars - 3500' and 1300', J-Bar 850'
Trails - Up to one mile long, 3 novice, 5 novice-intermediate, 5 experts, 2 practice slopes

RATES:
ALL DAY - ALL LIFTS - weekends and holiday weeks - Adults \$8.00 - Juniors \$6.50. Weekdays - Adults \$6.00 - Juniors \$4.50.
HALF DAY (PM) - ALL LIFTS - weekends and holiday weeks - Adults \$6.00 - Juniors \$5.00. Weekdays - Adults \$4.00 - Juniors \$3.50.
BAR LIFTS ONLY - ALL DAY - weekends and holiday weeks - Adults \$7.00 - Juniors \$5.50.
HALF DAY (PM) - Adults \$5.50 - Juniors \$4.50.
SEASON TICKETS:
1st member \$150.00, 2nd member \$120.00, additional family members, \$85.00.
RENTALS - JACK FROST SKI SHOP:
Fiberglass skis (GLM sizes included), boots, poles - 1 day \$8.50, 2 days \$15.00, 3rd and succeeding days \$6.00. 5 day (Mon.-Fri.) MWV Member Lodge Package \$19.00. Cross Country skis, poles, boots - 1 day \$6.00, 2 days \$8.50, 3rd and succeeding days \$2.00.
SKI SCHOOL - DON BEMIS, DIRECTOR
Class lessons - \$5.00 1 lesson, \$18.00 4 lessons, \$32.00 8 lessons, \$70.00 20 lessons. Private lessons - \$12.00 1 person, \$17.00 2 persons. Freestyle and racing programs. NASTAR, Thursdays and Saturdays.
FACILITIES - Cafeteria, base lodge, nursery, accommodations at area, skating. Hot soups & bread boards compliment your beverage served in the loft of our new barn lounge.
SNOW PHONES - 603-383-4490 / Nights - 603-383-4291



Cránmore

Location - Within village limits, 1 mile east of Route 16 and 302
Elevation - 2000'
Vertical drop - 1500', East/West exposure
Snowmaking - On two 3000' slopes
Lifts - 2 tramways in tandem - 5500'
3 double chairlifts - 2700', 4650', 2800',
Poma - 1600'
Trails - Up to 1 1/2 miles long, 1 novice, 7 intermediate-expert, 5 expert, 4 novice-intermediate slopes

RATES:
ALL DAY - ALL LIFTS - weekends and holiday weeks - Adults \$10.00 - Juniors \$7.00. Weekdays - Adults \$7.00 - Juniors \$5.00.
HALF DAY (PM) - weekends and holiday weeks - Adults - Juniors \$6.00. Weekdays - Adults - Juniors \$5.00.
LOWER SKIMOBILE AND MIDWAY CHAIR - Single ride \$1.00 - 20 coupon book \$18.00.
POMA LIFT - single ride .50 - 20 coupon book \$9.00.
SEASON TICKETS:
FAMILY PLAN - 1st member \$190.00 - additional members \$140.00.
MID-WEEK - Mon.-Fri. excluding holiday weeks \$80.00.
RENTALS - CARROLL REED SKI SHOP:
Fiberglass skis, boots and poles for 1 day \$8.50, for 2 days \$15.00, 3rd and successive days \$6.00. Cross Country skis, boots and poles for 1 day \$6.00, for 2 days \$8.50, 3rd and successive days \$2.00.
HANNES SCHNEIDER SKI SCHOOL - Herbert Schneider, Director
Class lessons - \$6.00 1 lesson, \$20.00 4 lessons, \$32.00 8 lessons, \$130.00 40 lessons, \$8.00 1 full day.
PRIVATE LESSONS - \$12.00 per hour, per person. \$3.00 each additional person up to 4.
FACILITIES - Eating House Restaurant - cocktail lounge, Base Lodge Snack Bar, Summit Lodge and Snack Bar, Sun Decks.
SNOW PHONES - 603-356-5544 & 5545.



Tyrol

Location - 1 mile off Route 16B in Jackson
Elevation - 2450'. Vertical drop - 1000'
North and Northeast exposure
Lifts - Double chairlifts - 3850',
T-Bar - 2350', Poma - 1000'
Trails - Up to one mile long, 2 novice, 5 intermediate, 3 expert, 3 slopes

New innovative ticketing concept: T.S.S.T. enables skiers to purchase skiing for preferred periods of a day, or purchase the full measure (all day) ticket. With T.S.S.T. you may ski the time of the day which is right for you. (Purchase in advance).

T.S.S.T. (TYROL SKIER SAVINGS TIME)
Weekends & Holiday Weeks

| | ADULT | JUNIOR | |
|-------------------|--------------------------|--------|--------------|
| ALL DAY | \$9.00 | \$7.00 | FULL MEASURE |
| 8:30-10:30 | 3.00 | 2.00 | FRESH TRACKS |
| 10:30-12:30 | 4.00 | 3.00 | TAN TIME |
| 12:30- 2:30 | 4.00 | 3.00 | EXPOSITION |
| 2:30-closing* | 3.00 | 2.00 | SUNDOWNER |
| Sunset to Sunrise | TYROL SNOW GROOMING TIME | | |

* Closing time no earlier than 4 pm. Lifts will close 4:15, 4:30, 4:45, 5:00 as the days become longer.

WEEKDAY RATES - ALL DAY - Adults \$6.00, Juniors \$5.00.
HALFDAY - AM or PM - Adults \$3.00, Juniors \$3.00.
POMA LIFT ONLY - ALL DAY - weekends and holiday weeks - Adults \$5.00 - Juniors \$5.00. Afternoons - Adults \$4.00 - Juniors \$4.00.

SEASON TICKETS:
Family Plan: 1st member \$150.00, 2nd member \$120.00, additional members \$90.00. 10% discount before Nov. 1st.
Tyrol/Jackson Ski Touring Foundation joint season ticket. Family Plan: 1st member \$165.00, 2nd member \$130.00, additional family members \$95.00. 10% discount before Nov. 1.

RENTALS - JACK FROST SKI SHOP:
Fiberglass skis (GLM sizes included), boots, poles - 1 day \$8.50, 2 days \$15.00, 3rd and succeeding days \$6.00. 5 day (Mon.-Fri.) MWV Member Lodge Package \$19.00. Cross Country skis, poles, boots - 1 day \$6.00, 2 days \$8.50, 3rd and succeeding days \$2.00.

SKI SCHOOL - BEN WILLIAMS, DIRECTOR E.P.S.I.A. & P.S.I.A.
1 hour private lesson - \$7.00 1st person, \$5.00 each additional person, maximum 3 people, given hourly. Instructor half day - \$30.00. GLM 5 day package (includes lesson, equipment, and all lifts) \$65.00. Weekends and Holiday weeks 11 am. Beginners Group and Children's Group - \$5.00 per person. NASTAR RACE CLASS mornings before races. FREESTYLE: special freestyle program.

FACILITIES - Base lodge, cafeteria, sundeck, lunch and apres ski at "The Lounge at Tyrol", NASTAR races Thursdays, Saturdays and Sundays, "Tyrol Talkies" - classic cinema Thursday evenings in the Lounge.
SNOW PHONE - 603-383-4315, 603-356-5524 & Ellis Nos.



Wildcat

Location - Route 16, Pinkham Notch, 8 miles north of Jackson. Elevation - 4000'
Vertical drop - 2100'. Northwest exposure
Lifts - Gondola - 6800'
2 double chairlifts - 4490' and 4200'
Triple chairlift - 1400', T-Bar - 2800'
Trails - Up to 2 1/2 miles long, 7 novice, 7 intermediate, 8 expert, 3 slopes

RATES: Adult all areas - Weekends and holidays \$11.50 (all lifts), \$9.00 (chair lift only). Weekdays \$8.00. After 12:30 pm - weekends and holidays \$8.50 (all lifts), \$7.00 (chair lift only). Weekdays \$6.00.

Junior (13 and under) all areas - Weekends and holidays \$7.00. Weekdays \$6.00. After 12:30 pm - weekends and holidays \$5.00. Weekdays \$4.50.

Snowcat Novice Area Triple Chair: All ages, any day \$5.00. After 12:30 pm \$4.00.

RENTALS - JACK FROST SKI SHOP:
Fiberglass skis (GLM sizes included), boots and poles - 1 day \$8.50, 2 days \$15.00, 3rd and succeeding days \$6.00. 5 day (Mon.-Fri.) MWV Member Lodge Package \$19.00.

SPECIAL DAY - Toofer Ticket (every Wed. except holiday weeks) 2 for the price of 1.
SKI SCHOOL - RICK OWEN, DIRECTOR. American Technique and GLM instruction.

Class lessons - \$6.00 am and pm, 2 lessons same day \$10.00. 10 lessons \$45.00. 20 lessons \$75.00. 30 lessons \$100.00. Private lesson for 1 person \$12.00, additional person \$5.00 each. Various lift and lesson packages offered.

FACILITIES - Cafeteria, ski shop, baby-sitting (daily). Warming huts at base, T-bar area and summit. STANDARD RACE every Wed. and Sat.

SPECIAL EVENT - Annual "Corn Snow Caper," second weekend in April. Fun Races, Costume Events, Mogul Contest, etc.
SNOWMAKING - Covering entire novice area and T-bar slope, 750' vertical.

SPECIAL RATES - Student Ski Assoc., Active Military, Senior Citizens, Organized Groups (20 or more persons).

SNOW PHONE - Toll free in N.H. 800-552-8952; rest of New England and N.Y. (except area 716) 800-258-8902. Business phone 603-466-3326 year round. Also all Ellis Ski Information Center Numbers.



Artists & Craftsmen

DAVID C. BAKER Jackson 383-4308
Rt. 16. Art Gallery since 1951.

MACK BEAL Intervale 356-5040
Blacksmith and sculptor. Dundee Notch Rd.

THE CHOCORUA POTTERS Chocorua 323-7939
Alan & Bob Solar constitute the Chocorua Potters. Working in stoneware and porcelain at their studio/gallery in Chocorua, their ware is available locally at The North Country Fair, Main St., N. Conway. Their pots include both contemporary and classical styles, and are organic in clay and glaze. These include the earthy colors of the seasons. Classes as scheduled. Private commissions accepted. Winter, 10-6. Summer, 10-8. Open 7 days.

DROWNE'S WOODCARVING SHOP N. Conway 356-5012
Rt. 16, Intervale Rd. Open all year. Carvings and bronzes of wildlife. Open most mornings in Winter.

DON GALVIN—WILDLIFE WOODCARVINGS N. Conway 356-3345
6 Kearsarge St. in the "Swiss Shops".



LeBARGE STUDIO & GALLERY Conway 447-5809
Rt. 16. Wood Sculptor, Statues, Bas Reliefs, Sculptured Signs.

THE LION GALLERIES N. Conway 356-2461
New England's most exciting new gallery... displaying the painting, prints, crafts, and sculptures of the leading artists from this region as well as Boston and New York in a building uniquely designed for the purpose.

OLD SCHOOLHOUSE POTTERY Effingham Falls 539-6425
Teaware, dinner sets, casseroles, mugs, planters, functional pots, and flights of fancy. Lynn Stanhope.

R.G. PACKER ART GALLERY & STUDIO N. Conway 356-2834
South Main St. Oil paintings, landscapes, seascapes, still life, New England and European. Open year round. Am. Exp., Mast. Char., Bank Amer.

C. SELMI ART GALLERY N. Conway 356-5200
Art Gallery on Main St. in North Conway Village, Rt. 16. Realistic paintings of New England. Open year round.

DICK SMITH, PHOTOGRAPHY N. Conway 356-2814

Real Estate



AIR LAND CORPORATION Conway 447-5780
Located in Village Block, Washington St. Owns buildings and facilities for shops, stores, assembly hall, meeting rooms, and apartments, which are for rent or sale or lease-sale, and can be modified to tenant's or buyer's requirements. Land for both commercial and residential building sites and acreage is also available. Box 530.

BADGER REALTY N. Conway 356-5757
Jackson 383-9080
Conway 447-6692

The Valley's most experienced professional firm of Realtors and Builders offering a wide selection of mountain chalets, village and country homes, condominiums, lakeshore cottages, building sites, acreage and profitable business properties. Seasonal and year-round rentals. Complete custom design and building program. Financial and appraisal services. Offices open daily 9-5, including Sundays.

CONWAY HAMPSHIRE ESTATES N. Conway 356-5636
Developers, owners, and managers of large acreage, subdivisions, apartments, chalets, and commercial space.

COUNTRY SQUIRE REALTY N. Conway 356-2719
The friendly Country Squire is here to take care of your Real Estate needs: Residential or vacation homes, rentals, land — all sizes and shapes, commercial properties and a complete custom building service from plans to moving day. Come in, get acquainted whether buying or selling, and let the Country Squire serve you. Open 7 days.

GS CORPORATION Kearsarge 356-5123
Also Mass. phone, 716-227-4141. Owners and Developers of Rolling Ridge at Attitash Mountain, Rt. 302, Bartlett, N.H. Year round homes and chalets. Your choice of scenic mountain view homesites from 1/2 acre to multiple acres, bordering Attitash ski area and National Forest. Indoor tennis, swimming; all sports within 1 1/2 miles. Homes built to your specs. Other properties from 1 to 500 acres. River front or mountain views. Financing available.

HAMEL REAL ESTATE N. Conway 356-5441
The Valley's fastest growing real estate company with three offices and an energetic, professional staff to serve you. Whether buying, selling, or building a home, looking for land or investing in commercial property, Hamel can help! Member of National Homes for Living network; exclusive agent for Sullivan Homes; active Commercial Division. Located on Rt. 16 just north of N. Conway Village. In Chocorua (323-8585) at the intersection of Rts. 113 & 16. Also Main St. in Gorham (466-2710). All offices open seven days a week. Let us help make our Valley your home.

JACQUELYN JONES, REALTORS Jackson 383-4326
A full service real estate office in the quaint village of Jackson offering select properties and custom building in the Mt. Washington Valley.

MILOTTE ASSOCIATES, REALTORS N. Conway 356-3330
Realtors' service offering prime properties and professional assistance. Large selection of residential and vacation homes, condominiums and lakeside properties, business listings, building sites and acreage tracts. Appraisals, insurance service, and mortgage brokerage 24 hour phone service. Office open 7 days a week. Licensed in N.H. and Mass.

MT. WASHINGTON VALLEY REAL ESTATE N. Conway 356-5150
Robert Lincoln, Broker. Your full service Real Estate office. Enjoy the effervescence of Alpine living. We offer mountain, lakefront, rural and residential properties. Our commercial dept. is ready to help you find a good income producing business or property as well as quality land investment. Our building dept., Glen Ledge Const., has the area's finest builders who do custom building to suit your needs of style, size and cost. 24 hour phone service. Our office is located just north of the Airport on Rt. 16, Box 200, 03860.

PINKHAM MOUNTAIN PROPERTIES N. Conway 356-5425
North Conway office located next door to the Mt. Washington Valley Office, carrying a complete list of homes, businesses and large and small parcels of land. Glen office (383-9022) located at Glen Shopping Center, next to the P.O. Licensed in N.H. & Mass.

RECREATION REALTY Jackson 383-9200
Developers, builders, owners, managers, in condominiums, apartments, land acquisitions, and residential home sites. Also phone 356-3401. Write Box 24, Jackson, 03846.

RECREAMA DEVELOPMENT TRUST Intervale 356-2301
Owner and manager of White Horse Condominium and Apartment Building — for sale or rent. Developer of Hill & Vale Condominiums in Intervale.

STEINMEISTER REALTY CORP. Jackson 383-6669

WHITE LAKE ESTATES Chocorua 323-9395
Real Estate and Cabin Rentals



Builders

BACHMAN BUILDERS Conway 447-5673
A small efficient general contracting firm, specializing in residential, vacation and retirement homes.

EDWARD BERNDT Jackson 383-4483
Home building associates. Custom homes and quality remodeling.

CON DIV. Chocorua 323-7981
Engineering Consultants. General Contracting.

WILLIAM G. DUPREY & SON INC. N. Conway 356-5361
Artist Falls Rd. General Contractors.

DON DURNAM Jackson 383-9339
Mason, Contractor. Pinkham North Rd.

GLEN LEDGE AREA Jackson 383-9569
Building sites, new homes, and rental units. Owen Jefferson, owner.

GLEN LEDGE CONSTRUCTION CORP. Jackson Box 159
General Contractors. Ed Poliquin, 356-3401. Bill Rice, 383-9276.

HAMPSHIRE CONTRACTING Intervale 356-3492 — 356-3448
A young creative company with ideas. Call us for all types of new construction, remodeling, and custom home designing. Free estimates.

H. R. HOYT CONSTRUCTION CO. Conway 447-2612

PETER JARDIM, CONSTRUCTION Kearsarge 356-9722

J.E.S. BUILDER Jackson 383-9339
Rt. 17. Custom home builders. General contractor. Box 189. Pinkham Notch Rd.

STEVE H. LULLMANN, BUILDER N. Conway 356-3379
Building and Remodeling.

LYNN HOME CONSTRUCTION N. Conway 356-5968
Interesting Ideas—Interesting Homes. Model Homes available for inspection! Granite Post Rd.

JOHN MOTT PAINTING & DRY WALL Conway 447-3374
Interior and exterior painting and dry wall. Roofing. Box 830.

NORTHEAST HOMES N. Conway 356-3600
Distributor for KEY-LOC Corp. of Suncook, NH and Biddeford, Me; Div. of Hodgson Houses, Inc. We have 34 basic models plus custom designs, ranging from two bedroom ranches and capes to eight bedroom luxury multi-levels. All are top quality, minimum maintenance, conventional wood platform frame construction and built to meet and exceed single family home standards of B.O.C.A., F.H.A. and Farmer's Home Admin. Visit our model home in North Conway on Rts. 16 & 302 next to Northway Bowling Lanes.

SUMNER RUPPRECHT Glen 383-9062
Rt. 302. Custom home construction, remodeling, period restoration, interior design, and finishing.





Shops



BAKER'S PEEL Ossipee 539-4429
Located next to Sunny Villa Restaurant. A fine country shop specializing in the unusual. Antiques, gifts, china, glass, pewter, handmade doll house furniture, accessories, plus much, much more. Open weekends. The Powers Family.

B & G ECONOMY DRUG Gorham 752-6102
Located in the Valley Plaza. Open daily 9 - 9. Sundays 1 to 6. Prescription Services.

CARROLL REED SKI SHOPS N. Conway 356-5511
The BEST and most professional ski headquarters for the latest equipment, accessories, rental/repairs; and 7 days a week instant service with additional ski shop at Mt. Cranmore. Year-round North Conway shop, in the center of town, is a kaleidoscope of domestic and imported casual active sportswear, including gifts, for all the family and friends. Since 1936, the best in skiing, active sportswear and tennis.

CHERRY VALLEY COUNTRY STORE N. Conway 356-5741
Offering wonderful gifts, decorating accessories, reproductions, antiques, and other delightful items. Open year round. On Kearsarge St. Barbara & Ted Dorofee.

THE COUNTRY PEDDLER Glen 383-9753
Rt. 302, 1/2 mile west of northern junction of Rts. 16 & 302. A Country Store... featuring gifts, Pickle Barrel, Old Fashioned candies and snacks, antiques, maple products, bandanas, suspenders, toys, wooden cooking utensils, whole grain flour, buttermilk, and buckwheat pancake mix, clam chowder, indian pudding, baked soldier beans, large pearl tapioca, aprons, pot holders, tote bags, calico's, patchworks, 23 flavors of tea, honey, 28 jelly and preserve flavors, relishes, etc., etc.

THE CUCKOO'S NEST N. Conway
South Main St. Next door to N.H. League of Craftsmen. Antiques, collectibles, gifts, and imported clothing. Specializing in Nostalgia.

BOB DUNCAN CAMERA & RECORD SHOP N. Conway 356-2714
Opposite the park in North Conway. Largest variety of fresh film in the Mountains. Where you get the help of Professional Photographers. Open 9-5:30. Mon. thru Sat.

EASTERN MT. SPORTS N. Conway 356-5433 - 356-5434
Open 9-9, 7 days a week. Specialists in quality, lightweight camping and mountaineering equipment. Rental tents, packs, sleeping bags, stoves, cross country ski equipment and snowshoes. Technical Climbing School and Kayaks.

HOME FANCIES N. Conway 356-5491
North Conway's only home shop! Curtains, drapes, woven wood shades, custom drapes, bedspreads, linens, tablecloths, shower curtains, bath accessories and many gift items. See our luxurious cushion seats or one of our unique scales. For the unusual in home decor visit Home Fancies on Kearsarge St., a shopper's delight. Open all year.

HOUSE OF COLOR Intervale 356-2909
For 20 years one of NH most popular shops. A complete spectrum of gifts, finer jewelry, leather apparel, and moccasins. Our extensive mineral dept. is a must to see. Free rock cutting demonstrations daily. Our "Country Living" furniture barn is loaded with New England's finest upholstered furniture and accessories. Be sure to stop in... We're "on your way" and have plenty of parking. Winter hours: 10-5 daily.

INTERNATIONAL MT. EQUIPMENT N. Conway 356-5287
On Main St. next to the cinema. Specialists in backpacking, climbing, cross country skiing, general mountaineering goods and clothing. Climbing School.

JACK FROST SKI SHOPS Jackson 383-4391
The Alpine & Nordic Skiers Pro Shop... rental and repair shops at Black, Tyrol, and Wildcat and the Jackson Ski Touring Center. Professional staff to help select the right equipment, new or used. Outstanding collection of ski and apres-ski fashions for men and women by International designers. Headquarters for cross country equipment and Nordic ski fashions. Touring trails, ski school, and rentals at the Jackson Ski Touring Center, next to the Village Shop. page 12

JOE JONES SHOP N. Conway 356-2891
A professional equipment and repair shop with a friendly, family atmosphere. Fast, dependable service by trained ski technicians. Exclusive Hart Ski and Hanson boot dealer. Unique selection of domestic and imported ski apparel and sportswear. Large used equipment department. Rentals - skis, skates, snowshoes. Complete line of sporting goods including hiking and camping equipment. Ski touring equipment and rentals.

MOUNTAIN BOOK SHOP N. Conway 356-2922
In the Village of North Conway. Books, cards, stationery, maps, playing cards, calendars, jigsaw puzzles, and selected gifts. Rental Library. Mary Peacock.

THE MOUNTAIN TROLL Jackson 383-9050
Scandinavian imports for people with flair for living. Fashion, furniture, lamps, jewelry, gifts, and more. Scandinavian wood stoves. Your window on the Scandinavian world.

OTTO NINOW MUSIC STORE N. Conway 356-5752
Instruments, accessories, sheet music, and piano tuning. Hours, Winter 5 pm - 7 pm. Summer Noon - 5:30 pm. Closed Mondays.

NORTH COUNTRY PHOTO N. Conway 356-5018
Main St. & Seavey St. North Conway's only full service shop! Professional services by Art & Caryn Turner including: darkroom & studio rental, photo library, photo instruction, sales, portraits, weddings, etc. Open Tuesday thru Sunday.

NORTH HAMPSHIRE COMMON N. Conway 356-5643
One of North Conway's most unique attractions set in restored Victorian buildings nestled around a common green, bordered by brick walkways and gaslights. Ornate Victorian Ice Cream Parlour-Restaurant, Cheese Shop, General Store. Toy Shop. Gift Emporia, and Christmas Shop. Dine or browse—you will enjoy and remember the Common & its country atmosphere of a bygone era. Kearsarge St.

PRIMITIVE PINE FURNITURE Jackson 383-9225
Complete household of woodware. Handcrafted, unique gifts. Located on Rt. 16, three houses north of Mobil Station. Open daily.

RADIO SHACK & JMJ BOOKS Conway 447-5644
IGA Shop. Ctr. Everything in Electronics, Books and Records.

SHAW'S SUPERMARKET N. Conway 356-5471
Northway Plaza. Famous foods, delicatessen, imported cheeses, beer, cigarettes, biggest supermarket in the Valley. Open weekdays 9-9. Sundays 10-6. You're someone special at Shaw's.

SUZUKI SHED N. Conway 356-5755
Snowmobile rentals. Located on Rt. 16 & 302. Full line of Suzuki motorcycles and Arctic Cat snowmobiles. At the Airport and behind Barnaby's.

TOM'S VARIETY N. Conway
South Main St. Groceries and cold drinks. 6 am to midnight, daily.

TRADER DICK ANTIQUES Intervale 356-3333
5 miles north of North Conway on Rts. 16 & 302. Fine antiques and collectibles. Open on weekends and by appointment in the winter. Open daily in summer. If no answer call 383-9222.

THE VILLAGE CONFECTIONERY N. Conway 356-5818
Unusual Candy shop filled with delicious Confections. Bon-bons and candies of all kinds. Our chocolates are hand packed to your order. The "Gold Seal" with our name on your order says "Quality." We feature the famed Alexander Dolls. Open year round.

VILLAGE PHARMACY N. Conway 356-5712
In the Village. Prescription and health and beauty aids, greeting cards, magazines, newspapers, sunglasses, etc. Richard & Ann Madden, Reg. Pharms.

WAYSIDE GIFT SHOP N. Conway 356-5720
Located in the New Eastern Slope Inn. Gifts and Partridgeberry wreaths in season. Open year round.

YE GARDEN CENTER & COUNTRY GIFTS Intervale 356-5255
Garden supplies, shrubs, tools, ground covers, garden mums, Christmas trees and wreaths. Country store goods, gifts, dried flowers, and year round trim a tree shop.

THE ORIGINAL YIELD HOUSE N. Conway 356-3141
Nationally-famous original designs in solid White Mt. Pine. Desks, tables, hutches, dry sinks. Country collectibles & antique reproductions. Practical family furniture. Special Kit Room do-it-yourself. Get your copy of the newest Yield House Catalog. Winter hours: 10-5. Open 7 days a week. Major credit cards.

Business Services

ABBOTT FARM APTS. Kearsarge Box 15

ABBOTT'S DAIRY Conway 447-5401
Dairy Foods.

CARROLL COUNTY TRUST CO. Conway 447-5425
Branches in North Conway & Ossipee. Mt. Washington Valley's "Most Progressive Bank." Full Banking Service.

JOHN F. CHICK & SON N. Conway 356-5749
CARROLL COUNTY CO. N. Conway 356-5517
Both under one roof on Rt. 16 in the center of town. Hardware, power equipment, building materials and complete building services.

CINAMETTE CORPORATION N. Conway 356-2921
North Conway Movie Theatre. Finest in first-run films. Dollar night, Monday & Tuesday.

CONWAY SUPPLY Conway 447-3301
Glen 383-9500
Building materials and hardware.

COUNTRY HOUSEKEEPER N. Conway 356-3354
Commercial and residential cleaning. Property maintenance and carpet cleaning.

DALKEITH CORP. Jackson 383-9576
Aircraft leasing and charters. Also NY phone: 516-293-1414.

A. D. DAVIS & SON, INC. N. Conway 356-5581
Modern Insurance Services. Homer H. Hamlin, Pres.; Robert J. Murphy, Vice Pres.; James P. Jeffrey, Financial planning service. Office also in Gorham, 466-3384.

DIAMOND INTERNATIONAL N. Conway 356-5514
Specialists in lumbers, hardware, building materials and paint.

HOWARD DICKINSON Ctr. Conway 447-2266
Consulting Forester and Representative to the General Court.

DUNDEE HIGHLAND SERVICES CORP. Intervale 356-2379
General Services.

EASTERN SLOPE BEAUTY SALON N. Conway 356-5332
On Main St. Hours: Monday thru Saturday, 8:30 to 5:30. Jean S. Perry, Proprietress.

BENJAMIN FISHSTEIN, ARCHITECT, AIA Jackson 383-9411
Glen Ledge Rd. Functional designs for living-working-recreation: Homes, town houses, professional and commercial facilities. Energy efficient environments in natural luxury and economy.

FORBES SUNOCO N. Conway 356-5703
Avis car rental.

FRECHETTE OIL CO. N. Conway 356-5342
Maurice Frechette, owner.

GILLIES & PRITTEE N. Conway 356-5427
Wholesale lumber and distribution yard.

GLEN ACRES CORP. Jackson 383-9043

GLEN LEDGE CLEANERS Jackson 383-9276

HEMLOCK HILL ACRES Jackson 383-4244
Green Hill Rd. Limited number of selected scenic home sites. For appointment call Arthur Doucette.

THE IRREGULAR N. Conway 356-3407
Mt. Washington Valley's bi-weekly newspaper featuring events, characters, and items of interest in the region. Copies are complimentary to visitors and friends and can be found in shops, restaurants, and inns. The Irregular's dining and entertainment section highlights the Valley's dining establishments and after dark spots.

KEARSARGE METALLURGICAL CORP. Conway 447-3363

LARRY'S MOBILE HOME SALES INC. Gorham 466-3357
Modular Homes and Mobile Homes on display. Free delivery, set up and service. Open 7 days. Largest dealer in the North Country. Rt. 16, Berlin-Gorham Rd.

LYMAN'S SHELL SERVICE STATION N. Conway 356-2411
Complete automotive service. Shell Heating Oil. Open 7 days.

MAIN ST. MOBIL N. Conway 356-2901
In the Village. Major and minor repairs, sun electronic tune-up. Bear wheel alignment. 24 hour wrecker and road service.

MEAD INSURANCE AGENCY, INC. N. Conway 356-5648
Complete insurance protection. Located in "The Villa" next to the theatre. Arthur E. Mead.

MOUNTAINVALE INDUSTRIES Conway 447-2263
Specialists in Mobile Homes. Mt. Washington Valley's newest mobile home community - Mountainvale Village - for those who appreciate the unspoiled natural setting afforded by mature pines and birches. Box 366.

NORTH CONWAY BANK N. Conway 356-5466
The bank of the Mt. Washington Valley. Serving business and family since 1900 with "Full Service" banking. Open Monday thru Thursday 8:30 am to 6 pm. Friday until 8 pm and Saturday until Noon.

JOHN PIETKIEWICZ Jackson 383-9358
Architectural design, landscaping, and building services.

REPORTER PRESS N. Conway 356-5566
Commercial printing, specializing in 4 color work. Newspaper and office supplies. Offset and Letterpress.

STUART ROBERTSON APTS. Intervale 356-2077
30 year round apartments. 1 and 2 bedrooms.

SALEM WITCH MUSEUM TRUST Jackson 383-6640
Audio Visual Museum and Consultants.

ROBERT SCHROEDER & CO. N. Conway 356-3417
Management consultant.

SHAMROCK VILLAGE COTTAGES Intervale 356-5153
Housekeeping cottages. Rt. 16-A, RFD, 03845. Also call: 617-774-8816.

SPENCER PRESS, INC. Glen 383-9537
Commercial printing.

TOWN EDGE PROFESSIONAL APTS. Conway 356-5947
Furnished and unfurnished year round rentals. Walking distance to Village.

VALLEY EMPLOYMENT N. Conway 356-3131
Put your employment needs in the hands of the Valley's own professional personnel consultants. Whether you are looking for a position or someone to fill a position, call Valley Employment for immediate results. Open Monday to Friday, 9-5 and Saturday by appointment.

WALKER'S POND PRESS & ADV. CO. Center Conway 447-5844
Printing, advertising, and publishing.

WBNC RADIO STATION Conway 447-5988
1050 on your AM dial. 93.5 on your FM dial. Weather phone: 447-5252.

WELCH INSURANCE AGENCY, INC. N. Conway 356-5146
Kearsarge St. Insurance for every need. Donald L. George, treasurer.

WHITE MOUNTAIN AUTO SUPPLY N. Conway 356-5528
Complete supplies for automotive needs.

WHITE MOUNTAIN NATIONAL BANK N. Conway 356-5588
People you can turn to in Conway, North Conway, and Glen. Members F.D.I.C.

WHITE MOUNTAIN OIL CO. N. Conway 356-2681
Dependable suppliers of Fuel Oils, LP Gas and Appliances. Heating specialists. Emergency Service.

WILDWOOD GARDENS N. Conway Box 296
page 13



Calendar

Weekly Events

Every Sunday NASTAR Races at Cranmore
 Every Sunday Fierce & Friendly Dual Slalom at Attitash
 Every Tuesday Ladies Day at Black (lift, lesson & lunch)
 Every Wednesday 2 for the price of 1 at Wildcat
 Every Thursday Free Movies at The Lounge at Tyrol 9:30 pm
 Every Thursday Night Cross-Country Skiing, 7:30-9:30 pm, at Jackson Ski Touring Foundation
 Every Thursday Free Movies at the Lounge at Tyrol 9:30 pm
 Every Friday Local Yokel Races at Cranmore
 Every Week Waxing Clinic 9:30 am at EMS Ski Touring
 Every Day

Special Events

Nov. 8 Eastern Ski Club, Used Ski Equipment Sale, 10 am, No. Conway Community Center
 Dec. 14-16 NASTAR Pace Setting Trail Race at Cranmore
 Dec. 20-12 Christmas Invitational at Cranmore
 Dec. 28 Triumph of the Timid NASTAR Race at Tyrol
 Jan. 3-4 Jack Frost Memorial Cross Country Race, Jackson Ski Touring Foundation
 Jan. 3 Blustery Bubble Gum Race at Tyrol
 Jan. 3 Joe Dodge Cup, Jr. & Sr. Slalom at Wildcat
 Jan. 10 ESA Citizens Race at Attitash
 Jan.* Aston Little Memorial Race at Cranmore*
 Jan. 11 Aerial Competition at Black
 Jan.* Rhode Island Championship at Cranmore*
 Jan. 17 Red Parka Pub Race Series at Tyrol
 Jan. 17 Veteran's Slalom at Wildcat
 Jan. 18 Bill Clapp Memorial Race at Cranmore
 Jan. 18 Ballet Competition at Black
 Jan. 18 Giant Veteran's Slalom at Wildcat
 Jan. 27 J. Wilfong 6th Annual Challenge & Stampede at Attitash
 Jan. 31 National Freestyle Championship at Wildcat
 Jan. 31 Simpson Memorial Race at Tyrol
 Feb. 5-6 Double Downhill Jr. at Wildcat
 Feb. 7 Aerial Competition at Black
 Feb. 7 Red Parka Pub Race Series at Tyrol
 Feb. 7-8 State Championships, Jr. I & II at Cranmore
 Feb. 10 Greater Bartlett Bartenders & Barbaronesses Race at Attitash
 Feb. 14 Valentine Vendetta at Cranmore
 Feb. 21 2nd Annual Bronzed Bikini Bounce Christie Contest at Tyrol
 Feb. 21-22 NH State Freestyle Championships at Black
 Feb. 22 George Washington's Father of the Family Team Race at Tyrol
 Feb. 28 Aerial Competition at Black
 Feb. 29 T.S.S.T. Extra Day Extravaganza at Tyrol
 Mar. 1 Governor's Cup, Top Sr. Men & Women at Cranmore
 Mar. 6-7 Eastern Freestyle Championships at Black
 Mar.* B.U. Intercollegiate Race at Cranmore*
 Mar. 6-7 Red Parka Pub Race Series at Tyrol
 Mar. 13 Governor's Cup Race, Jr. & Sr. Giant Slalom at Wildcat
 Mar. 14 Downhill Disco-Boogie Race & Mulligan Stew Meatball Derby at Tyrol
 Mar.* Carroll Reed Classic at Cranmore*
 Mar. 20 Annual Sack Run Slalom at Wildcat
 Mar. 20-21 Eastern Slalom Derby at Cranmore
 Mar. 26-28 National Amateur Freestyle at Wildcat
 Mar. 28 Benedict Arnold Forgive & Forget Festival at Tyrol
 Apr. 10-11 Corn Snow Caper at Wildcat

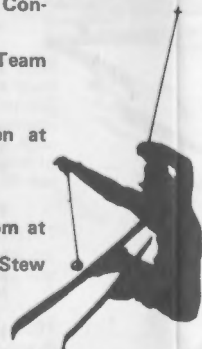

Along with great skiing...

Mt. Washington Valley, New Hampshire's complete winter resort has many, many other activities for you—eight lovely villages nestled on the eastern slopes of the White Mountains—specialty shops—artists—entertainment—covered bridges—gift shops—pubs—movies indoor tennis and swimming—antiques—restaurants galleries—spectacular mountain views and the crisp clean air of a New England Winter.

ICE SKATING — There are public rinks in Conway, North Conway and Jackson. Many inns have their own rinks for guests.

SNOWMOBILING — Rentals at Suzuki Shed. Trails on Hurricane Rd. and Bearnotch Rd.

TOBOGGANING — At many of the lodging establishments.

SNOWSHOEING & ICE CLIMBING — Eastern Mountain Sports and International Mountain Equipment offer equipment, information and advice.

MOVIES — North Conway Theatre 356-2921 and Tyrol Mt. every Thurs. & Fri. night.

MT. WASHINGTON VALLEY SWIM & TENNIS CLUB Glen 383-6811
 Large indoor swimming pool, saunas, and indoor professional tennis courts. Pro shop for all your tennis needs, nursery, game room and The Broken Racket Courtside Lounge, for relaxing. Open 7 days from 8 am to 12 pm. Special day rates. Advance reservations through your motel or us.

MOAT VIEW TERRACE CAMPING N. Conway 356-5578
 A Four Season, adult and family campground. 1 1/2 miles on West Side Rd. off Rts. 16 & 302. 75 sites w/ modern facilities. Elec. & complete hookups. Swimming, fishing. Sorry! no pets, mini bikes, motorcycles. Daily, weekly, seasonal rates. Winter Nov. 1st to April 30. Summer, mid May to mid Oct. Dogs allowed after Labor Day. Rates, immed. family of 4 \$4.50 & \$5. Info. J. Henry & Harriette Thompson, West Side Rd., N. Conway, 03860.

NORTH CONWAY PINES CAMPGROUND N. CONWAY 356-3305
 Open year round. Two miles w. off Rt. 16 & 302 on West Side Rd. 46 sites with heated rest rooms and showers. Recreation hall and Gen. Store. Rates: Season; Nov. 15 — May 15 \$160.00; Weekly \$28.00; Daily \$5.00. The Peer Family, West Side Rd., N. Conway, NH 03860.

Mt. Washington Valley
 Box WB385
 New Hampshire 03860

Vacation
 Package Plans
 Seasons Ahead
 Volvo Tennis

Please send me more information on Mt. Washington Valley - 1976

Name.....
 Address.....
 zip.....

*Check date with mountain.
 page 14

the seasons ahead...

Even before spring skiing ends, the summertime activities begin in Mt. Washington Valley. Trees and grass turn green and the countryside bursts forth with flowers and a new spirit. Tennis courts are manicured... golf courses groomed. Hiking trails dry and outdoor resort activities begin in earnest. Boats, canoes, kayaks and rafts are made ready... lakes and rivers warm up for swimming and fishing. The scenic vistas—waterfalls and other natural masterpieces open up for viewing and photographing. The band gets ready for its Sunday concerts in the park. The gorgeous flowers are planted. Work begins on the big Volvo Tennis Tournament. Baseball and soccer fields, picnic and camping areas... all ready for the enjoying.

If you'd like complete information about the wonderful seasons ahead in Mt. Washington Valley just fill in the coupon and send it.



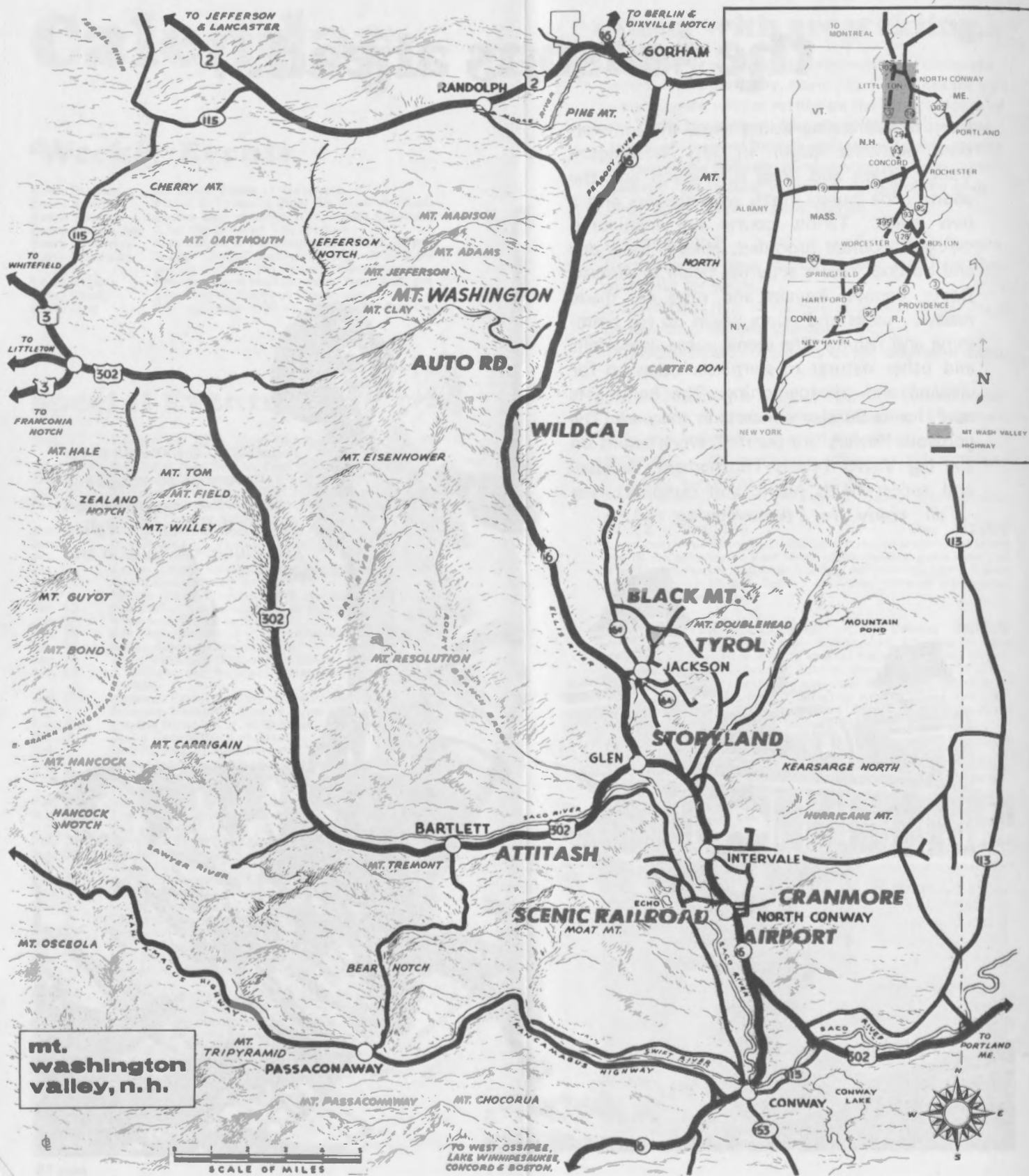

**mt.
washington
valley, n.h.**

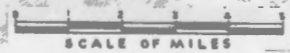

TO WEST OSSIPPEE,
LAKE WINNIPESAUKEE,
CONCORD & BOSTON.

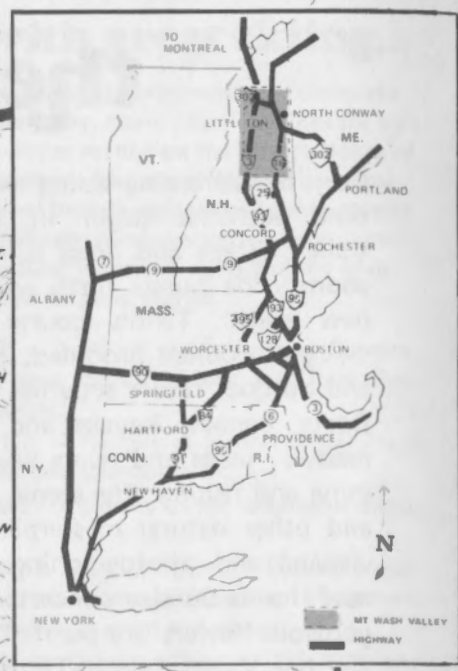

THE
**New
England
Inn**

INTERVALE, N.H.



*presents
another
glorious
wintertime
in the
white mts.*



Rte. 16A, Intervale, N.H. 03846
Mt. Washington Valley
603 356-5541

featured in
Country Inns
& Back Roads



CORDIALITY is the feeling you encounter the moment you step through the front door of The New England Inn. Its heritage from a by-gone era, polished bright by the passing years. A wide choice of accommodations, from comfortable rooms and suites in the main Inn or in the Hampshire House across the road, to cozy single cottages, duplex cottage units and modern motel units give the vacation-bound couple or family a broad spectrum of rates and room arrangements.

The New England Inn has been a landmark for travellers for well over a century and for the last 37 years has been under the same family ownership emphasizing personal attention.

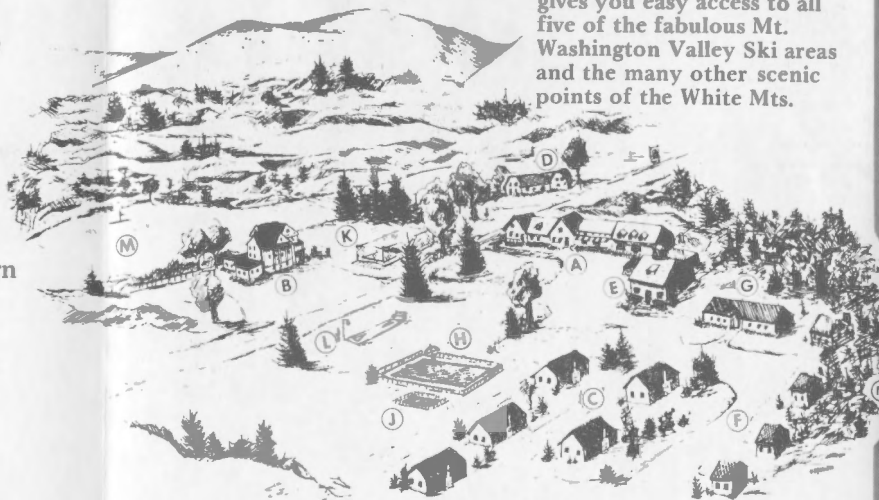

A. The Inn / B. Hampshire House / C. Duplex Cottages
 D. Tennis Courts 1 & 2 / E. The Motel / F. Single Cottages
 G. The "Chicken Coop" / H. Swimming Pool / J. Wading Pool
 K. Tennis Court 3 / L. Shuffleboard / M. Golf Course
 N. Cross Country Skiing Trails

The Inn's central location gives you easy access to all five of the fabulous Mt. Washington Valley Ski areas and the many other scenic points of the White Mts.

SCHEDULE OF RATES

WINTER 1975-76

Rates listed are—number of occupants, per room per day, based on the Modified American Plan which includes Dinner (the evening meal), a full Yankee Breakfast and lodging—all rates subject to 5% New Hampshire Room and Meal Tax. 15% gratuities.

THE INN (double room with bath)

| | |
|-----------|----------------|
| 1 person | 23.00 to 31.00 |
| 2 persons | 43.00 to 51.00 |

HAMPSHIRE HOUSE (double rooms with bath)

(Holiday weeks only)

| | |
|-----------|----------------|
| 1 person | 25.00 to 35.00 |
| 2 persons | 45.00 to 56.00 |

THE MOTEL

Two separate units with a common entrance. Attached to the main Inn. Each unit contains two double beds and private bath.

| | |
|-----------|-------|
| 2 persons | 52.00 |
| 3 persons | 64.00 |
| 4 persons | 72.00 |

DUPLEX COTTAGES

Each unit (2 separate units per cottage) contains a bedroom with either 2 twins, 2 doubles or a king-size bed, a living room with 2 Statler beds, fireplace, private bath and guest controlled heat.

| | |
|-----------|--------|
| 2 persons | 62.00 |
| 3 persons | 75.00 |
| 4 persons | 86.00 |
| 5 persons | 98.00 |
| 6 persons | 106.00 |

SINGLE COTTAGES

Each cottage has a large pine-panelled room with a double bed, twin bed and fireplace. Private bath.

| | |
|-----------|-------|
| 2 persons | 58.00 |
| 3 persons | 70.00 |
| 4 persons | 78.00 |

All rates subject to change without notice.

GENERAL INFORMATION

Additional occupant in a room, using rollaway—\$16.

Cribs—no charge.

Children under 12 years of age are allowed a \$5 reduction from the regular rate. Children under 4 years of age are allowed an \$8 reduction from the regular rate.

Our season extends from Dec. 19 to Mar. 20.

MT. WASHINGTON VALLEY PACKAGE PLAN



starting Jan. 5 to closing
 3, 4, 5 days Mid-week only
 (Monday thru Friday)

February Vacation excluded (16-20)
 Full Advance Deposit Required

ELEGANCE: Duplex or Cottage

| TWO PERSONS | | ONE PERSON | |
|-------------|--------|------------|--------|
| 3 days | 188.70 | 3 days | 128.85 |
| 4 days | 251.60 | 4 days | 171.80 |
| 5 days | 314.50 | 5 days | 214.75 |

CHARM: Inn

| TWO PERSONS | | ONE PERSON | |
|-------------|--------|------------|--------|
| 3 days | 176.70 | 3 days | 116.85 |
| 4 days | 235.60 | 4 days | 155.80 |
| 5 days | 294.50 | 5 days | 194.75 |

PACKAGE INCLUDES:

Lodging, Breakfast, Dinner (daily)
 Downhill, Cross Country Skiing (daily)
 Lifts, Lessons, Rental—ALL AREAS
 Swimming, Sauna and Tennis Daily
 Movie Ticket
 Shopping Coupons—All Major Shops
 (Carroll Reed, etc.)
 N.H. Room and Meals Tax & Tips for Maids, Waitresses.

RAVINE ROOM LOUNGE

Open 4:30 till midnight. Weekends and Holiday weeks: 12:30 till midnight. Apres ski—entertainment and dancing.

A full a la carte luncheon is served weekends only in the dining room. Box lunches put up at your request. Indoor tennis and swimming available nearby.

Special EMS Ski Touring Rentals are \$2. Trails start from the Inn.

To relieve guests of the inconvenience of direct tipping, a service charge of 15% will be automatically added to the total room, food and beverage charges to cover all gratuities.

ADVANCE DEPOSITS

An advance deposit is necessary to confirm a reservation. It guarantees that the space will be occupied for the entire length of time requested. Upon receipt of 5 days notice, deposits are returned. The amount of deposit required for a confirmed reservation is dependent upon the rate and length of time desired.

BREAKFAST

Served 8:00 to 9:30 AM

Sliced Oranges Chilled Juices of Your Choice
 Stewed Prunes Baked Apple in Dairy Cream
 Fresh Fruits, Melons and Berries in Season

North Country Porridge with Brown Sugar
 Hot and Cold Cereals of Your Choice

Country Fresh Eggs, As You Like Them Omelettes, Any Style
 Pancakes with Pure Maple Syrup

Golden French Toast Crisp Waffles
 Blackhawk Bacon Fresh Link Sausage
 Home Fried Potatoes Grilled Sugar Cured Ham

Hot Muffins and Doughnuts—Baked Fresh Daily on the Premises
 Buttered Toast Toasted English Muffins

Coffee—Our Special Blend—All You Want
 Milk—Whole, Skim or Chocolate
 Hot Chocolate, Sanka, Postum or Tea

DINNER

Served 6:30 to 8:30 PM

Chilled Fruit Cup Supreme Cape Cod Cranberry Juice Cocktail
 Herring Fillets in Cream Sauce Home Made Soup du Jour
 Shrimp Cocktail

Assorted Relishes and Cottage Cheese
 Hearts of Lettuce Tossed Green Salad
 Choice of Dressings

Large Prime Western Sirloin Steak
 1 1/4 Pound Live Maine Lobster with Drawn Butter
 Broiled Lamb Chops with Mint Jelly

*Roast Prime Ribs of Beef, au jus
 *Baked Sugar Cured Ham with Raisin Sauce
 *Broiled Half Spring Chicken
 *Fried Fillet of Fresh Sole with Tartare Sauce
 *Cold Sliced Assorted Meats

Fluffy Whipped Potatoes French Fried Potatoes
 Fresh Native Corn on the Cob Berkshire Traveller Baked Squash
 Hot Home Made Rolls

New England Inn's Frozen Lemon Pie
 Fresh Native Strawberry Shortcake
 Whistling Oyster's Fudge Cake
 Baked Indian Pudding with Ice Cream
 Warm Spicy Gingerbread with Whipped Cream
 Ice Cream and Sherbets Boston Cream Pie
 Brownies a la Mode Cherry Jello with Whipped Cream
 Grand Marniere Parfait Assorted Cheeses and Crackers

Coffee—Hot or Iced Tea—Hot or Iced
 Whole, Skim or Chocolate Milk



New England Inn
 Intervale, NH 03845 / 603 356-5541

ed by **AAA** mobil guide



master
 charge

Some items in this folder were not digitized because it contains copyrighted materials. Please contact the Gerald R. Ford Presidential Library for access to these materials.

Ford to get massive greeting in N. H.

By ROBERT L. HASSETT
and JIM MORSE

MANCHESTER, N.H. — A massive airport reception will greet the arrival of President Ford and his family today as he opens a weekend drive for votes in the nation's first Presidential primary.

President Ford will be accompanied by his wife, Betty, daughter Susan, son, Michael and his wife, Gail, giving Granite State voters a first hand look at the nation's first family and their bid to remain in the White House.

The President's plane is expected to land at Grenier Field here about 11 a.m. Cam-

services at a white-frame Presbyterian Church in Bedford and meet with campaign volunteers before a news conference at Durham and a question-and-answer session with students at the University of New Hampshire.

The First Family will return to Washington tomorrow night.

His campaign trip here, 17 days before the Feb. 24 New Hampshire primary, was his second of the year. Last weekend he flew to his home state of Michigan to address the Midwestern Republican Conference.

The President will be arriving in New

boost Thursday night when retired Sen. Norris Cotton, honorary chairman of President Ford's New Hampshire election committee, told Reagan if the President falters in the primary elections he will support the former California governor "with enthusiasm."

Other presidential candidates also will be stumping the state for voter attention.

E. Leo Kanteres, a Manchester realtor and a Democratic activist since he became involved in John F. Kennedy's 1960 campaign, said he doesn't believe any of the five major candidates on the ballot here will emerge as the Democratic nominee.

Ford irked by Nixon trip

By PHILIP SHABECOFF

(C) N.Y. Times News Service

WASHINGTON — President Ford, publicly noncommittal about former President Nixon's impending trip to China, is privately irritated, White House officials said yesterday.

Boston
Herald 2-7-76
American



Welcome,

Nashua Telegraph

... New Hampshire's Largest Evening Newspaper ...

NASHUA, NEW HAMPSHIRE, SATURDAY, FEBRUARY 7, 1976

SPECIAL PRESIDENTIAL EDITION

Nation Watching Ford And Nashua

By JOHN STYLIANOS

The President, who gave the world a lesson in the dangers of pushing the United States too far, will address the 50th anniversary dinner of the Greater Nashua Chamber of Commerce tonight. An enthusiastic gathering of more than 1,200 is expected to pay a rousing tribute to President Gerald R. Ford and First Lady Betty Ford.

Hampshire's role in the American Revolution. Nashua is one of the fastest-growing cities in the country, and he may discuss the U.S. economy and progress of recovering from the recession.

Frank L. Harvey is chairman of the yearly event, and he will serve as toastmaster. Ross A. Tait is president of the Chamber, which is observing its 50th year as a civic organization.

N.H. Forester Offers Views On Energy

BY JACQUELINE HUARD
CONCORD, N.H. (UPI) —
The thick, lush forests covering 85 per cent of New Hampshire's land could be the state's solution to the energy noose which threatens residents with shortages and sky high prices if John Calhoun has his way.

But the consulting forester says his plan for an alternate energy source, a woodgas burner which eats wood chips

The supply for the burner "is literally choking our forests," he said.

"We've increased by 50 per cent the amount of standing timber in our forests in the past 15 or 20 years. There is far more timber growing than is being harvested" Calhoun said. "The only trouble is the quality of the timber is decreasing because we have too many trees."

He said there is no incentive

President addresses 102 student leaders

By LARRY KRAMER

Special to Herald American

WASHINGTON, D. C. — One hundred and two high school student government leaders from around the country were lectured in political science here yesterday by the man most qualified to speak on the subject — The President of the United States.

President Gerald R. Ford met with the student delegates from the Senate Youth Program in the White House reception room and told them, "you are the future of this country. And this is a country worth struggling for and working for."

Ford said the program, funded by the William Randolph Hearst Foundation and sponsored by the Senate, "was one of the best programs of this sort I've seen . . . it really produces

down the unemployment rate. Calling unemployment the biggest problem the nation faces today, Humphrey said:

"The government has a responsibility to use the money it gets. We can use work on roadways and cleaning up streets. We can put young people to work ~~cleaning up the railroad~~ beds, which are in a terrible state of disrepair."

Humphrey, responding to questions, said he was not a candidate for the presidency, and disavowed an effort on his behalf in New Hampshire.

"The man who is running that campaign effort for me in New Hampshire, whom I don't know, says he has raised \$1000. That's not enough to send a notice to his grandmother. I have disavowed the effort by telegram and in letters," he



Welcome, M

Nashua Tele

... New Hampshire's Largest Evening Newspaper ...

NASHUA, NEW HAMPSHIRE, SATURDAY, FEBRUARY 7, 1976

VOL. 107 NO. 287

Continuing the New Hampshire Telegraph
Established October 20, 1832

28 PAGES

Warm Welcome Awaited At Chamber Dinner

By JOHN STYLIANOS
More than 1,200 will pay
tribute to President Gerald
R. Ford tonight when he

gymnasium, with the
program opening at 7.

First Lady Betty Ford will
be by his side.

The President arrived at
Grenier Field in Manchester
late this morning for a busy
weekend in the state. This

University
campus in
that night
Gymnasium



Nashua Telegraph

President Ford -- Yes!

The Nashua Telegraph extends to President and Mrs. Gerald R. Ford the warmest and most cordial of welcomes and on the occasion of the President's address to the Greater Nashua Chamber of

icial and suave and support what is sound, dignified and diligent; that it will, in short, lead the nation in the presidential cavalcade for Gerald R. Ford.

President Ford's capabilities

A Sampler of Opinion

Ford: The Logical Choice

PORTSMOUTH HERALD

Three weeks from now New Hampshire's ardently courted voters of both political parties will be tramping to the polls in small numbers to make their wishes known as to the next President of the United States.

Unless the voters really fool us, we see no hope for the massive turnout that appeared on Sept. 16, 1975, to ballot in the Durkin-Wyman election.

Reagan is in the enjoyable position of being able to promise anything that his audiences want to hear, all the while knowing that Congress won't enact one-tenth of his crackpot ideas.

The President, although possessing the tremendous advantages of his office, also finds himself handicapped by at least two great disadvantages: (1) He's the President and has to live with any statements he makes, good or bad; he can't keep explaining the way Reagan does.

On The Political Scene

By IRA R. ALLEN

By United Press International

Republicans had their eyes north on New Hampshire today. The Democrats had theirs south on Oklahoma.

President Ford made his first campaign trip of the year, flying to New Hampshire for a weekend of stumping in the tracks of Ronald Reagan, who ended another of his Granite State forays Friday and plans to

could do well in caucuses as well as primaries.

Ford Friday told a Washington gathering of northeastern state Republicans his administration rejects "quick fix gimmicks and snake oil solutions" for "full economic recovery. Ford did not mention Reagan in his speech, but some eyebrows went up when he said. "The American people in 1976 are not concerned with the polished 'image' of

ing busing but not proposing alternatives. Jackson said he has drafted legislation to provide a \$50 million discretionary fund to help cities like Boston pay the costs of court-ordered desegregation.

He said his amendment is backed by Sen. Edward M. Kennedy, D-Mass., Boston City Council president Louise Day Hicks and Boston School Committee chairman John McDonough, who endorsed

People in the news

Susan Ford will present ski trophies in North Conway, N. H. this weekend during a political campaign swing for her father in New Hampshire.

A spokesman for the Mount Washington Valley Chamber of Commerce said Miss Ford will arrive at Mt. Cranmore today and will be met by local officials.

The President's daughter will present trophies to winning ski racers of the day with a special plaque for David Currier, a

the government for the past 10 years, saying he can make it on his own.

Morris is 75-years-old and blind.

He has been an employe of Virginia Industries for the Blind since 1925 and was recently named National Blind Worker of the Year.

"If I have to retire, maybe then I'll have to accept them (the checks)," Morris said. But, he added, he will not leave the workshop "until I feel like I can't give them a full day's work."