

**The original documents are located in Box 10, folder “Aged” of the Gerald R. Ford Vice Presidential Papers at the Gerald R. Ford Presidential Library.**

### **Copyright Notice**

The copyright law of the United States (Title 17, United States Code) governs the making of photocopies or other reproductions of copyrighted material. Gerald R. Ford donated to the United States of America her copyrights in all of her husband’s unpublished writings in National Archives collections. Works prepared by U.S. Government employees as part of their official duties are in the public domain. The copyrights to materials written by other individuals or organizations are presumed to remain with them. If you think any of the information displayed in the PDF is subject to a valid copyright claim, please contact the Gerald R. Ford Presidential Library.

Some items in this folder were not digitized because it contains copyrighted materials. Please contact the Gerald R. Ford Presidential Library for access to these materials.



Issues

Aged  
Glenn, Viola B.

January 3, 1974

re: post hospital  
nursing home care

Mrs. Viola B. Glenn  
13251 State Road  
Nunica, Michigan 49448

Dear Mrs. Glenn:

This is in regard to your recent letter expressing your views relating to the problem of obtaining post hospital nursing home care.

Although the Vice President is away from the city at the present time, he has asked me to express his thanks for writing.

You may be assured your letter has been carefully read, and Mr. Ford appreciates that you have taken the time to write in this connection.

Sincerely,

A. B. Schram  
Assistant to the  
Vice President



Date Nov. 26-1973

From: Mrs Viola Glenn  
13251 State Rd.  
Nunica, Michigan  
49448  
Zip Code

To: Hon. Gerald Ford  
U.S. Senate  
Senate Office Building  
Washington, D.C. 20510  
Zip Code

I, as a Senior Citizen, and a participant in the Medicare Program, am writing concerning the problem of obtaining post hospital nursing home care.

Our present Medicare Program provides for nursing home care after hospitalization. However, in our area no nursing home will accept Medicare patients.

They will accept Medicaid patients and those who have sufficient money to afford a prolonged stay in their facilities.

It appears that only the very poor and very wealthy can obtain nursing home care in this area. Those of us who do not fit in either of the above categories, i.e., who have too much income to qualify for Medicaid and not sufficient money to pay for a prolonged stay, can not obtain nursing home care and benefits.

I pay \$6.80 per month for Medicare, and according to my policy am entitled to this care. I, as a Senior Citizen and a participant in the Medicare Program, wish to go on record as protesting this inequity.

Thank-you for your help.

Sincerely yours,

Mrs Viola B. Glenn



~~CONFIDENTIAL~~ ISSUES

"Aged"

(SCHLEY, Thomas L.)

re: CAP

February 13, 1974

Mr. Thomas L. Schley  
Executive Director  
EIGHTCAP, Inc.  
P.O. Box 435  
Stanton, Michigan 48888

Dear Mr. Schley:

Thank you very much for your recent letter and the enclosed copy of your Title VII Proposal.

Although I will be unable to comment in detail on this proposal, I was pleased to review your plans for Montcalm County. This information was of interest to me and I am pleased that you took the time to provide me with a copy.

I want to wish you every success in your endeavors.

With kind regards.

Sincerely,

Gerald R. Ford

GRF:t



# EIGHTCAP, INC.

P.O. BOX 435 - Stanton, Michigan 48888

Phone (517) 831-4747

December 26, 1973

Vice President Gerald R. Ford  
Suite 720  
Federal Building  
Grand Rapids, Michigan 49502

Dear Vice President Ford:

As the Executive Director of Eight-CAP, Incorporated, I felt you would appreciate an opportunity to comment on the attached Title VII Proposal which has been submitted to the Department of Social Services for funding consideration.

I am sure you will agree that the aged population residing in Montcalm County should be provided those programs and services which will allow them to live in dignity and health. This program is designed to provide them with nutritious meals and a cordially stimulating atmosphere. Your support will be appreciated by myself and the senior population.

This program would help insure a happy 1974 for many Montcalm County Senior Citizens.

Yours truly,

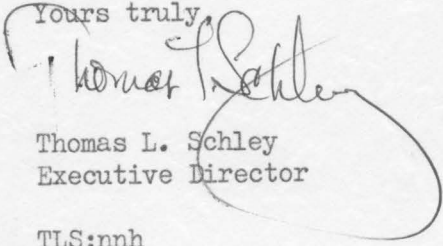
  
Thomas L. Schley  
Executive Director

TLS:nnh  
encl.





STATE OF MICHIGAN  
DEPARTMENT OF SOCIAL SERVICES

APPLICATION FOR NUTRITION PROJECT AWARD  
UNDER TITLE VII OF THE OLDER AMERICANS ACT

(FOR STATE AGENCY USE)					
1. TITLE OF PROJECT: <p style="text-align: center;">Montcalm County Nutrition Program for the Aged</p>					
2. TYPE OF APPLICATION: <input checked="" type="checkbox"/> NEW <input type="checkbox"/> CONTINUATION <input type="checkbox"/> REVISION <input type="checkbox"/> SUPPLEMENT					
3. PROJECT DIRECTOR (NAME, TITLE, DEPARTMENT, AND ADDRESS - STREET, CITY, STATE, ZIP CODE):  To be named	6. DATES OF:		FROM	THROUGH	AMOUNT
	A. PROJECT PERIOD		1-1-74	12-31-74	\$
	B. BUDGET YEAR		1-1-74	12-31-74	\$
SOCIAL SECURITY NO.:		AREA CODE	TELEPHONE NO.		
7. TYPE OF ORGANIZATION: <input type="checkbox"/> PUBLIC AGENCY <input checked="" type="checkbox"/> PRIVATE NON-PROFIT AGENCY					
4. APPLICANT AGENCY (NAME AND ADDRESS - STREET, CITY, STATE, ZIP CODE):  Eight-CAP, Inc. P.O. Box 435 Stanton, Michigan 48888			8. PAYEE (SPECIFY TO WHOM CHECKS SHOULD BE SENT - NAME, TITLE, ADDRESS):  Eight-CAP, Inc. P.O. Box 435 Stanton, Michigan 48888		
5. NAME, TITLE, ADDRESS OF OFFICIAL AUTHORIZED TO SIGN FOR APPLICANT AGENCY:  Mable Poindexter, Chairwoman P.O. Box 435 Stanton, Michigan 48888			9. (FOR STATE AGENCY USE)		
10. TERMS AND CONDITIONS: It is understood and agreed by the undersigned that; 1) funds awarded as a result of this request are to be expended for the purposes set forth herein and in accordance with all applicable laws, regulations, policies, and procedures of this State and the Administration on Aging, Social and Rehabilitation Service of the U.S. Department of Health, Education, and Welfare; 2) any proposed changes in the proposal as approved will be submitted in writing by the applicant and upon notification of approval by the State agency shall be deemed incorporated into and become a part of this agreement; 3) the attached Assurance of Compliance (Form AoA-441) with the Department of Health, Education, and Welfare Regulation issued pursuant to Title VI of the Civil Rights Act of 1964 applies to this proposal as approved; and 4) funds awarded by the State Agency may be terminated at any time for violations of any terms and requirements of this agreement.					
11. SIGNATURE (PERSON NAMED IN ITEM 5):			DATE		
<i>Mable Poindexter</i> SIGNATURE			11-30-73 DATE		



**BUDGET SUMMARY FOR BUDGET YEAR**  
 FROM \_\_\_\_\_ TO \_\_\_\_\_  
 (COMPLETE SUPPORTING BUDGET SCHEDULES BEFORE THIS PART)

PAGE 1 OF 7

Rev. 6-15-73

A. DIRECT COSTS				
BUDGET CATEGORY (1)	MEALS COSTS (2)	SUPPORTING SOCIAL SERVICES COSTS (3)	ADMINISTRATIVE COSTS (4)	TOTAL PROJECT COSTS (SUM OF COLUMNS 2, 3, & 4) (5)
1. PERSONNEL (INCLUDING FRINGE BENEFITS)	\$	\$	\$	\$ 23,860.00
2. EQUIPMENT				770.00
3. RAW FOOD				23,400.00
4. TRAVEL (STAFF ONLY)				3,410.00
5. CONSULTANTS				
6. OTHER COSTS*				4,769.00
7. TOTAL DIRECT COSTS	\$	\$		\$ 56,209.00
B. INDIRECT COSTS				
a. IS INDIRECT COST REQUIRED? <input type="checkbox"/> NO <input type="checkbox"/> YES		d. BASED ON: <input type="checkbox"/> SALARIES AND WAGES		
b. PERCENTAGE RATE: _____ %		<input type="checkbox"/> TOTAL ALLOWABLE DIRECT COSTS		
c. NEGOTIATED AGREEMENT: DATE _____		e. BASE: \$ _____		
C. TOTAL PROJECT COSTS (TOTAL LINES A(5) 7 AND B)				\$ 56,209.00
D. PROJECT INCOME				\$ -----
E. PROJECT NET COSTS (LINE C LESS LINE D)				\$ 56,209.00
F. LOCAL NON-FEDERAL PARTICIPATION			%	\$ -----
G. FUNDS REQUESTED (LINE E LESS LINE F)			%	\$ 56,209.00

\*INCLUDES CONSUMABLE SUPPLIES EXCEPT RAW FOOD  
 DSS-3263 (Rev. 9-73)





Rev. 6-15-73		SUPPORTING BUDGET SCHEDULE										PAGE 2 OF 7	
BUDGET CATEGORY (1)	PROGRAM ACTIVITIES											TOTAL COSTS = SUM COL. (2)-(4)+(12) (13)	
	MEALS		SUPPORTING SERVICES TOTAL = SUM COL. (5)+(11) (4)	SUPPORTING SERVICES BY ACTIVITY									
	CONGREGATE (2)	HOME DELIVERED (3)		ESCORT & TRANSPORTATION (5)	OUTREACH (6)	INFORMATION & REFERRAL (7)	COUNSELING (8)	NUTRITION EDUCATION (9)	SHOPPING ASSISTANCE (10)	RECREATION (11)	ADMINISTRATION (12)		
1. PERSONNEL (ITEMIZE BY TITLE)	\$	\$	\$	\$	\$	\$	\$	\$	\$	\$	\$	\$	
Project Director												9,500	9,500
Fringe												1,425	1,425
Site Coord	936	156		624	1,248	624			624	468			4,680
Site Coord	936	156		624	1,248	624			624	468			4,680
Site Coord	468	78		312	624	312			312	234			2,340
Fringe	247	41		165	329	165			164	124			1,235
TOTAL PERSONNEL COSTS	\$ 2,587	\$ 431	\$	\$ 1,725	\$ 3,499	\$ 1,725	\$	\$	\$ 1,724	\$ 1,294	\$ 10,925	\$	\$ 23,860



Rev. 6-15-73

SUPPORTING BUDGET SCHEDULE

PAGE 3 OF 7

BUDGET CATEGORY (1)	PROGRAM ACTIVITIES											TOTAL COSTS = SUM COL. (2)-(4)+(12) (13)
	MEALS		SUPPORTING SERVICES TOTAL = SUM COL. (5)-(11) (4)	SUPPORTING SERVICES BY ACTIVITY								
	CONGREGATE (2)	HOME DELIVERED (3)		ESCORT & TRANSPORTATION (5)	OUTREACH (6)	INFORMATION & REFERRAL (7)	COUNSELING (8)	NUTRITION EDUCATION (9)	SHOPPING ASSISTANCE (10)	RECREATION (11)	ADMINISTRATION (12)	
2. EQUIPMENT (ITEMIZE)	\$	\$	\$	\$	\$	\$	\$	\$	\$	\$	\$	\$
Insulated Food Transporters	413.00	22.00										435.00
Drink Dispensers	41.00	2.00										43.00
Food Containers	178.00	9.00										187.00
Metal Spoons	57.00	3.00										60.00
TOTAL EQUIPMENT COSTS	\$	\$	\$	\$	\$	\$	\$	\$	\$	\$	\$	770.00
3. RAW FOOD	\$	\$	\$	\$	\$	\$	\$	\$	\$	\$	\$	\$
10,400 contracted meals at \$2.25 per meal	22,230.00	1,170.00										23,400.00
TOTAL RAW FOOD COSTS	\$	\$	\$	\$	\$	\$	\$	\$	\$	\$	\$	\$

DSS-3263 (Rev. 9-73)





<u>Budget Category</u>	<u>Congregate</u>	<u>Home Delivered</u>	<u>Total Costs</u>
Cutting knives	33.00	2.00	35.00
Soup Ladles	10.00		10.00





Rev. 6-15-73		SUPPORTING BUDGET SCHEDULE										PAGE 4 OF 7
BUDGET CATEGORY (1)	PROGRAM ACTIVITIES											TOTAL COSTS = SUM COL. (2)-(4)+(12) (13)
	MEALS		SUPPORTING SERVICES TOTAL = SUM COL. (5)-(11) (4)	SUPPORTING SERVICES BY ACTIVITY								
	CONGREGATE (2)	HOME DELIVERED (3)		ESCORT & TRANSPORTATION (5)	OUTREACH (6)	INFORMATION & REFERRAL (7)	COUNSELING (8)	NUTRITION EDUCATION (9)	SHOPPING ASSISTANCE (10)	RECREATION (11)	ADMINISTRATION (12)	
4. TRAVEL (STAFF ONLY)	\$	\$	\$	\$	\$	\$	\$	\$	\$	\$	\$	\$
Director 100 miles per week at \$.11 per mile	6,800	25.00		38.00	69.00	69.00	69.00	37.00	38.00	37.00	100.00	550.00
Site Coord 5 x 100 miles per week x 52 weeks	578.00	95.00		512.00	763.00	381.00			381.00	150.00		2,860.00
TOTAL TRAVEL COSTS	\$ 646.00	\$ 120.00	\$	\$ 550.00	\$ 832.00	\$ 450.00	\$ 69.00	\$ 37.00	\$ 419.00	\$ 187.00	\$ 100.00	\$ 3,410.00
5. CONSULTANTS	\$	\$	\$	\$	\$	\$	\$	\$	\$	\$	\$	\$
TOTAL CONSULTANT COSTS	\$	\$	\$	\$	\$	\$	\$	\$	\$	\$	\$	\$



		SUPPORTING BUDGET SCHEDULE										PAGE 5 OF 7	
		Rev. 6-15-73											
BUDGET CATEGORY (1)	PROGRAM ACTIVITIES											TOTAL COSTS = SUM COL. (2)-(4)+(12) (13)	
	MEALS		SUPPORTING SERVICES TOTAL = SUM COL. (5)-(11) (4)	SUPPORTING SERVICES BY ACTIVITY									
	CONGREGATE (2)	HOME DELIVERED (3)		ESCORT & TRANSPORTATION (5)	OUTREACH (6)	INFORMATION & REFERRAL (7)	COUNSELING (8)	NUTRITION EDUCATION (9)	SHOPPING ASSISTANCE (10)	RECREATION (11)	ADMINISTRATION (12)		
6. OTHER COSTS*	\$	\$	\$	\$	\$	\$	\$	\$	\$	\$	\$	\$	
Office Supplies												400.00	
Telephone \$30 per month x 12												360.00	
Feeding site Paper & Plastic	711.00	38.00										749.00	
Recreational materials	475.00	25.00										500.00	
Bookkeeping and Secretarial Training												1560.00	
Audit												600.00	
TOTAL OTHER COSTS*	\$	\$	\$	\$	\$	\$	\$	\$	\$	\$	\$	\$ 4769.00	

\*INCLUDES CONSUMABLE SUPPLIES EXCEPT RAW FOOD  
DSS-3263 (Rev. 9-73)



SUPPORTING BUDGET SCHEDULE	
LOCAL NON FEDERAL PARTICIPATION	
SOURCE	AMOUNT
A. CASH RESOURCES	\$
SUB-TOTAL	\$
B. IN-KIND RESOURCES	\$
5 Congregate Feeding Sites	5,000.00
Contributions from Social Service Agencies	
Department of Social Services 1 hour per month, per feeding site at \$4.00 per hour	240.00
Social Security Representative 1 hour per month, per feeding site at \$4.00 per hour	240.00
Mid Michigan District Health Department and Montcalm County Mental Health 12 hours of health and welfare counseling at each of the five feeding sites	240.00
Cooperative Extension Services 12 hours nutrition education at each center = 60 hours	240.00
Michigan State University Dietetic Service menu developed and approved	200.00
Plus volunteers	
SUB-TOTAL	\$ 6,160.00
TOTAL	\$

BUDGET ESTIMATES FOR  
SUBSEQUENT BUDGET YEARS

Rev. 6-15-73

	1975 BUDGET YEAR (1)	1976 BUDGET YEAR (2)
A. ESTIMATED TOTAL PROJECT COSTS	81,713.50	111,818
B. ESTIMATED PROJECT INCOME	-----	-----
C. ESTIMATED NET PROJECT COSTS (LINE A LESS LINE B)	81,713.50	111,818
D. ESTIMATED LOCAL NON-FEDERAL PARTICIPATION	-----	-----
E. ESTIMATED FUNDS REQUEST (LINE C LESS LINE D)	81,713.50	111,818
F. ESTIMATED NUMBER OF MEALS TO BE SERVED	15,600 meals expand all feeding sites to three days per week	20,800 meals expand from five feeding sites feeding three days per week to six feeding sites three days per week and one serving two days





PART II: PLAN FOR THE PROJECT

The applicant agency must set forth a detailed plan for the delivery of meals and related social services for the proposed project area. This plan must address, at a minimum, the items identified in the outline below. The plan set forth by the applicant agency must also follow this outline and be numbered accordingly. All instructions for Part II are contained in the application itself.

1. Applicant Agency

- a. Attach a chart which describes the organizational structure of the agency. Also, indicate where in the organization of the agency, responsibility for the conduct of the proposed project is to be placed.

The applicant agency for the Montcalm County Nutritional Program for the Aged is the Governing Board of Eight CAP, Inc. a private nonprofit corporation duly recognized and chartered by the State of Michigan. The responsibility for the conduct of the proposed project will be vested in the Governing Board of the aforementioned private nonprofit corporation. See attachment A.

- b. Set forth the agency's qualifications, including personnel and physical facilities to undertake the proposed project. In addition, describe in detail the agency experience in:

- (1) provision of services to the elderly with specific reference to low income and minority group elderly:

Eight CAP, Inc. has been designated by the four political entities which it has served since February 1966 as the recipient of all



Office of Economic Opportunity 221 funds distributed in the geographical area. During the eight years of this corporation's existence, it has planned, programmed, maintained and evaluated \$14,151,884.00 of programs directed at the disadvantaged population existing within its geographical boundaries.





	<u>(Total)</u> <u>Federal Grant</u>	<u>(Total)</u> <u>Non-Federal</u>	<u>Total Program</u>
Conduct & Administration	218,464	43,064	
Community Organization	238,612	128,092	
Youth Program	61,473	55,157	
Migrant Head Start	15,065	1,536	
Emergency Food & Medical	115,000	3,800	
Day Care	3,905	0	
Head Start	592,169	254,472	
Senior Citizen Nutrition Program	6,800	0	
Neighborhood Services	22,098	8,448	
Direct Employment	10,200	160,000	
Career Development	1,800	0	
Senior Opportunities & Services	13,000	3,250	
Emergency Employment Act	<u>2,533,259</u>	<u>374,220</u>	
	3,831,845	10,320,039	14,151,884

b. 1 con:

Eight CAP, Inc. provides a multitude of services for the elderly population. These services include:

- a. Information and referral
- b. Transportation
- c. Legal Assistance
- d. Friendly home visitors (volunteers)
- e. Telephone reassurance
- f. Monthly Chat and Chow
- g. Free furniture and clothing
- h. Senior Nutrition Program
- i. Outreach
- k. Informational speakers

In addition to these direct services which are currently being provided on an ongoing basis, Eight CAP has undertaken many short term projects directed at serving or organizing the aged population.

These projects included: The coordination of Project Find, a special effort directed at identifying and qualifying that segment of the aged population in need of but not receiving food stamps distributed by the Department of Social Services.

A pilot project in cooperation with Community Education awareness of the aged population's needs and the expansion and creation of programs to specifically serve the aged population.

In the past 12 months Eight CAP, through community organization techniques, has successfully encouraged local senior citizens groups to unite and organize for the purpose of establishing and operating a Title III direct service program in Ionia County. As a result of an effort there now exists an Ionia County Commission on Aging and a proposal currently before the funding agent for Title III of The Older American Act.

- (2) Operation of meals program on behalf of the elderly. A pilot program has been in operation in Lakeview since April 19, 1973. The meals were prepared and served at Lakeview High School until the school term ended. Subsequently the Lakeview Hospital prepared the meals which were then served at the nearby United Church of Christ. After a three month trial period, Lakeview Hospital terminated the arrangement due to insufficient staff.

At this time in October, the program was re-evaluated as follows:

1. The common goal was to provide older citizens, particularly those with low income, with low cost, nutritionally sound meals served in strategically located sites, where they can obtain other social and rehabilitative services.
2. The performance objective is to offer twice weekly noontime meals at five sites in Montcalm County. Besides promoting better health among the older segment of the population through



improved nutrition, the program objective is aimed at reducing the isolation of old age, offering older citizens an opportunity to live their remaining years in dignity.

3. Assessment of the county needs for the aged indicates the following:

- (a) Location of the sites are designed to geographically offer convenient access throughout the county.
- (b) The buildings were selected with attractive decor to provide a pleasant atmosphere for enhancing the personal dignity of the participants.
- (c) Eligible individuals are those aged sixty and older who do not eat adequately because of physiological, psychological, social and economic changes that often occur with aging resulting in a pattern of living which may cause malnutrition and further physical and mental deterioration.

4. The October evaluation and testing of the Lakeview pilot project indicates that the program delivery system fulfills the assessed needs and common goal. Evaluation of eligible individuals indicates they include persons who:

- (a) Cannot afford to eat adequately.
- (b) Lacks the skills and/or knowledge to select and prepare nourishing and well balanced meals.

(c) Have limited mobility which may impair their capacity to shop and cook for themselves.

(d) Have feelings of rejection and loneliness which obliterate the incentive necessary to prepare and eat a proper meal alone.

5. A basic recommendation for improvement was to contract with a single catering service that would provide a consistency of well-balanced nutritional meals served in an appealing and attractive manner.

Another recommendation was to begin a weekly noon luncheon at Edmore, which began November 1, 1973 and has proven to be very successful.

When this proposal is approved, there are three additional planned sites which can begin operation January 15, 1974. The sites have been contacted, outreach work has been started, menus have been planned, catering service has been contacted and will provide the additional meals required to expand the program.

The Montcalm County Nutrition Program for the Aged has been well received by the rural areas as well as by the urban areas.

The project will expand to providing meals twice a week at the two existing sites as well as twice a week at the three proposed sites. The project program will be feeding twenty people at each site twice a week, averaging 200 people a week.

At present, the two sites where we have our program one day a week are averaging between 32 to 40 people.

- c. Indicate whether the applicant agency is a minority agency; that is, an agency operated by and/or serving primarily the needs of minority individuals.

Eight CAP is not a minority agency if by definition we recognize service to minority races as the criteria for minority agency. Eight CAP is a minority agency if the disadvantaged segment of the population is considered a minority group.

- d. If the applicant agency currently operates a meals program for the elderly, set forth the total amount of funds utilized for the program during the previous budget year.

Eight CAP, Inc. has operated a meal program for the elderly since April of 1973. The total amount of federal funds allotted for the operation of the pilot project was \$6,800.

- e. Does the applicant agency plan to enter into any subcontract (s) for the operation of meal sites, preparation of food, or the provision of meals or supporting social services? If subcontracts are proposed, set forth the agency (ies) to be contracted with; the purpose of the subcontract (s); the status (public, private non-profit, private profit making) and qualifications of the agency (ies); and the role and responsibilities of the applicant agency in carrying out the objectives of the program and in administering the subcontract (s).

- (1) Indicate to what extent any proposed subcontract (s) for operation of meals sites is with an agency (ies) operated by minority groups.



It is the intent of Eight CAP to subcontract only for the provision of meals for the proposed nutrition program. It is felt that the delegation of any additional responsibilities at the time would destroy the continuity and its positive affects in encouraging the aged population participation.

2. Project Area

- a. Identify the geographic area for the project. Include a map indicating the boundaries of the area.

The area to be served by the proposed nutrition project is designated as Montcalm County, a 710 square mile area located in the central portion of Michigan.

The county is essentially a rural area with agriculture as its largest industry. The total Montcalm County population was 39,660 according to the 1970 United State Census.

The largest city is Greenville with a population of 7,493 and located in the southwest part of the county. Greenville is the only urban area with a population over 2,500.

The county seat is Stanton, population 1,089, and located in the geographical center of the east sixteen townships. There is a total of 20 townships which contain 26 cities and villages. Maps of these 20 townships are included in this geographical area proposed for the nutrition project with a description of each site and surrounding rural area to be covered by the program.

By the United State Census categories, 19% of the county were considered to

be living in an urban environment (Greenville), while 81% were considered to be in a rural setting. The average population density was listed as 10.5 persons per square mile.

Montcalm County is bordered to the north by Mecosta and Isabella County, to the west by Newaygo and Kent County, to the south by Ionia County, and to the east by Gratiot County. The Flat River is the major river running through Greenville and the county from the south and directly north connecting with many streams. The county has 180 lakes and numerous resorts. The two east-west paved state roads are M57 and M46 which link up with U.S. 131 out of Grand Rapids. The north-south paved state roads are M91 through Greenville, and M66 through Stanton; and both of these roads link up with the major interstate highway, I96.

Farming is extensive and diversified, with grain, potatoes, fruit and dairying as principals. The county also has one of the largest gas storage fields in the United States.

Education institutions include Montcalm Community College located at Sidney and near Stanton. It is a two year institution with an approximate enrollment of 1,100 for the fall 1973 term.

- b. Describe the major characteristics of the proposed area. Give special attention to the socio-economic composition and size of the general population. Include a description of the geographic and physical conditions of the area.

Social Services and health agencies in Montcalm County include the following:

- a) Hospitals total 5.
- b) Nursing Care Facilities & Homes for the Aged total 5.



c) The county has 881 people per licensed physician (M. D. and D. O.) compared to 769 people per licensed physician in the whole state.

d) Existing Senior Citizen Groups whose membership was composed entirely or primarily of aging persons are as follows:

1. Crystal Senior Citizens Club
2. Carson City Area Senior Citizens
3. Lakeview Senior Citizens
4. Central Montcalm Senior Citizens
5. Edmore Senior Citizens
6. Greenville St. Paul's Lutheran Senior Citizens
7. Friendly Senior Citizens of Settlement Lutheran Church
8. Six Lakes Senior Citizens
9. Greenville Community Senior Citizens
10. Local 137, United Auto Worker Retirees
11. Fedders Retirement Club
12. Ionia - Montcalm Retired Teachers Association
13. Coral Senior Citizens
14. Montcalm Council on Aging
15. Greenville Housing Commission (constructing Senior Citizen Housing)

c. Describe in detail the composition of the elderly population (65 and over) of the area.

SOME STATISTICS ON MONTCALM COUNTY

(Source: General, Social and Economic Characteristics, Michigan, PC (1) - C24,  
Bureau of Census, United States Department of Commerce, April 1972)

1. Total population - Michigan	8,875,083
Total population - Montcalm County	39,660
2. Median Family Income - Michigan	\$ 11,032
Mean Family Income - Michigan	12,296
Median Family Income - Montcalm County	\$ 8,526
Mean Family Income - Montcalm County	9,175
3. Number persons 65 and over - State of Michigan	775,098
Percent of Montcalm County	8.4%
Number persons 65 and over - Montcalm County	4,435
Percent of Montcalm County	11.2%
4. Percent of persons 65 and over who fall below federally designated poverty level - Michigan	23.8%
Percent of persons 65 and over who fall below federally designated poverty level - Montcalm County	28.6%
5. Number persons Montcalm County of Spanish language designation	418
Number of persons Montcalm County 65 and over of Spanish language designation (all 5 are 75 and Female)	5

(Negro statistics not available because only counties  
with 400 plus negroes are reported)



6. Percent of all persons 65 and over who remain in labor force - Michigan	20.1%
Percent of all male persons 65 and over who remain in labor force - Montcalm County	12.2%
Percent of all female persons 65 and over who remain in labor force - Michigan	8.4%
Percent of all female persons 65 and over who remain in labor force - Montcalm County	10.5%

TABLE 1

Aging Population, Montcalm County by Township and Incorporated Municipalities

<u>Township/City</u>	<u>Total Population</u>	<u>Percentage of Total Population Over 65</u>	<u>Number of Persons Over 65</u>
Belvidere	1,345	13.2	177
Bloomer	1,152	8.6	99
Bushnell	1,025	10.2	104
Carson City (City)	1,217	12.8	155
Cato	2,205	13.6	300
Crystal	1,781	12.8	228
Day	1,180	10.4	123
Douglass	1,118	11.3	126
Eureka	1,938	6.6	128
Evergreen	1,842	9.1	168
Fairplains	1,087	9.3	101
Ferris	991	8.9	88
Greenville (City)	7,493	12.5	937
Home	2,487	11.4	284
Maple Valley	1,476	13.8	204
Montcalm	1,984	8.5	169
Pierson	1,261	10.7	135
Pine	984	11.8	116
Reynolds	1,830	12.5	229
Richland	1,832	8.4	154
Sidney	1,504	10.3	155
Stanton (City)	1,089	15.7	171
Winfield	839	10.0	84
County Totals	39,660	11.2	4,435



- d. (1) Document the extent to which the nutrition program is needed in the project area. In addition to the factors of low income, and minority group elderly (If applicable) cite other data which indicate the need of the elderly with reference to lack of mobility, isolation, and limited knowledge and/or skills and their application to adequate nutrition of the elderly.

Data must include elderly with the following characteristics; currently participating in nutrition projects, living alone, unable to use public transportation, physically disabled, feeling unwanted, not wanting to eat alone, having expressed limitations in meal preparation.

In addition to the demographic and economic indicator of need for a nutrition program, the Office of Community Services of Montcalm County conducted "A Study of the Needs and Interests of Aging Persons Residing in Montcalm County, Michigan."

This study was performed under a grant from the Michigan Commission on Aging to the Montcalm Council on Aging, and published in September 1972.

The following is an excerpt from a portion of the nutrition section of the study:

"SURVEY DATA" (p. 16)

Number of surveys conducted: N-264

Percent of Aging Population of Montcalm County: 6%

Total number of Aging Persons involved in interviews: 302

Racial composition of interviews:

Caucasoid - 264

Other - 0

Telephone:

Yes - 253

No - 11

96% of all persons interviewed reported having a telephone.

Location of residence:

A survey question sought to determine the location of the person's residence in relationship to a city or village.

For this purpose the communities considered a city or village were: Greenville, Sheridan, Stanton, Edmore, Lakeview, Carson City, and Vestaburg.

Number residing with in city - 154

Percent residing in city 62%

Number residing outside city - 110

Percent residing outside city 38%

The survey sought to determine the distance the rural persons lived from the city. The following chart indicates these distances.

TABLE 2

<u>Distance</u>	<u>Number of Persons</u>
Less than 1 mile	0
1 - 1½ Miles	10
2 - 2½ Miles	15
3 miles	9
4 miles	26



5 miles	10
6 miles	0
7 miles	5
8 miles	1

If we judge the first two categories to be one mile, we determine the mean distance to be 3.4 miles with a median of 4 miles. For those who lived outside a city or village, the following chart indicates the number of times per week the interviewee (or spouse) "got to town".

TABLE 3

Times "Get to Town" Per Week

Times Per Week	Number of Persons
0	7
1	20
2	24
3	15
4	3
5	5
6	12

An attempt was made to determine if there was a relationship between the distance lived from a city or village and the number of times per week one "gets to town".

TABLE 4

<u>Distance from City or Village</u>	<u>Mean times "Get to town" Per Week</u>
Less than 1	1.8
1 - 1½ miles	2.0
2 miles	2.3
3 miles	1.7
4 miles	2.7
5 miles	1.0
6 miles	2.3
7 miles	2.5
8 miles	3.0

Based on these limited statistics, it does not appear that there is any relationship between distance from town and frequency of traveling there. Obviously, other factors determine this frequency.

Retirement

(a) Retirement and Work

Presently retired - 226

Percent retired 87%

Never "worked" housewife - 19

Not retired - 14

Percent not retired 5.4%



(b) Length of retirement

<u>Number of Persons</u>	<u>Length of Retirement</u>
0	Less than 1 year
0	1 year
0	2 years
7	3 years
10	4 years
13	5 years
14	6 years
15	7 years
0	8 years
0	9 years
26	10 years
3	11 years
12	12 years
49	More than 12 years
24	"Not Sure"

Range - 1 week to 34 years.

No mean or median can be determined because of category "more than twelve years".

MONTCALM COUNTY -  
Aging population by  
township

MECOSTA COUNTY

ISABELLA COUNTY

N  
E  
W  
A  
Y  
G  
O  
  
C  
O  
U  
N  
T  
Y

REYNOLDS ▲ 1,830 ■ 12.5 ● 229	WINFIELD ▲ 839 ■ 10.0 ● 84	CATO ▲ 2,205 ★ ■ 13.6 ● 300 LAKEVIEW	BELVIDERE ▲ 1,345 ■ 13.2 ● 177	HOME ▲ 2,487 ■ 11.4 ● 284 ★ EDMORE	RICHLAND ▲ 1,832 ■ 8.4 ● 154
PIERSON ▲ 1,261 ■ 10.7 ● 135	MAPLE VALLEY ▲ 1,476 ■ 13.8 ● 204	PINE ▲ 984 ■ 11.8 ● 116	DOUGLASS ▲ 1,118 ■ 11.3 ● 126	DAY ▲ 1,180 ■ 10.4 ● 123	FERRIS ▲ 991 ■ 8.9 ● 88
KENT COUNTY		MONTCALM ▲ 1,984 ■ 8.5 ● 169	SIDNEY ▲ 1,504 ■ 10.3 ● 155	EVERGREEN ▲ 1,842 ■ 9.1 ● 168 SHERIDAN	CRYSTAL ▲ 1,781 ■ 12.8 ● 228
KENT COUNTY		EUREKA ▲ 1,938 ■ 6.6 ● 128 ★ GREENVILLE	FAIR PLAIN ▲ 1,087 ■ 9.3 ● 101	BUSHNELL ▲ 1,025 ■ 10.2 ● 104	BLOOMER ▲ 1,152 ■ 8.6 ● 99 ★ CARSON CITY

- ★ EXISTING SITES
- ★ PROPOSED SITES
- ▲ TOTAL POPULATION
- % OF POPULATION OVER 65
- NR. OF PERSONS OVER 65

K  
E  
N  
T  
  
C  
O  
U  
N  
T  
Y

G  
R  
A  
T  
I  
O  
T  
  
C  
O  
U  
N  
T  
Y

IONIA COUNTY



3. Administration of the Project.

- a. Describe the proposed number and types of staff to carry out the leadership, planning, nutrition, supporting social services, volunteer activities, and financial management responsibilities of the project. Give special emphasis to (1) the qualifications of the project director; (2) plans for the employment of elderly and minority individuals in paid positions; and (3) persons responsible for nutrition or dietetic services for the project. Include the name of the project director, if known, at the time of application. Also indicate whether the project director is 60 years of age or older.

The nutrition project staff will consist of one full time project director and five part time site coordinators. The project director will assume ultimate responsibility for all aspects of the projects operations with the exception of financial management which will be the responsibility of the Central Administration of Eight CAP, Incorporated. The site coordinators will be responsible for the leadership, planning, supportive social services and volunteers activities at their respective centers and will receive directions, assistance and supervision from the director necessary to insure optimal site performance.

- (1) At a minimum the standards as set by the State agency.
- (2) Efforts will be made to give preference to persons aged 60 and over when qualifications are equal.



(3) Nutrition and dietetic services will be provided by the Montcalm County Cooperative Extension Service Home Economist in cooperation with the Food Service Management at Michigan State University.

b. Describe the proposed use of volunteers in the project, with emphasis on the use of college and high school age individuals in such activities.

It is impossible at this time to expand on the innovative ways in which volunteers will be utilized in this project. At a minimum volunteers will be utilized in the following activities:

1. Transportation
2. Friendly visitors
3. Site maintenance
4. Shopping assistance
5. Recreational activities
6. Personal escort
7. Outreach
8. Community education
9. Legal assistance
10. Home maintenance

c. Describe the plans for the provision of training for project personnel.

The Project Director will attend the National Training Institute as required. This information will then be disseminated to all Site Coordinators by the Project Director. All project staff will receive

instruction regarding basic nutrition pertinent to the aged population from the Cooperative Extension Office. Additional training will be provided regarding social services available through state and local resources by those agencies and organizations which currently provide them. At a minimum, that training will include Department of Social Services, the Department of Vocational Rehabilitation, Montcalm Community College, Montcalm Community Council on Aging, Social Security Administration, Community Mental Health, County Health Department, and Eight CAP legal aid.

d. Set forth the proposed composition of the Project Council.

One member Montcalm County Extension Services

One member Mid-Michigan Health Department

One member Mental Health Department

One member Local Minister

One member Community College Outreach

One member Community Education Directors

One member Friendly Visitors

One member Council on Aging

One member Eight CAP, Incorporated

Two members from each site.

e. Describe how potential project participants were involved in the development of this project application.

Potential project participants have been already involved in the Lakeview

and Edmore pilot projects and provided substantial input in the development of this project application: See attached sheets on Edmore and Lakeview sites.



The Lakeview site will service the following nearby communities:

- a) Howard City and Reynolds Township
- b) Pierson, Maple Hill, and Pierson Township
- c) Trufant and Maple Valley Township
- d) Amble and Winfield Township
- e) Langston and Pine Township
- f) Cato Township

CATO

MECOSTA COUNTY

T. 12 N.-R. 8 W.



SEE PAGE 24

SEE PAGE 20

595

585

©1972 Rockford Map Publs, Inc.

SEE PAGE 10

Montcalm County Mich



# REYNOLDS

# T.12N.-R.10W.

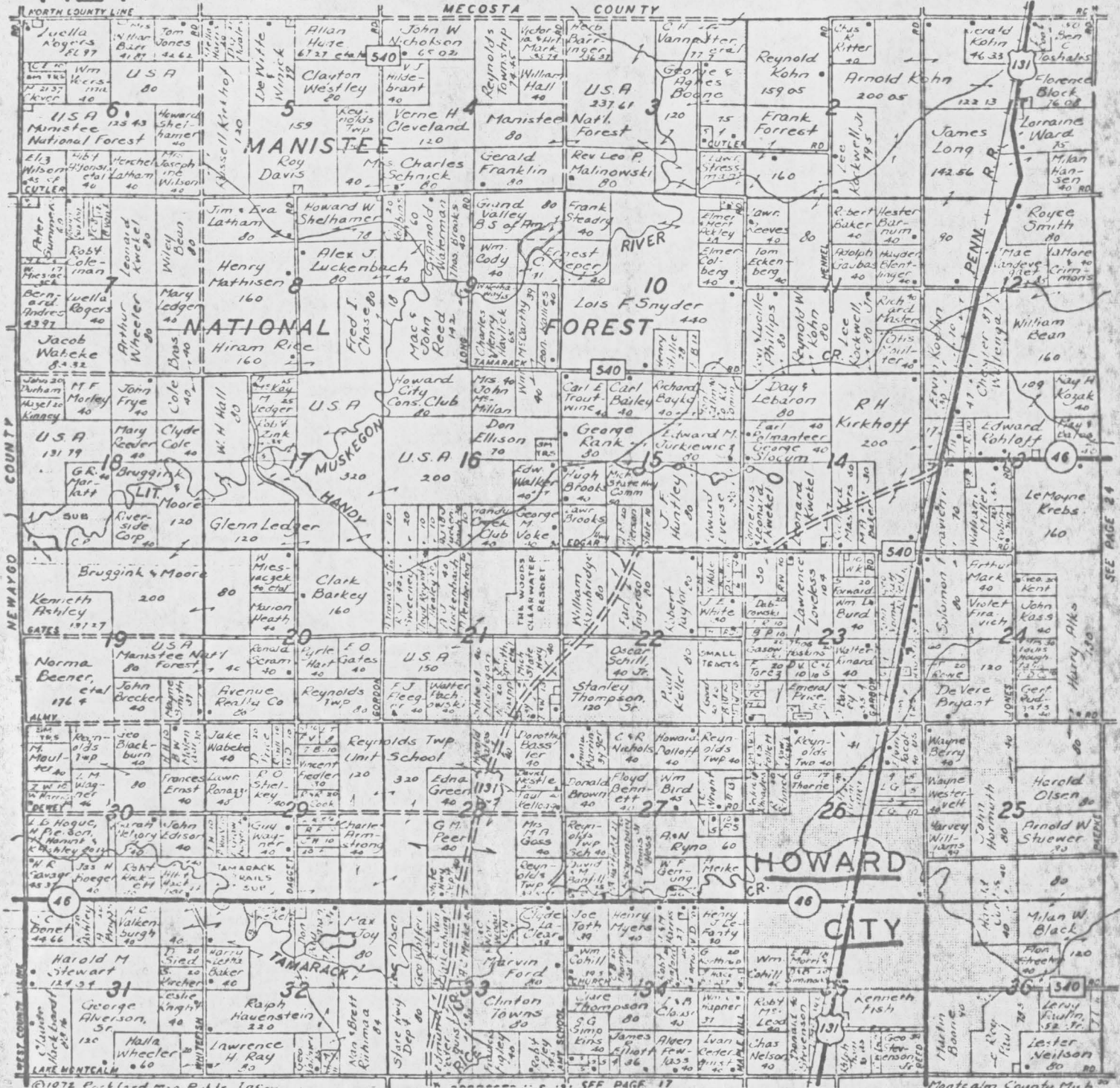



# PIERSON

# T.I.N.-R.I.O.W.

PROPOSED U.S. 131 SEE PAGE 23

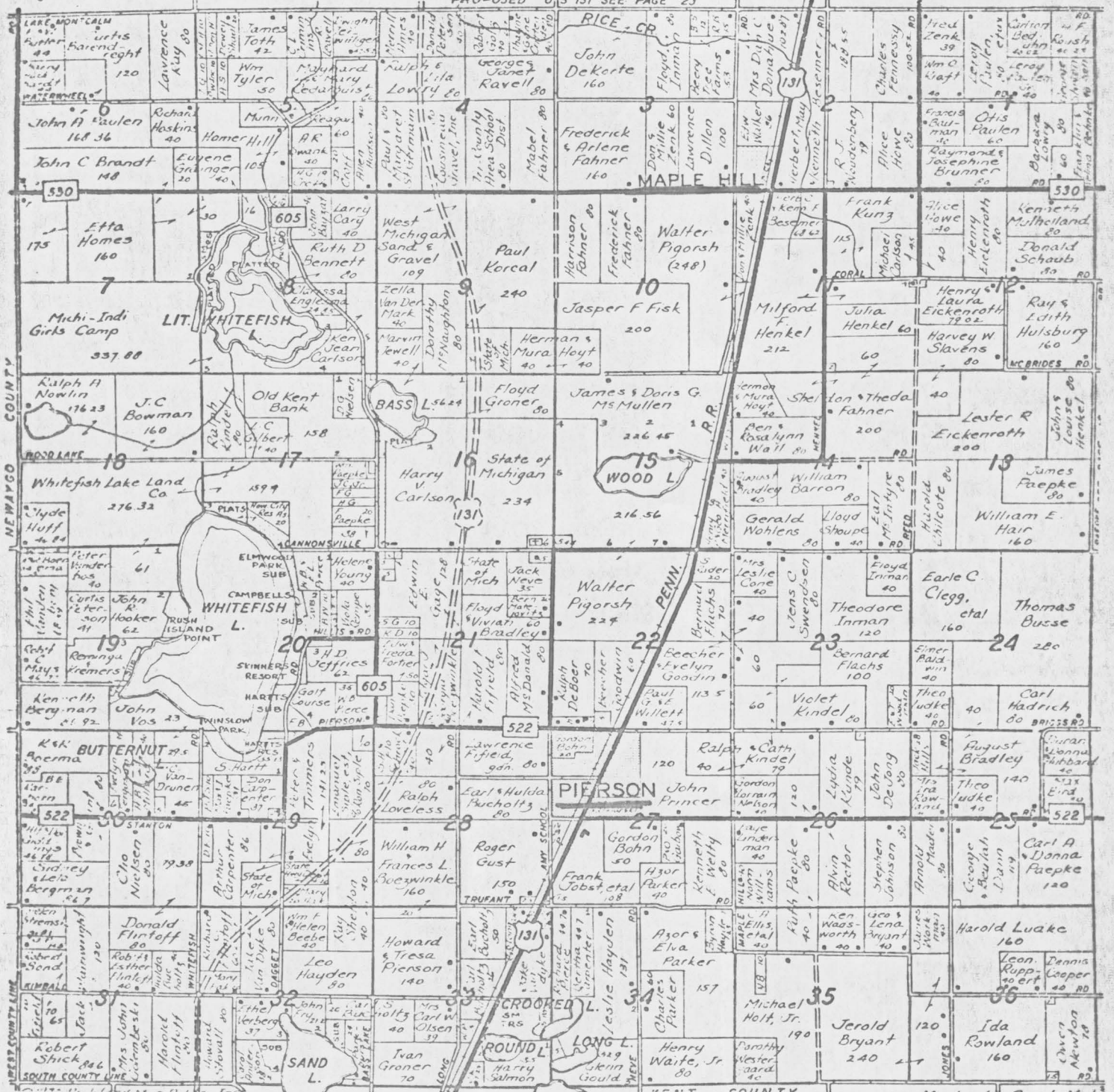

# MAPLE VALLEY

# T. 11 N. - R. 9 W.

SEE PAGE 24



SEE PAGE 17

SEE PAGE 19

©1972 Koford Map Publ., Inc.



# WINFIELD

# T. 12 N. - R. 9 W.

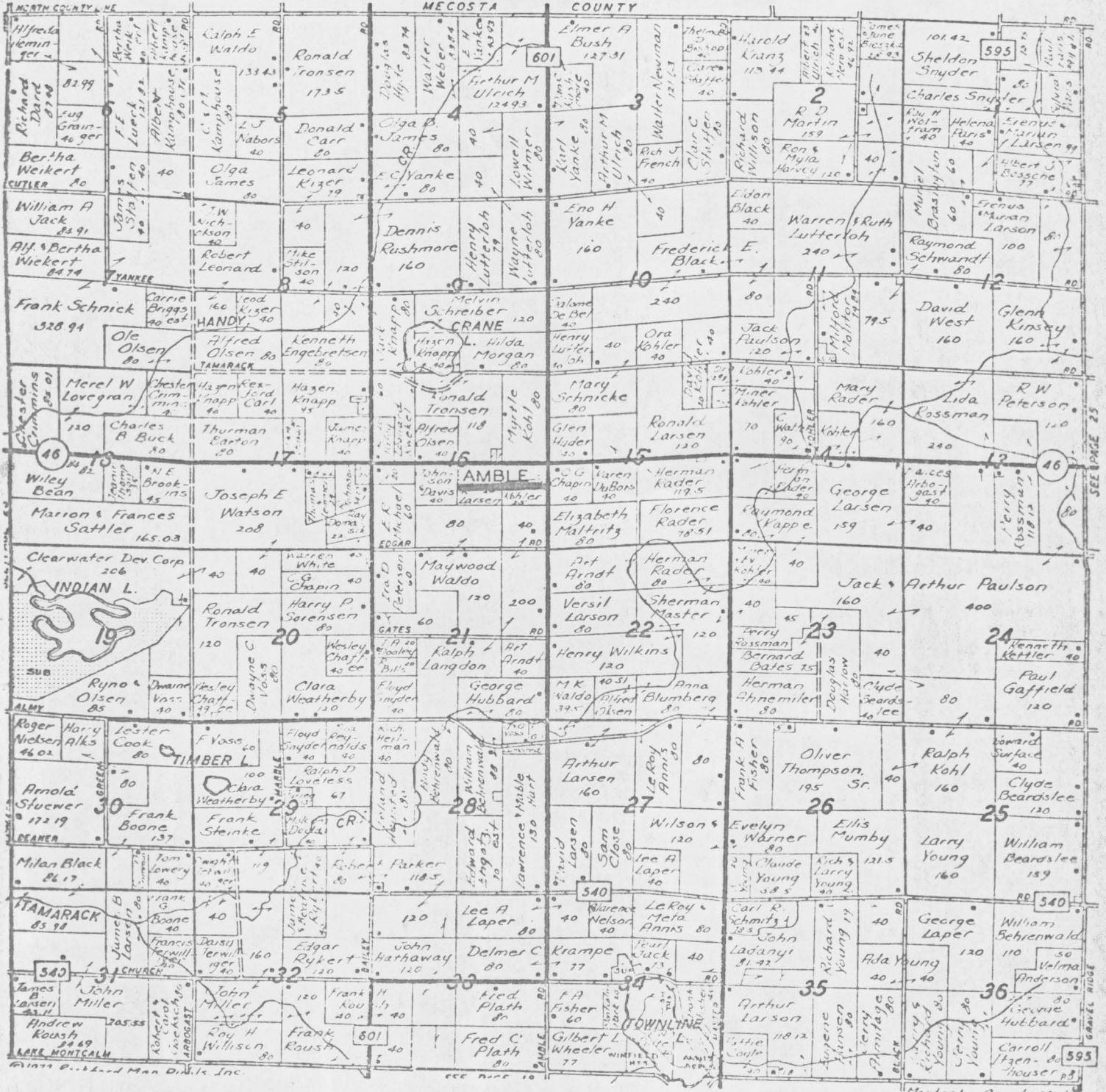



PINE

T. 11 N. - R. 8 W.

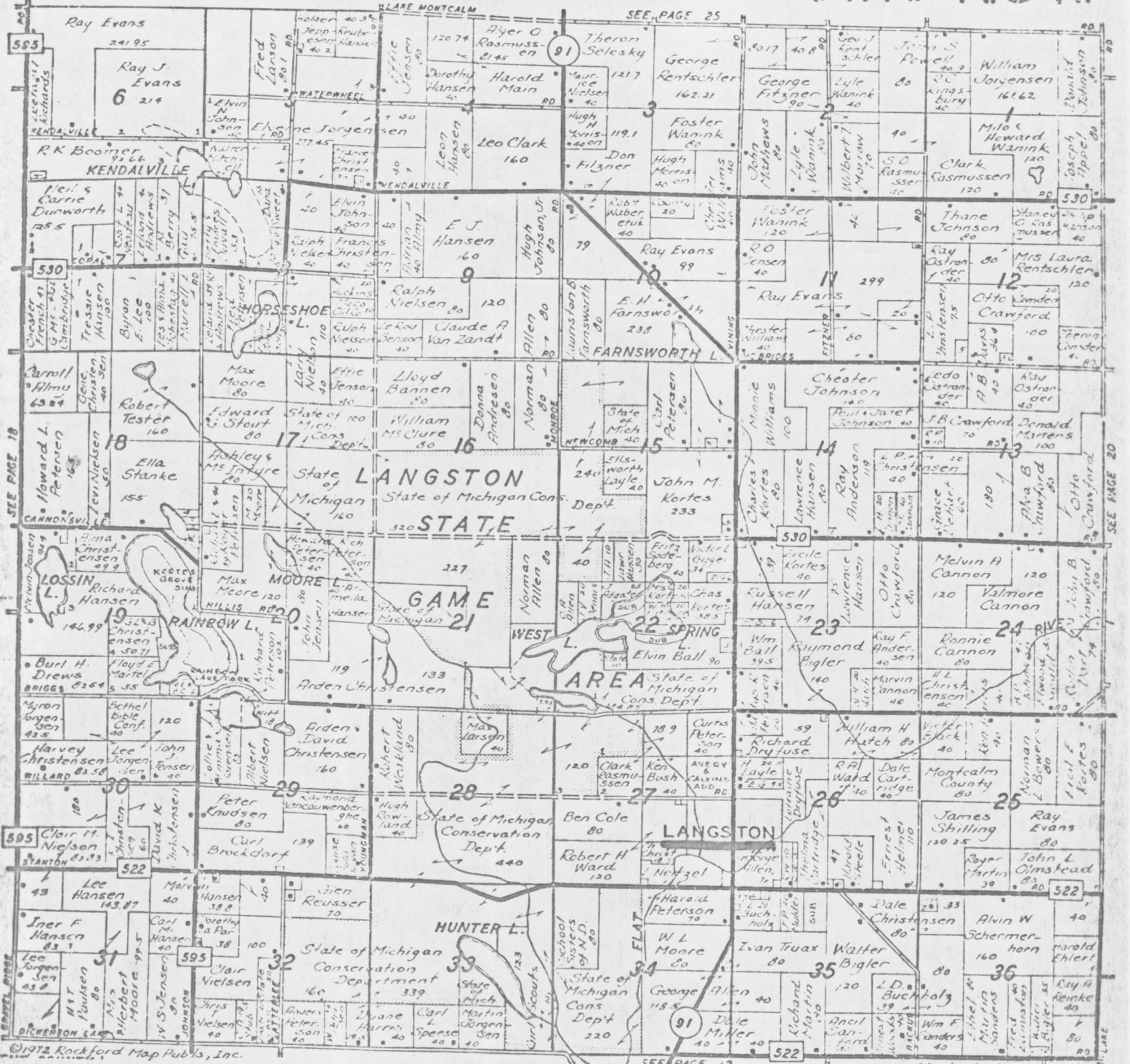

©1972 Rockford Map Publ's, Inc.

SEE PAGE 19

Montcalm County Mich

The Edmore site will service the following nearby communities:

- a) Home Township
- b) Six Lakes and Belvidere Township
- c) Vestaburg and Richland Township
- d) Entrican and Douglas Township
- e) McBride and Day Township
- f) Ferris Township



HOME

T.12N.-R.6W.

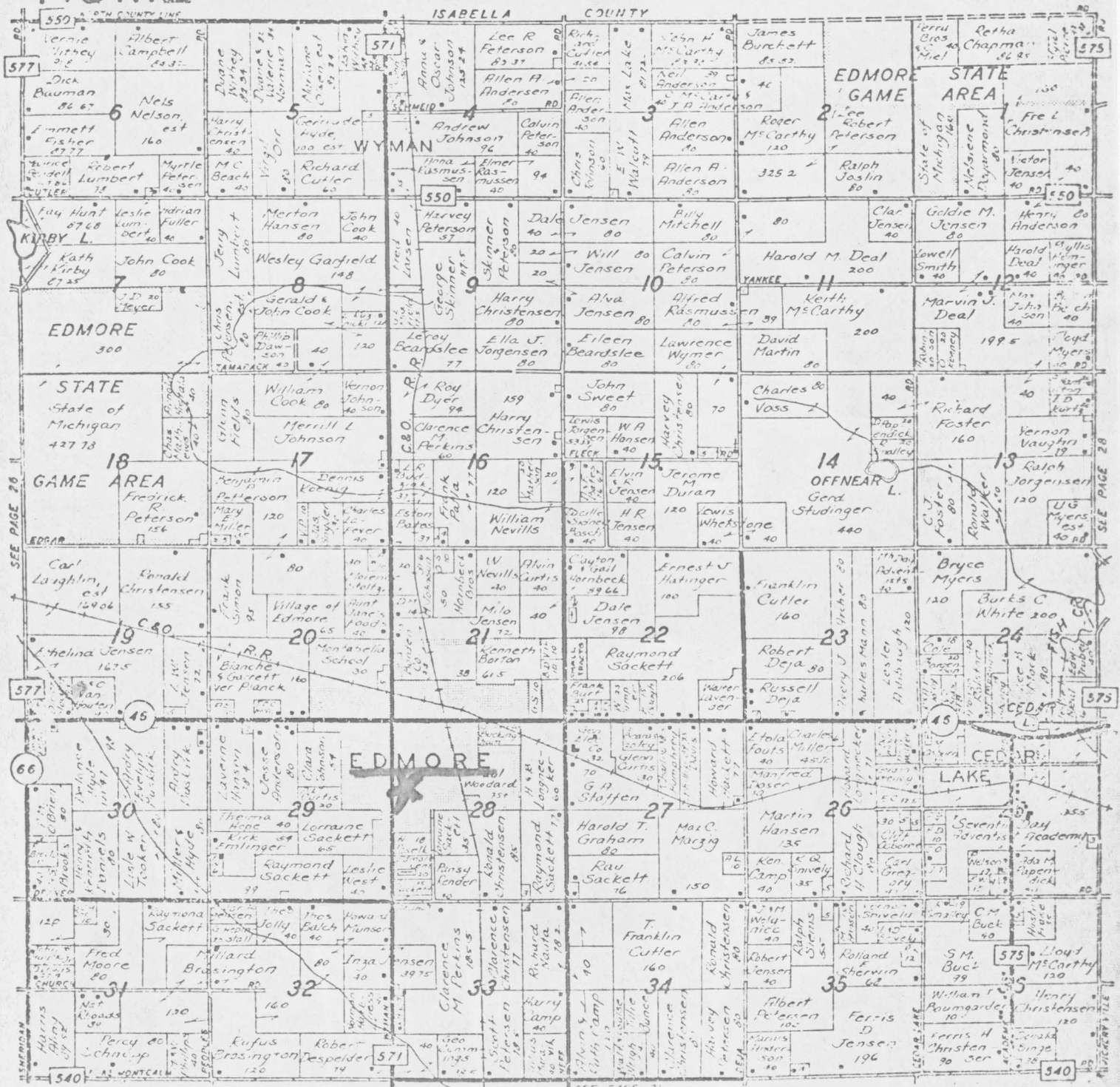



# RICHLAND

ISABELLA COUNTY

# T. 12 N.-R. 5 W.



# BELVIDERE

MECOSTA COUNTY

# T. 12 N. - R. 7 W.

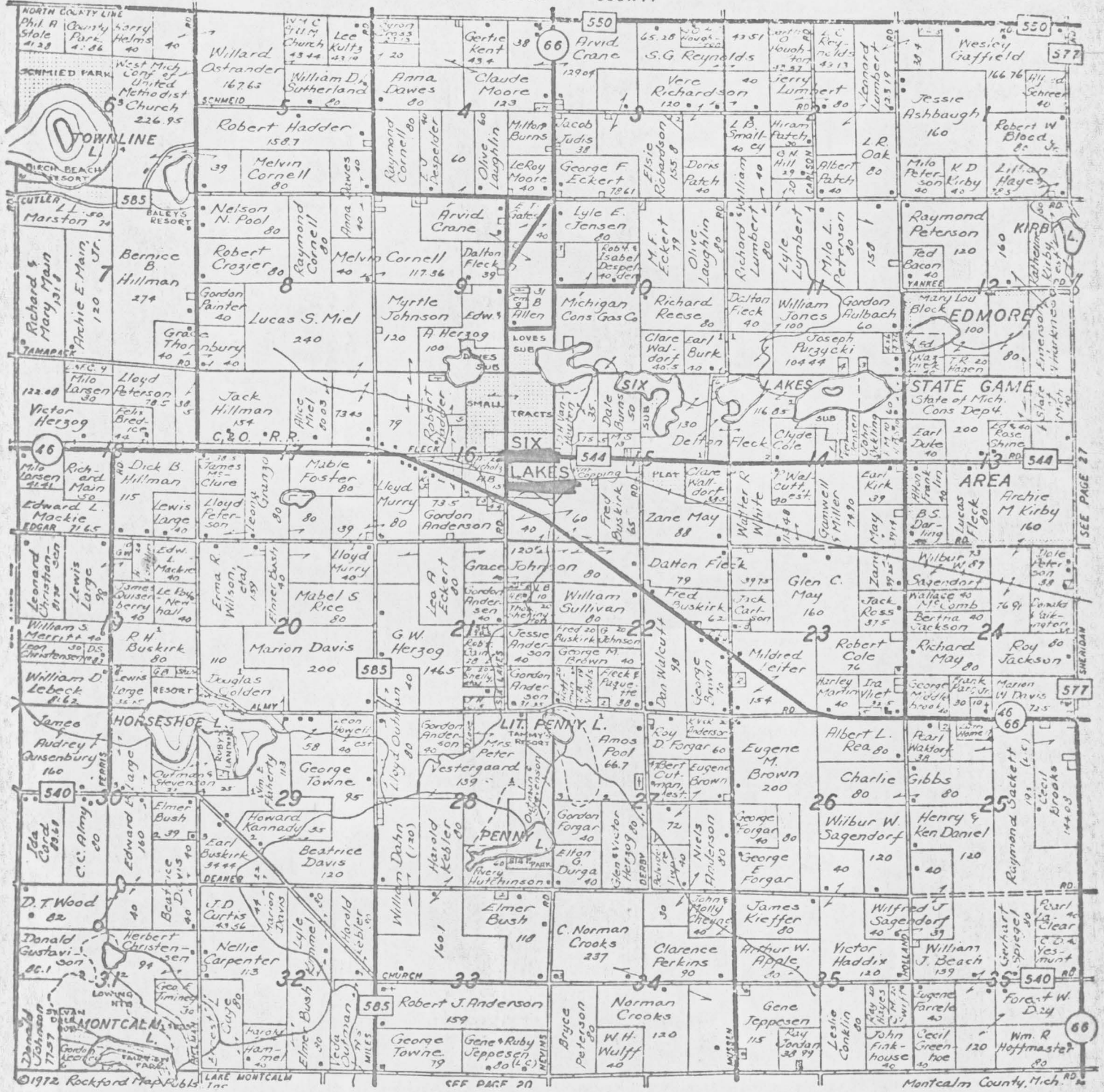

©1972 Rockford Map Publishers

SEE PAGE 20

Montcalm County, Mich.



# DOUGLASS

# T. 11 N. - R. 7 W.

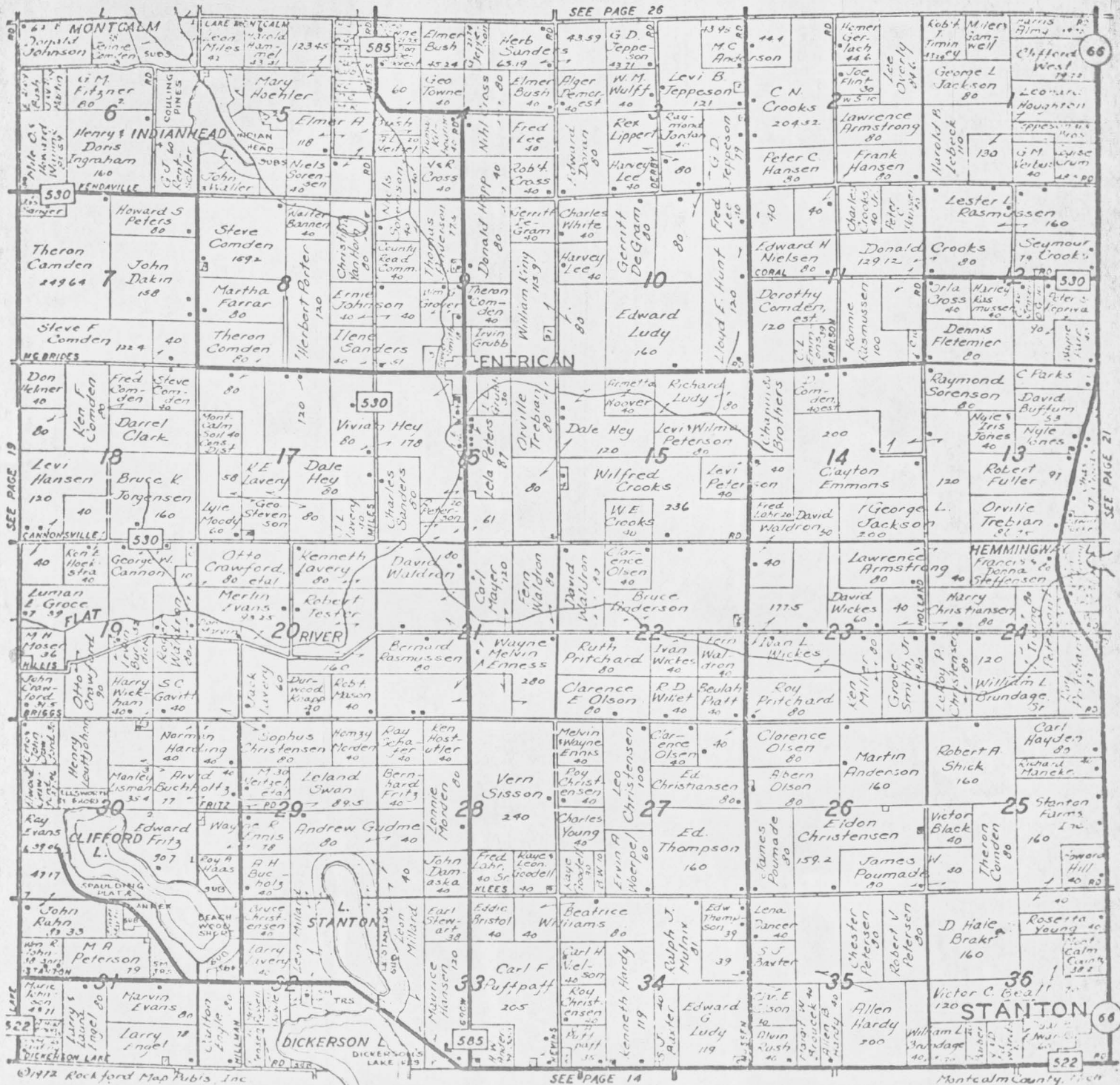



DAY

T. 11 N. - R. 6 W.

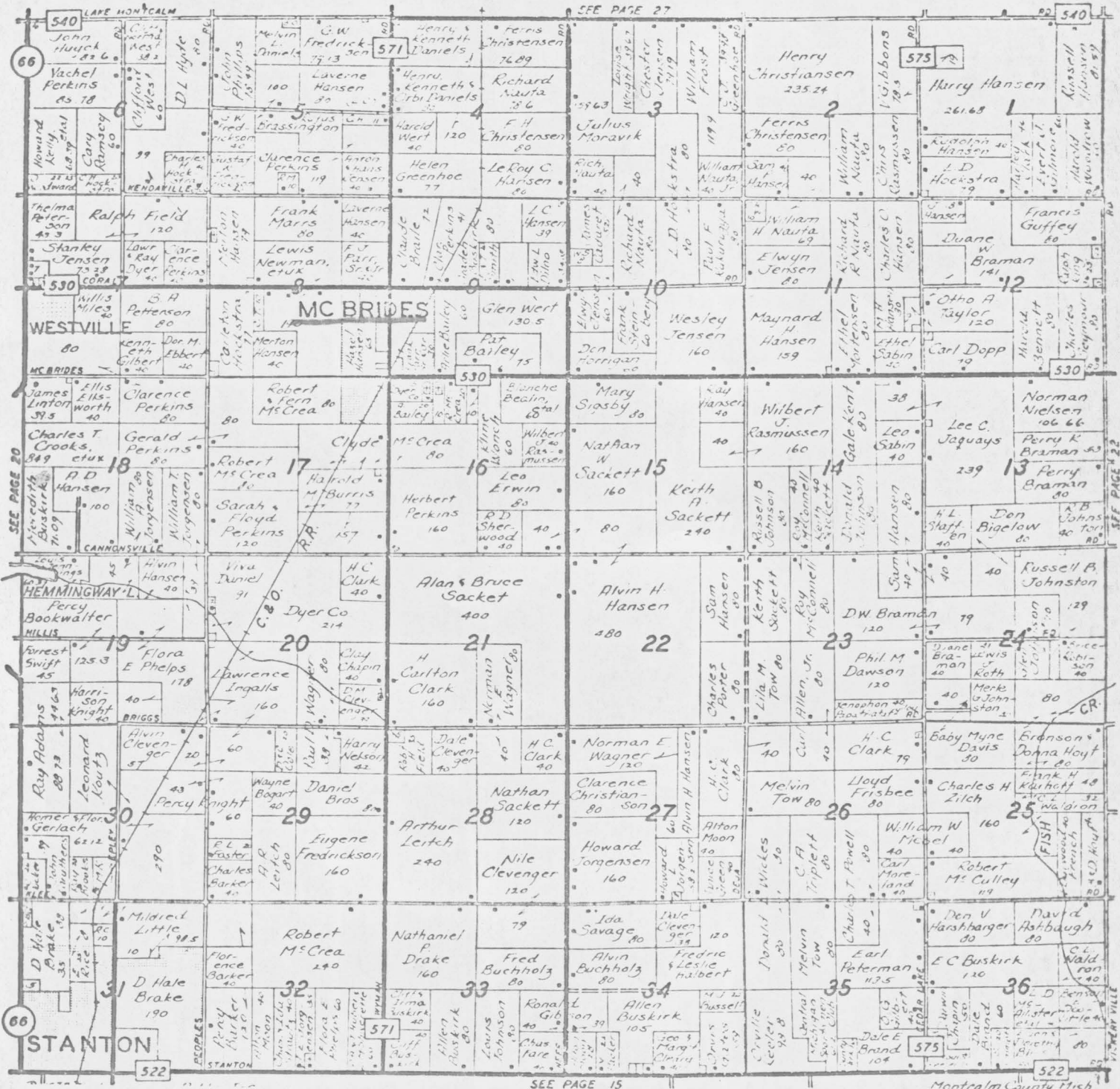

SEE PAGE 15

Montana County Fish

FERRIS

T. 11 N. - R. 5 W.

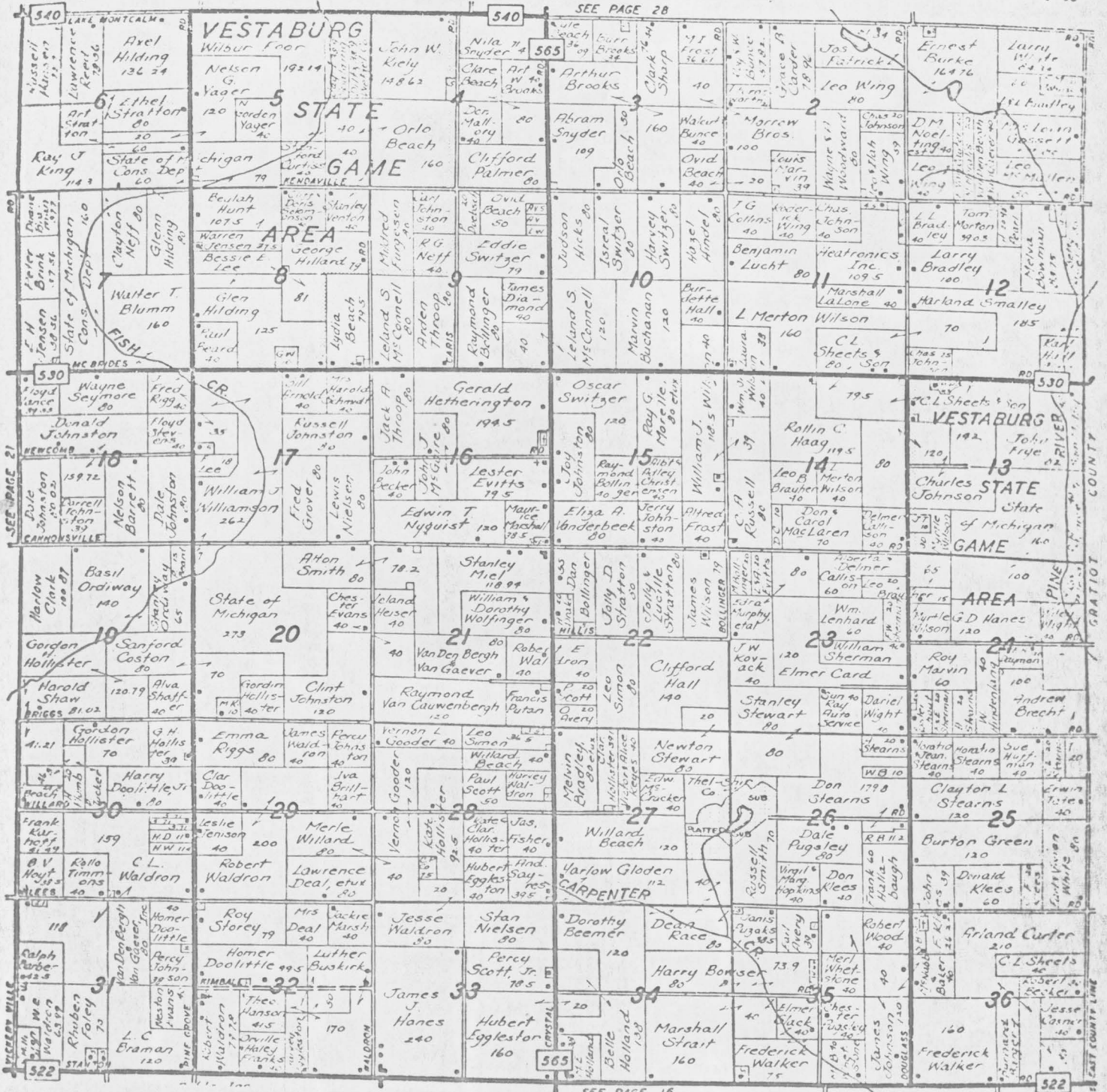



The Carson City site will service the following nearby communities:

- a) Bloomer Township
- b) Crystal Village and Township
- c) Vickeryville and Bushnell Township



# BLOOMER

# T. 9 N. - R. 5 W.

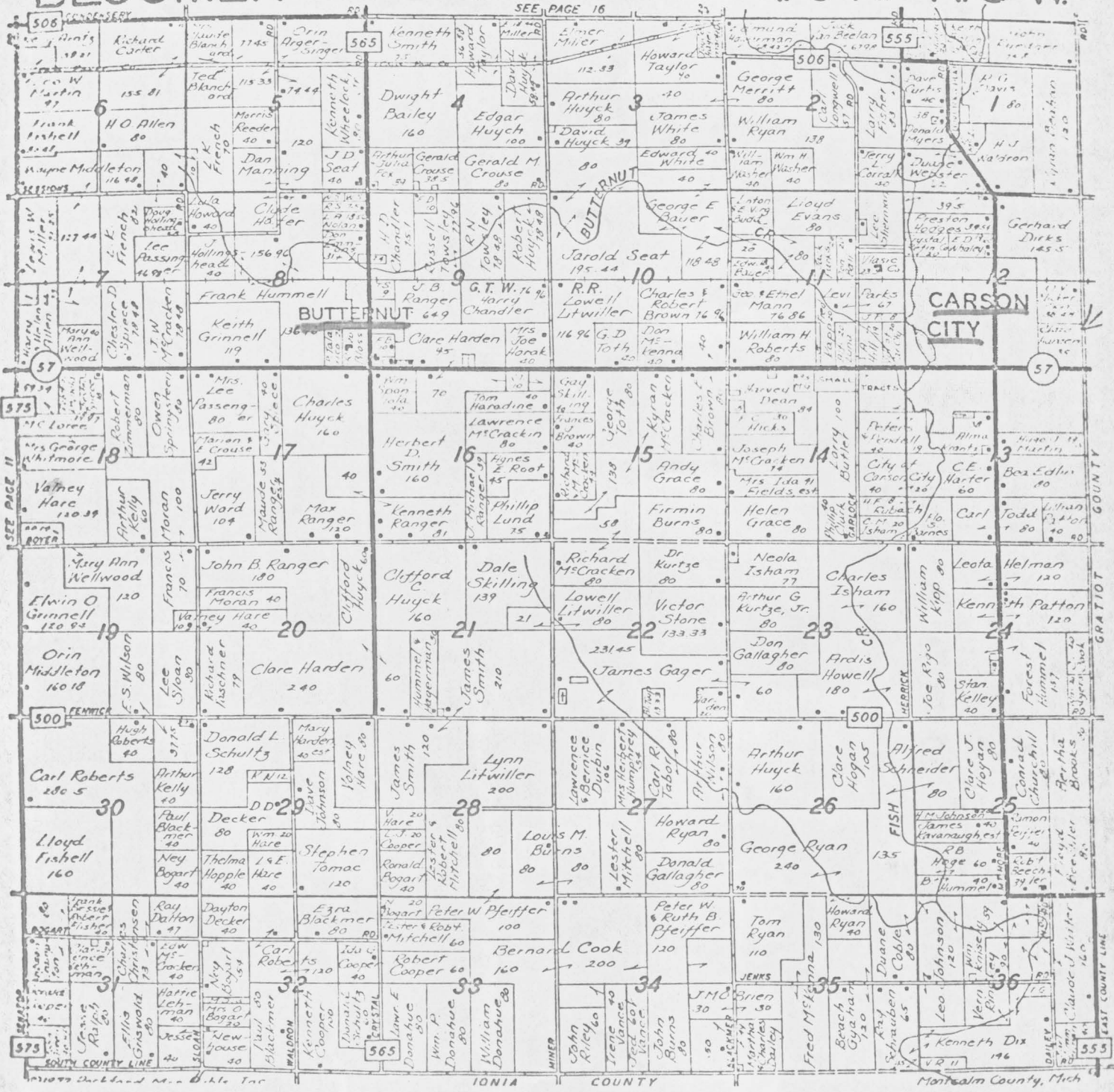





# BUSHNELL

# T. 9 N. - R. 6 W.

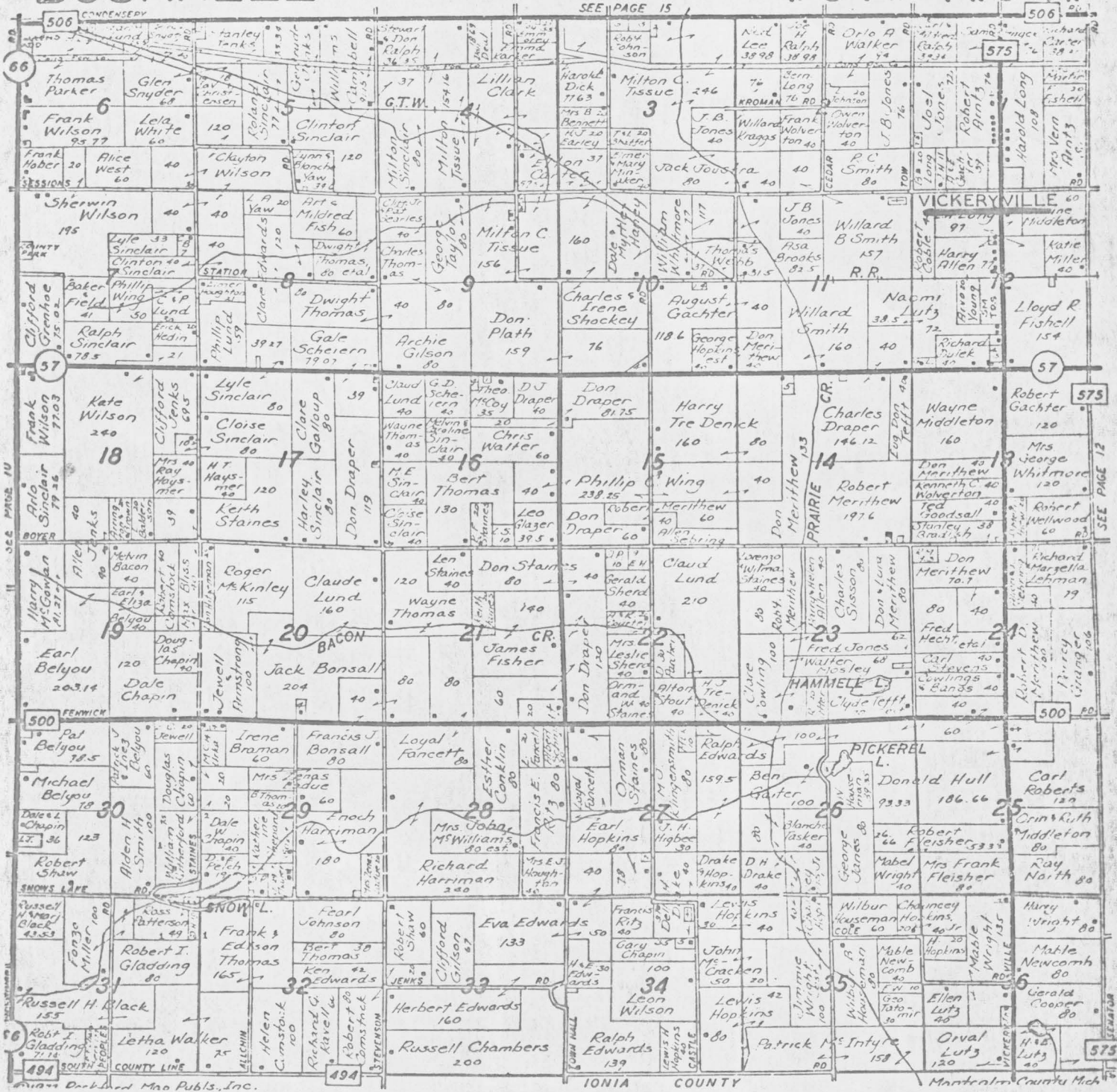



The Sheridan site will service the following nearby communities:

- a) Evergreen Township
- b) Sidney Village and Township
- c) Stanton City
- d) Fair Plain Township
- e) Montcalm Township

EVERGREEN

T. 10 N.-R. 6 W.

SEE PAGE 21

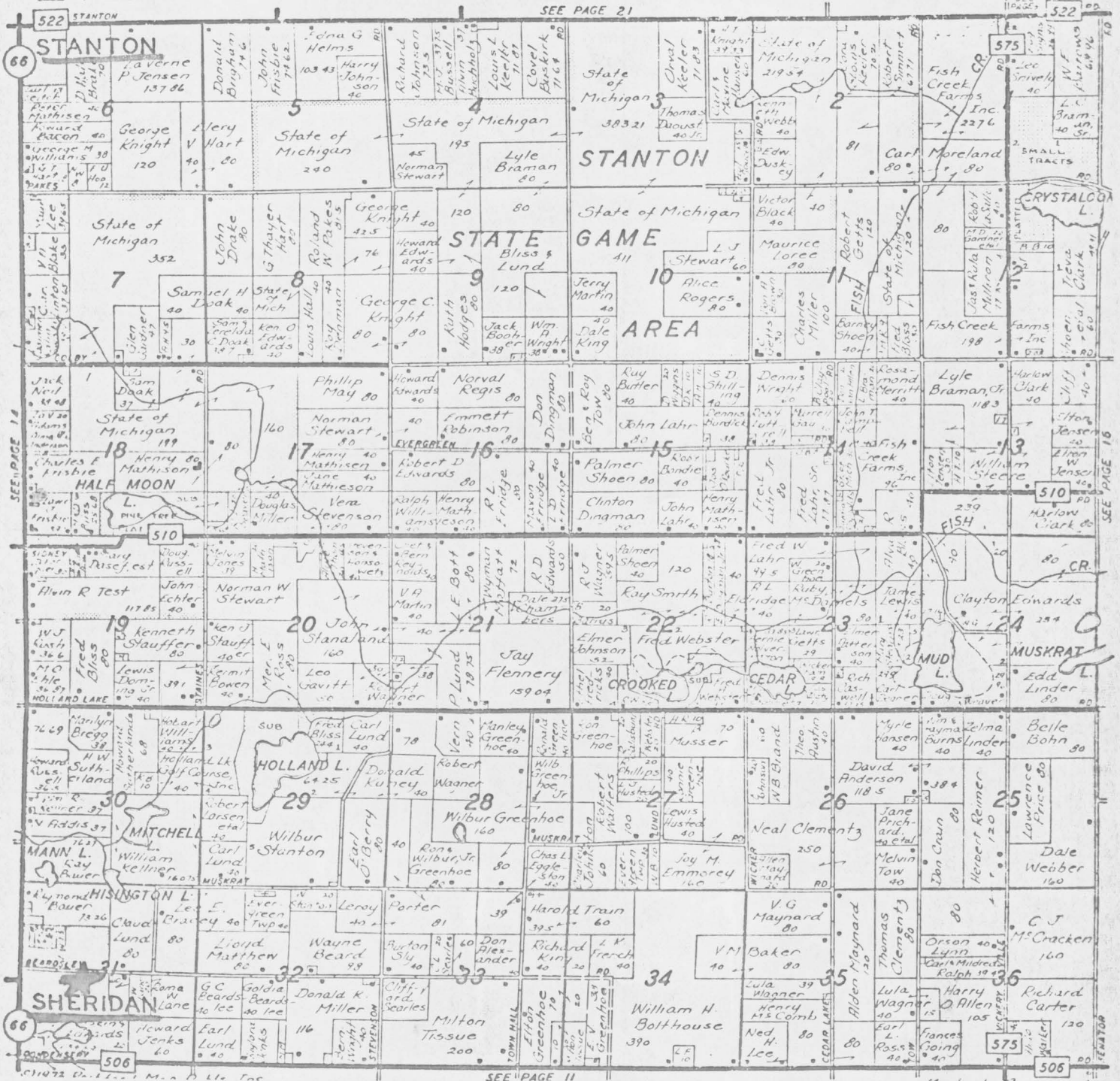

SEE PAGE 11



# MONTCALM

# T. 10 N.-R. 8 W.

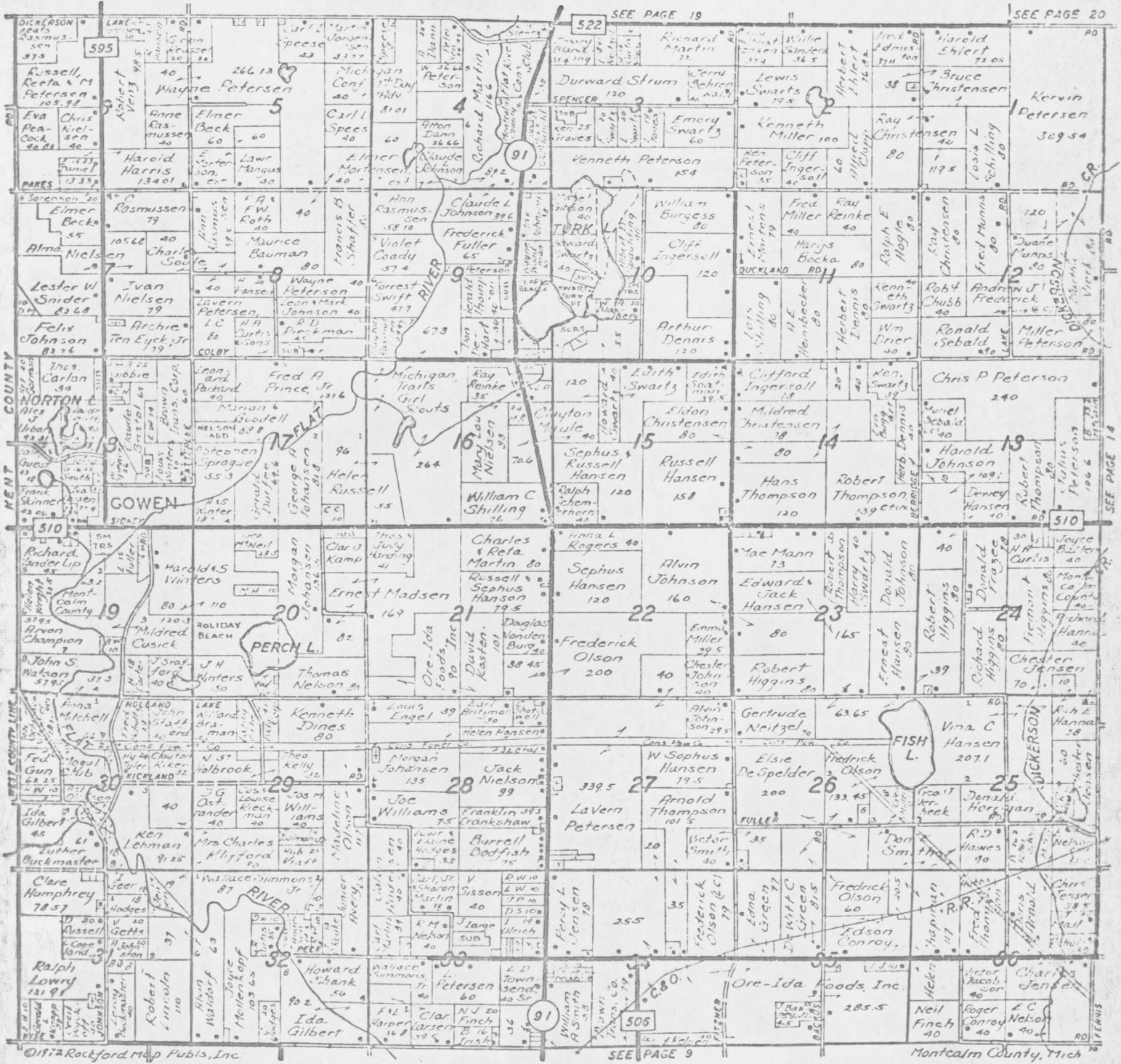

©1972 Rockford Map Publs, Inc.

SEE PAGE 9

Montcalm County, Mich



# SIDNEY

# T. 10 N. - R. 7 W.

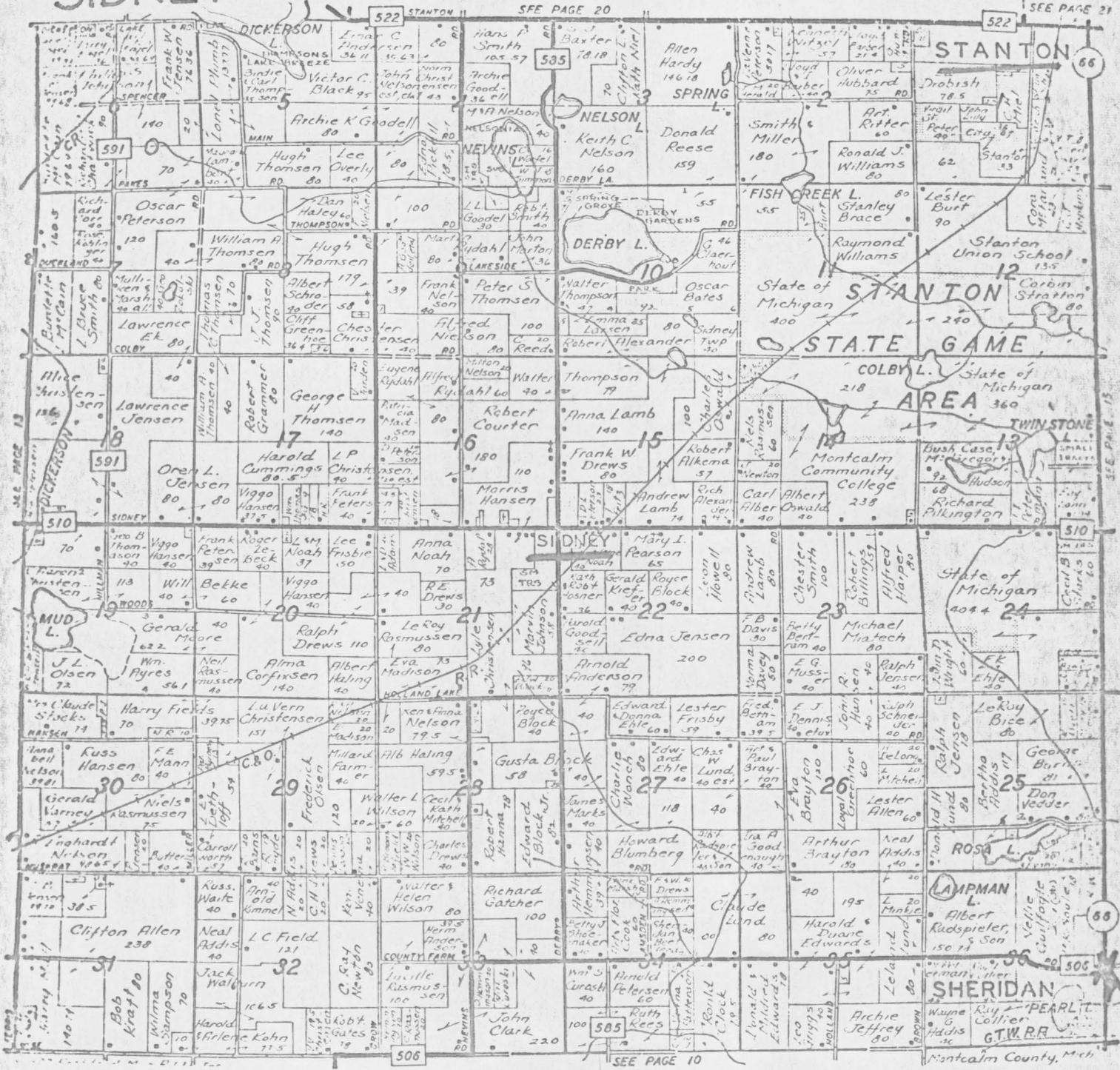

FAIRPLAIN

T. 9 N. - R. 7 W.

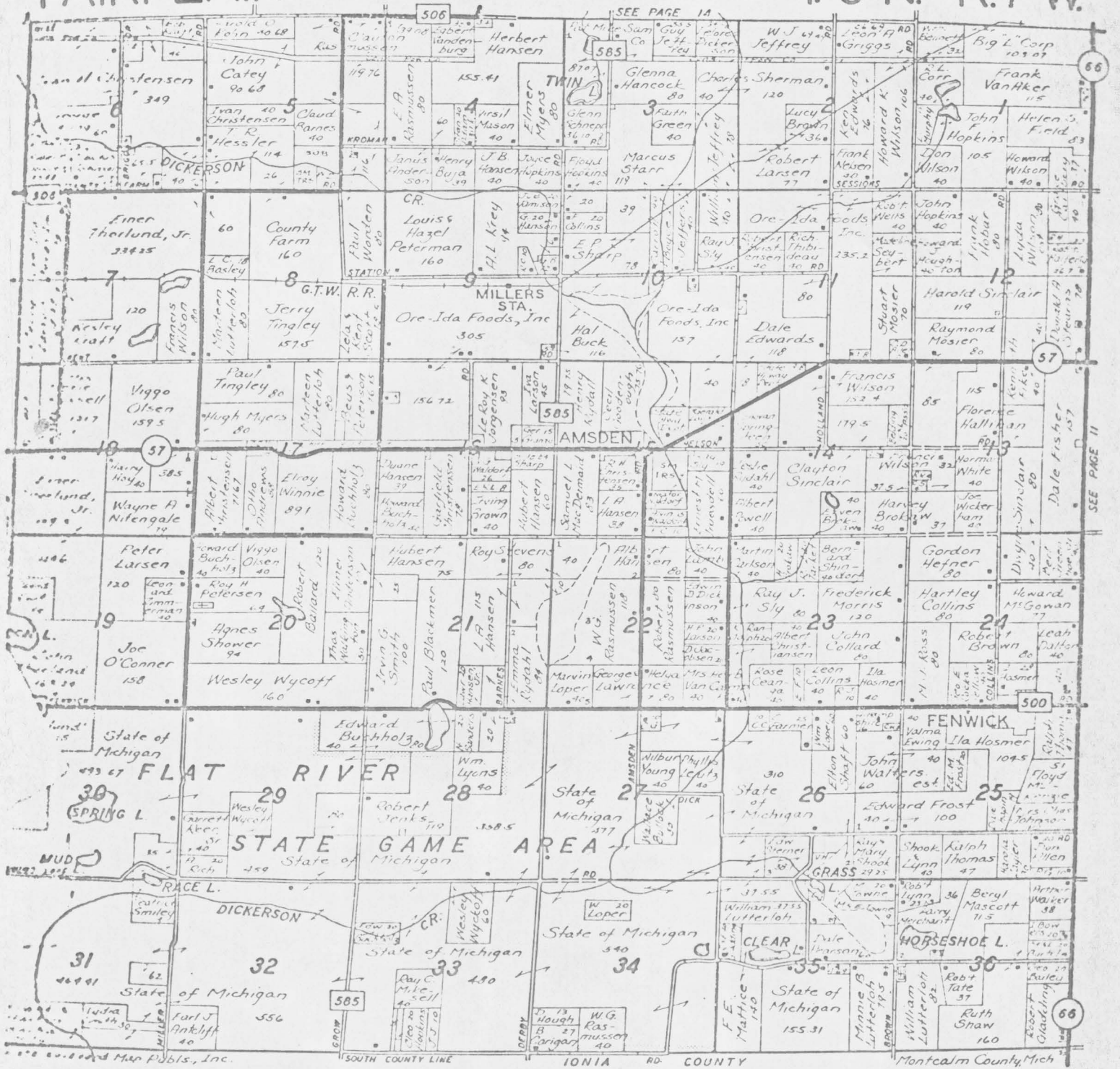



The Greenville City site will service the following  
nearby communities:

a) Eureka Township



# EUREKA

# T. 9 N.-R. 8 W.

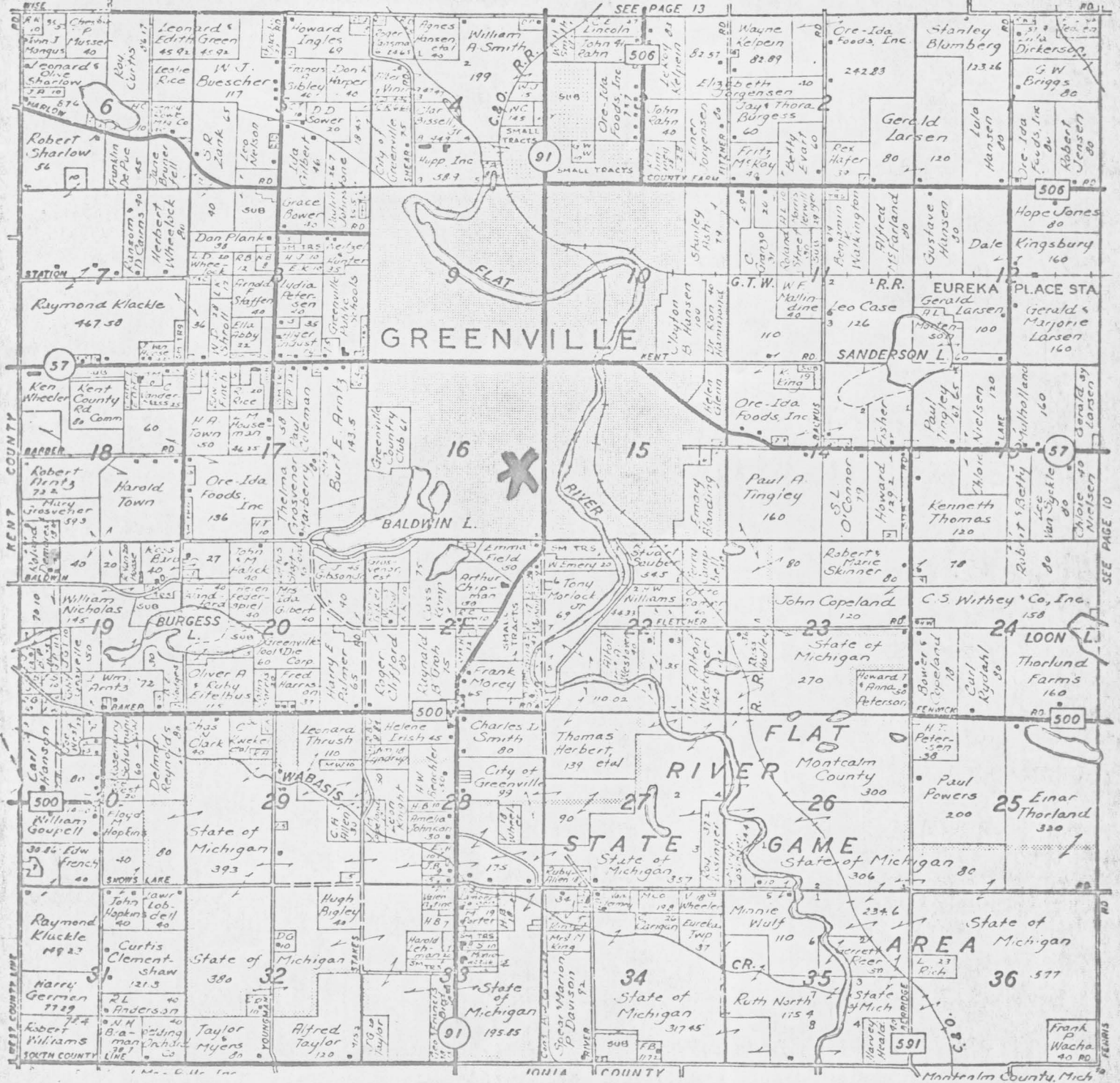

4. Plan for Operation of the Project

- a. Set forth the specific, measurable objectives which have been established for the conduct of the project. These objectives must be related to the number and characteristics of the persons to be served and the services to be provided.
1. To provide 10,400 hot nutritionally sound meals to project participants between January 1, 1974 and December 31, 1974.
  2. To initiate a transportation system to accommodate 5,200 transportation requests from project participants requiring transportation assistance necessary for them to reach the congregate feeding centers.
  3. To identify 1,000 county residents 60 years of age and older and involve at least 100 eligible individuals in the Montcalm County Nutrition Project.
  4. To provide information regarding available county and state social services to 1,000 senior citizens residing in Montcalm County.
  5. To refer at least 500 older Americans to existing social service providers in Montcalm County.
  6. To develop and deliver a twelve hour block of nutritional education to project participants through a one hour per month presentation.
  7. To provide shopping assistance to project participants through the use of volunteers at least one day per week.
  8. To coordinate 300 hours of recreational programs incidental to the project operation to consist of at least one hour and thirty minutes recreational activities at each of the five feeding sites in the project area per week.
  9. To coordinate with the Mid-Michigan District Health Department and the Montcalm County Mental Health Program to provide twelve hours of Health and Welfare Counseling at each of the five feeding sites during the proposed program year.

- b. Describe the overall plan designed for the delivery of meals throughout the project area to accomplish the objectives established for the project. Include specific information on the following:
- (1) How target group individuals will be contacted and encouraged to participate in the project;
  - (2) Who will plan menus; and what special factors, if any, will be taken into consideration in the planning of menus such as health or religious requirements, ethnic, cultural, and regional preferences;
  - (3) The menu which has been developed for the first 30 days of the project;
  - (4) A time schedule for implementation of the provision of congregate and home delivered meals;
  - (5) The number of congregate and home delivered meals (list separately) planned to be served on a daily basis when the project is fully operational;
  - (6) The days meals are to be served (pending subsequent approval by Project Council);
  - (7) Which meals are planned to be served on a daily basis (breakfast, lunch, and/or dinner);
  - (8) Who will prepare the meals and how the meals will be transported to the congregate meals sites and/or the home delivery sites.



- (1) Outreach work has already been done to find elderly persons who are alone, poor, or in some way in need of nutritional services. Continuing efforts will be made using volunteers and other personnel at the selected sites.
- (2) The Montcalm County Extension Service will plan the menus.
- (3) Menus for thirty days are outlined in attached sheet.
- (4) Time schedule for implementation of the provision of congregate and home delivered meals:

Lakeview and Edmore - January 1st

Carson City, Sheridan, and Greenville - January 15th

- (5) The number of congregate and home delivered meals planned to be served when the project is fully operational: 200 meals per week with 5% home delivered.
- (6) Meals will be served Monday through Friday (pending subsequent approval by Project Council).
- (7) All meals will be noontime luncheons.
- (8) All meals will be catered. Home deliveries will be handled by volunteers from the congregate site.

c. For all congregate meals sites describe:

- (1) The locations of the sites and types of facilities to be utilized;
- (2) Reasons for selection of the sites;
- (3) The number of meals planned to be served at each site on a daily basis;
- (4) The estimated number of project participants at each site;
- (5) The proximity of such sites to the homes of target group older persons;

Wadden, Extension Specialist Food Service Management  
 Food Science & Human Nutrition, MSU

WEEK	MONDAY	TUESDAY	WEDNESDAY	THURSDAY	FRIDAY
	Meat balls in gravy on noodles Beet pickles Cauliflower or spinach Glazed carrots or squash or sweet potatoes Oatmeal bread-margarine (orange segments & cottage cheese jello)	Baked chicken or roast turkey Mashed potatoes or potato salad Mixed vegetables Sliced tomatoes or juice WW bread-margarine Apricot halves Molasses cookie	Macaroni loaf or cheese Strats Stewed tomatoes Green beans Golden glow salad Bread-margarine Choc. cup cake or brownie	Esc potatoes & ham or franks or Corned beef hash Fresh or frozen broccoli Citrus fruit salad Corn bread-margarine Strawberry chiffon pie or Deep dish rhubarb pie or rhubarb sauce	Cream of veg soup/croutons Cold plate Tuna or salmon salad Sliced tomatoes or tomato aspic Celery & carrot stick Cheese square Apple muffin-margarine Sliced peaches
	Veal cutlet & mushroom gravy W.K. corn Cranberry juice cocktail 3 bean salad Bread - margarine Baked apple or apple cake/vanilla sauce	Meat loaf or salisbury steak Danish whipped potatoes Vegetable medley (tomatoes, celery, carrots) Cabbage slaw or jellied grapefruit salad Asstd breads-margarine Baked prune whip/custard sauce	Liver & onions or Baked pork chop Sweet potatoes Cottage cheese & fruit salad Bran muffin-margarine Orange sherbet	Spanish casserole or Stuffed peppers or Tossed salad French bread-margarine Jello & fruit or fresh fruit cup Peanut butter cookie or fresh fruit cup	Baked fish Zucchini or green bean Buttered carrots Emerald jello salad Rolls - margarine Cherry crisp with topping
	Creole spaghetti or Ravioli Green beans or buttered cabbage Orange waldorf salad Rye buns-margarine Baked cup custard	Cold plate: Liver sausage or Ham Bologna Bologna Dill pickles Cr potatoes & green peas Cheese yeast muffin-margarine Citrus fruit cup	Chicken & meat balls over brown rice or chicken fricassee with brown rice Spinach & chopped beets Buttered carrots B.P. biscuits-margarine Whole fresh fruit	Beef pot roast or Meat loaf or Swiss stk Brown potatoes or Hash Br potatoes Stewed tomatoes Celery hearts-carrot sticks Asst breads-margarine Baked apple w raisins	Tart fruit punch Macaroni & cheese Broccoli or asparagus Tossed salad Bread-margarine Blueberry cobbler or Berry compote
	Chicken vegetable soup-crackers Cold plate: Macaroni salad or pea and peanut salad Deviled eggs Cherry tomatoes or raw vegetables Hot cinnamon roll Fresh pear or pear halves or sliced banana in orange juice	Chili-Sesame wafers Cabbage & apple salad Raisin -margarine Corn muffins Tapioca pudding orange segment garnish or Rice dainty w/pine-apple	Baked ham or ham loaf or ham pattie Green lima beans Hot apple sauce Tossed salad Asst breads-margarine Pumpkin custard w topping or Pumpkin pie	Tomato juice or orange juice Hamburger pie or Meat veg pie-cheese biscuit topping or Pasties or Beef & veg stew-hot biscuits Salad tray of asst fresh fruits Ice milk sherbet Oatmeal cookie	Tuna noodle & chip casserole Mix froz vegetables or spinach Jellied cranberry relish salad Asst bread-margarine Lemon meringue pie or Deep dish apple pie

DICE OF coffee - tea - milk every day.

(6) Steps to be taken to ensure that the meals sites provide a pleasant setting for the provision of meals.

(1)

<u>Location</u>	<u>Type of Facility</u>	<u>Number of Meals</u>
Edmore	United Church of Christ	40 per week
Greenville	Veterans of Foreign War Hall	40 per week
Edmore	Community Building	40 per week
Carson City	Senior Citizens Drop-in Center	40 per week
Sheridan	Veterans of Foreign War Hall	40 per week

(2) Reasons for selection of sites:

Location of the sites are designed to geographically offer convenient access throughout the county.

The buildings were selected with attractive decor to provide a pleasant atmosphere for enhancing the personal dignity of the participants.

(3) Number of meals planned to be served at each site: 20 meals served twice a week.

(4) The estimated number of project participants at each site: 20.

(5) The proximity of such sites to the homes of target group older persons--see attached maps where sites are located and compared to demographic data.



(6) Every effort will be made to arrange a pleasant atmosphere for the provision of meals. This may include decorating of sites by the participants and staff and special attention in hiring of staff and recruiting of volunteers who provide a pleasant and congenial atmosphere.

d. For projects also planning home delivered meals describe:

- (1) The number of meals planned to be delivered on a daily basis - 2.
- (2) The number of meals planned to be delivered to each home on a daily basis - 1.

e. Pending approval of this proposal by the State agency, and the subsequent approval of the policy set forth below by the Project Council, describe how the cost for meals will be handled, with special emphasis on:

- (1) Will a suggested fixed fee or suggested fee schedule be used? If a suggested fixed fee, set forth the proposed fee. If a suggested fee schedule is to be used, set forth the proposed suggested contribution schedule. (This may differ for different sites.)
- (2) How will fees be collected to ensure that an individual's contribution is confidential and that no indication of a means test is given or implied?

The Project Council will be responsible for setting the final guidelines on fees and fee collection. However, it is the thinking of the proposal writers that a set fee somewhere between 25¢ and 50¢ will be suggested with each individual responsible for contributing this amount on a daily



basis. Fee collection will be arranged so as to be confidential.

5. Plan for Social Services Delivery

- a. Set forth a time schedule for implementation and provision of each of the supporting social services.

Outreach	January 8, 1974
Transportation	January 8, 1974
Personal escort	January 8, 1974
Information and referral	January 22, 1974
Health and Welfare counseling	January 22, 1974
Nutrition education	January 22, 1974
Shopping assistance	January 22, 1974
Recreation incidental to the project	January 8, 1974

- b. Describe how the outreach activities will be conducted on an ongoing basis with special emphasis on:

- (1) The plan to assure a complete and systematic coverage of each neighborhood in the project area to assure that the isolated, homebound and hard-to-reach elderly will be contacted and arrangements made for their participation in the program;
- (2) Indicate the sources of financial support for this effort to be utilized in addition to, or in lieu of, Title VII and non-Federal matching resources.
  - (1) An informational packet regarding the Nutrition Project will be prepared by the Project Director and disseminated to:
    1. All churches in the area of the meal sites
    2. All elected officials
    3. Social Service agencies

4. Hospitals and nursing homes
5. Health Departments
6. Montcalm County Council on Aging

This packet will set forth:

1. The purpose of the project
2. The criteria for participation
3. The services provided by the project
4. The days of meal provision
5. The home address and telephone number of Project Director
6. The name, address, and telephone number of Site Coordinators
7. The method for referring potential project participants to project staff.

Site Coordinators will:

1. Obtain list of registered voters 60 years of age and older from clerk in the site area and request clerk to identify those most in need.
2. Obtain list of senior citizens receiving property tax exemptions from township and village officials and request identification of those most in need.
3. Review list secured with area clergymen requesting identification of those most in need.
4. Review list of potential project participants with County Council on Aging Coordinators to avoid duplication of outreach effort.
5. Submit list to Department of Social Services and request their obtaining release of confidential information from Old Age Assistance recipients to allow site coordinators to contact.



6. Conduct outreach activities on an ongoing basis for those senior citizens most in need of project's services.

(2) Through coordination outreach efforts will be supported by local units of government, County Social Services, Montcalm County Council on Aging, and area churches. Additional outreach efforts will result from the utilization of existing volunteer groups.

c. Describe the plan to provide transportation and escort services to project participants requiring such services.

(1) Indicate the sources of financial support for this effort to be utilized in addition to, or in lieu of, Title VII and non-Federal matching resources.

The County Council on Aging in Montcalm County agreed to support this program by allowing utilization of their existing transportation vehicles whenever possible. Site coordinators and volunteers will provide the remainder of the transportation and escort services required.

d. Describe the plan for the provision of all other supporting social services (information and referral, health and welfare counseling, nutrition education, shopping assistance, and recreation) required by project participants.

(1) Indicate the sources of financial support for each service to be utilized in addition to, or in lieu of, Title VII and non-Federal matching resources.

Information and referral will be provided by the individual site coordinator with additional support from the Montcalm County Council on Aging staff. Training of Nutrition Project staff is being requested from the Department of Social Services and the Social Security representatives. These agencies will be requested to provide staff at feeding sites one hour per month.

6. Relationship of the Project to Other Programs

- a. Describe the activities undertaken with other community service agencies to assure maximum utilization of other public and private resources in support of the proposed project (e.g., joint planning, joint funding). What further efforts are planned to be undertaken in obtaining community agency financial and other support for this project?
- b. What other social services or other elements of this project for which funds are not requested in this proposal will be financed with the resources of other agencies or programs?

See attached letters of endorsement.

7. Evaluation

Describe the plans for ongoing evaluation of project activities to assure the project is meeting the objectives established under 4.a. above.

A monthly evaluation of the project will be conducted by relating the objectives as stated earlier in the proposal to a monthly timetable.

8. Relationship with U.S.D.A. Program

- a. Describe how the project will seek to assist older persons apply for food stamps or donated foods as members of households certified for such assistance under U.S.D.A. regulations.

The project will assist senior citizens in securing food stamp assistance by explaining eligibility, application assistance, and providing transportation to purchase food stamps and to utilize them for home food purchases.

- b. Indicate whether the applicant agency has been authorized to accept food stamps for home delivered meals.

No, but an effort will be made to secure authorization to accept food stamps for home delivered meals.

- c. Indicate the extent to which the applicant agency plans to use U.S.D.A. donated foods in meal preparation.

The applicant agency does not plan to use U.S.D.A. donated foods in meal preparation.

- d. Indicate whether the applicant agency is a welfare agency or a governing body of an Indian reservation if it is deemed a Federal agency by the Bureau of Indian Affairs, which has been authorized for distribution of food stamps or donated foods to households certified for such assistance under U.S.D.A. regulations.

The applicant agency is a private, non-profit corporation.





### III. BUDGET AND FINANCIAL INFORMATION

1. Describe the proposed plan for the management and control of the financial resources of the project. Where subcontracts are proposed, special attention should be directed to the method by which the applicant agency will disburse and account for funds to the subcontracting agency(ies).

Financial management and control will be in accordance with acceptable Federal accounting procedures and accounting requirements as outlined under 27.2 of Title VII of The Older Americans Act.

2. If the non-Federal matching proposed by the applicant agency is less than 10% of the project net costs, set forth a justification as to why the applicant agency proposes a lesser rate of non-Federal participation.

N/A

3. Set forth the amount of proposed project funds earmarked for the provision of training of paid and volunteer project personnel as agreed to in Part I of this application.

\$600.00

4. If the services of volunteers have been included as part of the non-federal participation for the proposed project, the applicant agency must include the rate schedule used to compute such non-federal participation.

N/A

ADMINISTRATIVE FLOW CHART

Montcalm County Nutrition Program for the Aged



Governing Board  
of  
Eightcap, Inc.

Executive Director  
of  
Eightcap, Inc.

Project Director  
of  
Montcalm County Nutrition  
Program for the Aged

Supportive Services  
Committees

Senior Citizens  
Advisory Board

Five Site Coordinators

Edmore

Lakeview

Greenville

Sheridan

Carson City

Volunteer Services

- |                                      |                     |
|--------------------------------------|---------------------|
| Outreach                             | Transportation      |
| Information and referral             | Personal escort     |
| Health and Welfare counseling        | Nutrition education |
| Recreation incidental to the project | Shopping assistance |

ATTACHMENT A



**MONTCALM COUNTY COUNCIL ON AGING**

203½ S. LAFAYETTE STREET, GREENVILLE, MICHIGAN 48838 616 754-7584

November 19, 1973

TO WHOM IT MAY CONCERN:

As a Coordinator for the Montcalm County Council on Aging, I have contacted many Senior Citizens in the past few months. Many of them have need, from a financial standpoint, of a Feeding Program whereby a balanced meal would be provided for them. Many, who live alone and do not have financial need, freely admit they know they don't cook right for themselves because of lack of incentive.

I sincerely hope that our fair share of funds is allocated to Montcalm County for this program because I am sure the need is great.

*Kathryn Swift*

Kathryn Swift, Coordinator  
Central Montcalm School District





NUTRITION PROGRAM

I would like to participate in a nutrition program, when or if we are fortunate enough to have one:

Ruth Neil  
Lucia ~~Wagner~~  
Gladys Pollard  
Violet Walker.  
Jennie Westbrook  
Ella Olsen  
Violet Perry  
Joy Hansen  
Edith Knaggs  
Clara Witten  
Bernice Thomas  
Bessie Brace  
Sarah M. Todd  
Dorothy Marschang  
Kathleen Day  
Sylvia Brown  
Gwendolyn Walker  
Blanche Miskell  
Bernice Loucke

Mary Buchholz  
Hazel Chapin  
Evelyn Anderson  
Lillian Hansen  
Anna + Ola Nielsen  
Carrie Ward  
Kuehl Holverson  
Ella Carr  
William Carr



Stanton, Mich. 48888  
Nov. 7, 1973

Mrs Audrey Marling  
8 Cap  
Sidney, Michigan

Dear Mrs. Marling:

I am pleased to learn of your interest and concern relative to a Nutrition Program for Montcalm County.

This in my opinion, is one of the great needs of the Aged in this and many other areas.

As you are well aware the lack of incentive and often times knowledge of nutritional needs is common among our aged.

I heartily endorse your efforts to obtain funding for this program and assure you I will be most happy to give any assistance that I may.

Sincerely,  
Dr. C. L. Cole  
Prof. Emeritus U. of Mich.



*Kemp  
Insurance  
Sure*

Ph. 616-754-4651  
Greenville, Mich. 48838

To Mrs. Audry Malling  
C/O Community Action Program  
Eight Cap Inc.

November 1, 1973

P. 1  
Subject Gretna, Mich. 48885

Dear Mrs. Malling:

I note that the National Nutritional Program for the Aging has opened centers recently in Edmore and Lakeview and I would like to urge your organization to provide similar facilities in the Greenville area - and of course for all other areas of the County.

Mr. Kemp and I have been instrumental in helping hundreds of people throughout the County in the last several years and we formed Samaritans Foundation to assist in this program.

We know from our personal knowledge that there are many of the aged who really do not have enough to eat and if they were provided one good meal and a little recreation at least three times a week, it would make a great difference in their lives.

I hope you can arrange to extend this program promptly.

Yours truly

*Marian E Kemp*

MEK:ap

KEMP INSURANCE SURE





## SIDNEY CHRISTIAN CHURCH

2917 WEST SIDNEY RD.  
SIDNEY, MICHIGAN 48885



ROBERT D. KING, Pastor  
2894 West Sidney Road  
Phone 517-328-6181

November 20, 1973

Dear Ms. Mallings,

I would like to send my thanks to you for the good work that is being done in the Nutrition Program in our county. I have heard many excellent comments from our Senior Citizens on how they have enjoyed the delicious meals and the interesting programs.

Am very much interested in seeing this program go on, for this is one of the best programs for our elderly. May the Lord bless your work.

Sincerely,

*Rev. Robert King*

Rev. Robert King



Edmore, Pa.

Nov 27, 1973

Dear Mrs Melling; I am writing to  
tell you the Edmore Senior Citizens  
are in favor of the diners at the  
Community Hall in Edmore.

Carrie McCauley

Pres. Edmore Senior  
Citizens.



First Congregational Church  
Stanton, Michigan, 48888

November 14, 1973

To Whom It May Concern:

The Women's Fellowship of the First Congregational Church, went on record, at our November meeting, as approving the Senior Citizens Feeding program, as envisioned by Ms Audrey Mailing of 8 CAP.

We feel the program worthwhile and will fulfill an existing need. We wish it much success.

Very truly Yours,

Women's Fellowship

*Geraldine Peterman*

Secretary





MICHIGAN STATE UNIVERSITY

*Cooperative Extension Service*

U. S. DEPARTMENT OF AGRICULTURE AND COUNTY BOARD OF COMMISSIONERS COOPERATING

*Montcalm County*  
617 N. STATE ROAD  
STANTON, MICH. 48888  
A/C 517 831-5377

November 19, 1973

Mrs. Audrey Malling  
Program Director - Montcalm County  
8-Cap Agency  
Sidney, Michigan

Dear Audrey:

The Extension Home Economist of the Cooperative Extension Service of Montcalm County will be very glad to cooperate with the 8-Cap Agency in an advisory or consulting capacity in the Food Assistance Programs for the Senior Citizens of Montcalm County. There will be available one hour each month for this service.

Looking forward to working with you in this capacity.

Sincerely,



Mrs. Mildred Mahan  
Ext. Home Economist

MM:dh





## MID-MICHIGAN DISTRICT HEALTH DEPARTMENT

**CLINTON**  
BRANCH OFFICE  
ST. JOHNS, MICH. 48879  
224-2195

**GRATIOT**  
BRANCH OFFICE  
ITHACA, MICH. 48847  
875-3681

**MONTCALM**  
BRANCH OFFICE  
STANTON, MICH. 48888  
831-5770

Central Office - Stanton  
November 7, 1973

Ms. Audrey Malling  
Eightcap, Inc.,  
Sidney, Michigan 48885

Dear Ms. Malling:

The Mid-Michigan District Health Department is pleased to endorse the Montcalm County Nutrition Program for the Aging.

If contacted ahead, the health department staff nurses will be glad to speak to the group on subjects such as nutrition and the services available through the health department.

Sincerely,

*Hubert Eggleston*  
Hubert Eggleston  
Acting Director

jm



Carson City, Mich  
Nov. 30th, 1973

To Whom it may Concern:-

The Senior Citizens of Carson  
City are offering their Over  
50 Club House two days a  
week as a Senior Citizens  
feeding station.

Sincerely,

Harvey J. Waldron Pres.





STATE OF MICHIGAN



WILLIAM G. MILLIKEN, Governor

DEPARTMENT OF SOCIAL SERVICES

R. BERNARD HOUSTON, Director

December 3, 1973

COUNTY BOARD  
Donald Peterson, Chairman  
Wm. B. Bennett, M.D.  
Virginia Wood

MONTCALM COUNTY  
DEPARTMENT OF SOCIAL SERVICES  
P.O. Box 278  
617 N. State Road  
Stanton, Michigan 48888  
Phone No. 517 831-5211

Mrs. Audrey Malling  
Montcalm County Program Director  
Eight-Cap, Inc.  
Sidney, Michigan

Dear Mrs. Malling:

Our Department is very conscious of a need for some type of nutritional feeding program for the isolated elderly persons of Montcalm County. There are many elderly persons in the county who do not have an adequate diet and are socially isolated. We sincerely hope that every effort be made to continue or expand a feeding program for these people.

You may call on us for information at any time that we can be helpful in operating such a program. I assume that such a service to you would be equal to, if not in excess of, one hour per month.

Sincerely,

Thayer Hart, Director  
Montcalm County DSS

TH/cmt



Office of Clerk  
VILLAGE OF EDMORE  
EDMORE, MICHIGAN

Mrs. Audrey Malling  
Eightcap, Incorporated  
Sidney, Michigan

Jerry C. Macklin  
Village Manager  
P.O. Box 158  
Edmore, Michigan

December 3, 1973

Dear Mrs. Malling,

The Village of Edmore Council was most interested in the proposal of the Nutritional program for the aged supported by Eightcap, Incorporated which you spoke to us about at our Regular Session held November 5, 1973.

Since that time we have followed the response of the program in our area and find it most worthwhile. We are pleased the pilot program was initiated in Edmore and will continue to support the activities as a liaison in the Outreach Program associated with the above.

Yours very truly,

*Jerry C. Macklin*  
Jerry C. Macklin  
Village Manager



11-30-73

TO: Ms. Audrey Malling, Montcalm County Program Director, Eight-CAP, Inc.

We feel that after participating in the Montcalm County Nutritional Luncheon Program since April of this year it should be continued. It has given us well balanced meals, information on programs that are being given in our community and surrounding areas. We have had speakers from the Dept. of Social Services in Montcalm County who gave us information of what they do such as the areas of mental health, conservation, and home economics. We've enjoyed speakers from our own community, sing-a-longs, trips to a museum--the county fair--county parks--etc. We thank you for the sociability, recreation, and referral services which this program has given and we hope it can continue.

Lakeview Senior Citizens:

Name

Address

Minnie Williams	Lakeview Mich
Dorothy Bristol	" "
Betha Baird	Lakeview Mich
Flossie Schrick	Lakeview Mich.
Samuel H. Bennett	" "
Trances Bussiere	Lakeview Mich
Clyde Simmons	105 1st St Lakeview, Mich
Mildred Magee	147 Washington Lakeview, Mich
Mrs Nellie Potter	325 N. Lincoln, Lakeview Mich
Jarvis Warner	Lakeview Mich
Gladys Parker	Lakeview Mich
Ethel Faling	Lakeview, Mich.
Ernest Closson	" "
Julia Thomson	" "
Fay VanAntwerp	" "





Miss C Dickinson Rock Lake

Mayora Abbott Vestaburg

Floca Billinger

Josephine Cobb Admore

Marquente Hoyt

Carrie Zinn

Ruby Loomis Vestaburg

Dessie Adams Local

Anna Anderson

Rose Moore

Nellie Agler 212 57th St. S.W.



Edmore, Mich  
Dec. 3<sup>rd</sup> 1973

Dear Audrey: With pleasure I can  
give you permission to use our  
Home Township Community Hall for  
your dinners. I have reserved  
for you Tuesday + Thursday for  
12 o'clock dinners.

If there is any thing  
we can do to help please let  
us know,

Good Luck

Bernice Jensen

Home Township Clerk

Edmore, Mich



[Issues] "Aged"

(DANIELS, Donald

hardship of fixed incomes

January 29, 1974

Mr. Donald Daniels  
Box 204  
Concord, Vermont

Dear Mr. Daniels:

Thank you for your letter commenting on the difficulties encountered by senior citizens and handicapped persons living on fixed incomes.

Your feelings about this serious problem are certainly appreciated and I will do all that I can to be of assistance.

As you undoubtedly know, the President has now signed into law an 11% increase in social security to take effect in two steps during the first six months of this year.

Thank you again for writing.

Sincerely,

Gerald R. Ford

GRF:abs





Concord, VT.  
Oct. 18, 73.

Dear Mr. Ford:

If Congress  
will do best  
to help  
etc



Congradulation  
on President Nixon's choice  
for Vice President and do  
hope that Congress and Senate  
agrees with same choice. As  
you may know the people  
are getting so they do not  
think much of our government  
specially Mr. Nixon which  
is treating the aged, blind,  
disable like dogs.

When they say that cost of  
living has dropped they are  
liers, food goes up all the  
time and people with low  
pensions are <sup>not</sup> able to even buy  
a pound of hamberg cause it  
cost too much.

People are very much discourage

II

about Mr. Nixon and have a perfect right to be. Pensions are way below the cost of living and he passed a bill to increase of a mere 5% in July of next year which people have been suffering since last increase which cost went up regularly and they say one tenth of 1% which there is no such figures people are not as crazy as our government think they are. Mr. Nixon gave this noble prize very quickly but increase in social security no, wait another year. People cannot afford to buy food for their health in this country and will not be given the appro-



III

periat pension to live on  
but send wheat + grain to  
other countries plus lot of  
other food and to hell with  
this country, United States of  
America, which the hypocrites  
say they love so much.

John Connelly a rascal to  
Democrat + disgrace to the  
Republicans, he is an educated  
fool and says he is going to  
educate people. Why should  
any one be deprived or I should  
say, why should this country be  
deprived of good living for  
account of those educated fools,  
\$61,000. is lot of money for a  
prize when the poor pensioners  
are nearly starving.

George Meany the Union





IV

President is not interested  
in the aged people that  
had to work - all their lives  
for peanuts and give part of  
their wages to support the  
Government people from  
President down through and  
what are they giving them in  
return after they are not able  
to work and take care of them-  
selves but a damn slice of  
dry bread and glass water.

I hope they all land in Hell.  
Educated fools are ignorant in  
other words. I have written to  
some Congressman & Senators  
some answers others ignores it,  
and that is what they are.

Sincerely Donald Daniels  
This is on behalf for an <sup>Boy 204</sup>  
increase in social security <sup>Concord, VT</sup>  
before next year. <sup>over.</sup> 05824

are they going to cut down  
on the oil heating of in  
the White House and to  
Mr. Nixon's three mansions?  
300 Telephone.

He is not a man worthy to  
run this country.

Get him the hell out of there  
the sooner the better.

Thank you.

VT  
02824

Issues

Aged

(Russell, Laura B)

January 3, 1974

Mrs. Laura B. Russell  
516 Patterson Street  
Marion, Ohio 43302

Dear Mrs. Russell:

This is in regard to your recent thoughtful message to the Vice President.

Although the Vice President is away from the city at the present time, he has asked me to express his thanks for writing.

You may be assured your comments have been carefully read, and Mr. Ford appreciates that you have taken the time to write in this connection.

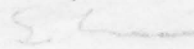
Sincerely, 

A. B. Schram  
Assistant to the  
Vice President





I am 83 yrs old taking sight married  
6 yrs. NO 12462. M passed away Jan 24 1972  
suffering from a Bad and a left stroke just out of what class  
mother of a 42 yrs old woman Kourvet 1302  
\*affiliated voters. This would be Spiro C greets

In closing I say May the all wise and wonderful  
creator whom we always has taught to  
Oversance as the truly or Almighty God  
have mercy on our poor sinned soul if we  
can find And I do mean sincerely.

Good Reactions

Laura B Russell

516 Patterson st

Merion OH 43302



I am 83 yrs old take my sight medicine  
61 yrs. NO 12th 62. My Pass away Jan 24th 1972 Mother  
suffering from a Bad and left stroke just out of hospital  
mother of a 42 yrs old would know it Bad  
\*ad passad votes. This would be Spere C grants

In closing I say May the all wise and wonderful  
creator whom we always has taught to  
Ouerance as the truly or Almighty God  
have mercy on our poor sinned soul if we  
can find And so near schincha.

Good Reactions

Laura B Russell

516 Patterson st

Merion OH 43302



*Issues*

*Aged*

*Hechsel, Dorothy*

January 3, 1974

*re: post hospital  
nursing home care*

Ms. Dorothy Hechsel  
202 West Exchange  
Spring Lake, Michigan 49456

Dear Ms. Hechsel:

This is in regard to your recent letter expressing your views relating to the problem of obtaining post hospital nursing home care.

Although the Vice President is away from the city at the present time, he has asked me to express his thanks for writing.

You may be assured your comments have been carefully read, and Mr. Ford appreciates that you have taken the time to write in this connection.

Sincerely,

*H. B. Schram*

A. B. Schram  
Assistant to the  
Vice President





Date

From: Dorothy Hechel  
202 W. Exchange  
Spring Lake, Mich.  
49456  
Zip Code

To: Hon. Gerald Ford  
U. S. Senate - Senate Office Bldg.  
Washington, D. C.  
20510  
Zip Code

I, as a Senior Citizen, and a participant in the Medicare Program, am writing concerning the problem of obtaining post hospital nursing home care.

Our present Medicare Program provides for nursing home care after hospitalization. However, in our area no nursing home will accept Medicare patients.

They will accept Medicaid patients and those who have sufficient money to afford a prolonged stay in their facilities.

It appears that only the very poor and very wealthy can obtain nursing home care in this area. Those of us who do not fit in either of the above categories, i.e., who have too much income to qualify for Medicaid and not sufficient money to pay for a prolonged stay, can not obtain nursing home care and benefits.

I pay \$6.80 per month for Medicare, and according to my policy am entitled to this care. I, as a Senior Citizen and a participant in the Medicare Program, wish to go on record as protesting this inequity.

Thank-you for your help.

Sincerely yours,

Dorothy Hechel.

I also am opposed to patients being classified as "basic and skilled" before one can get Medicare assistants in qualified Medicare Homes.



*Issues*

*Aged*

*Crebassa, Helen M.  
re: past hosp.  
nursing home  
care*

January 3, 1974

Mrs. Helen M. Crebassa  
17737 West Spring Lake Road  
Spring Lake, Michigan 49456

Dear Mrs. Crebassa:

This is in regard to your recent letter  
in support of post hospital nursing home care.

Although the Vice President is away from  
the city at the present time, he has asked me to express  
his thanks for writing.

You may be assured your letter has been  
carefully read, and Mr. Ford appreciates that you have  
taken the time to write in this connection.

Sincerely,

*H. B. Schram*  
A. B. Schram  
Assistant to the  
Vice President



Date

From:

Mrs. Helen M. Crebassa  
17737 West Spring Lake Rd.  
Spring Lake, Mich. 49456

Zip Code

To:

Mr. Gerald Ford  
U.S. Senate  
Washington D.C.  
20510  
Zip Code

I, as a Senior Citizen, and a participant in the Medicare Program, am writing concerning the problem of obtaining post hospital nursing home care.

Our present Medicare Program provides for nursing home care after hospitalization. However, in our area no nursing home will accept Medicare patients.

They will accept Medicaid patients and those who have sufficient money to afford a prolonged stay in their facilities.

It appears that only the very poor and very wealthy can obtain nursing home care in this area. Those of us who do not fit in either of the above categories, i.e., who have too much income to qualify for Medicaid and not sufficient money to pay for a prolonged stay, can not obtain nursing home care and benefits.

I pay \$6.80 per month for Medicare, and according to my policy am entitled to this care. I, as a Senior Citizen and a participant in the Medicare Program, wish to go on record as protesting this inequity.

Thank-you for your help.

Sincerely yours,

(Mrs) Helen M. Crebassa  
Sec. Sixty-Plus Club  
Spring Lake, Mich.





ISSUES

"Aged"

(CONKLIN, Chris)

December 4, 1973

Miss Chris Conklin  
Community Health Service  
1619 Walker, N.W.  
Grand Rapids, Michigan 49504

Dear Miss Conklin:

My Grand Rapids office has informed me of your recent call to request a copy of the "Older Americans Comprehensive Services Amendments of 1973."

I am happy to send you a copy along with some other additional information in which I thought you would be interested. I trust this information will be helpful to you.

Warmest personal regards.

Sincerely,

Gerald R. Ford, M.C.

GRF:t



Miss Chris Coublin  
Community Health Soc  
1619 Walker NW  
04

Older American Comprehensive  
Services Amendment of '73

S/N 5270-01866

Wayne A Peterson is it pending  
Gordon Drummond

---

Jon Dexter & wife }  
Genl Josephson }  
John Brewer }  
Stabury Hall  
& Ford Ofc



[Issues]

"Aging"

(KIMMEL, William)

wheel-chari deaths

October 19, 1973

Mrs. William Kimmel  
3842 Grape, N. E.  
Grand Rapids, Michigan 49505

Dear Mrs. Kimmel,

Your recent letter with the enclosed clipping regarding two elderly gentlemen who died in a hospital while waiting to be admitted to a nursing home has been received.

I wholeheartedly agree that this is a most deplorable situation. President Nixon and his Administration has recognized the need to initiate programs to assist the elderly in their retirement years, and if and when these programs can be implemented, many situations such as the one about which you wrote can be eliminated or at least alleviated.

An Administration on Aging has been established in the Department of Health, Education, and Welfare. This Administration has the responsibility of developing programs to assist the elderly in many ways. Right now the emphasis seems to be on programs that would enable older people to continue living in their own homes.

I am enclosing a copy of the President's Message to the Congress in which he makes recommendations for action on behalf of older Americans. I would like to call your particular attention to the section relating to nursing homes and the action of the federal government to upgrade the quality of these homes.

I certainly share your concern that conditions such as the article describes exist anywhere in our country. You may be certain that I will do my best to see that corrective legislation is considered.

Warmest personal-regards.

Sincerely,

Gerald R. Ford, M.C.  
GRF:rl

Encl.





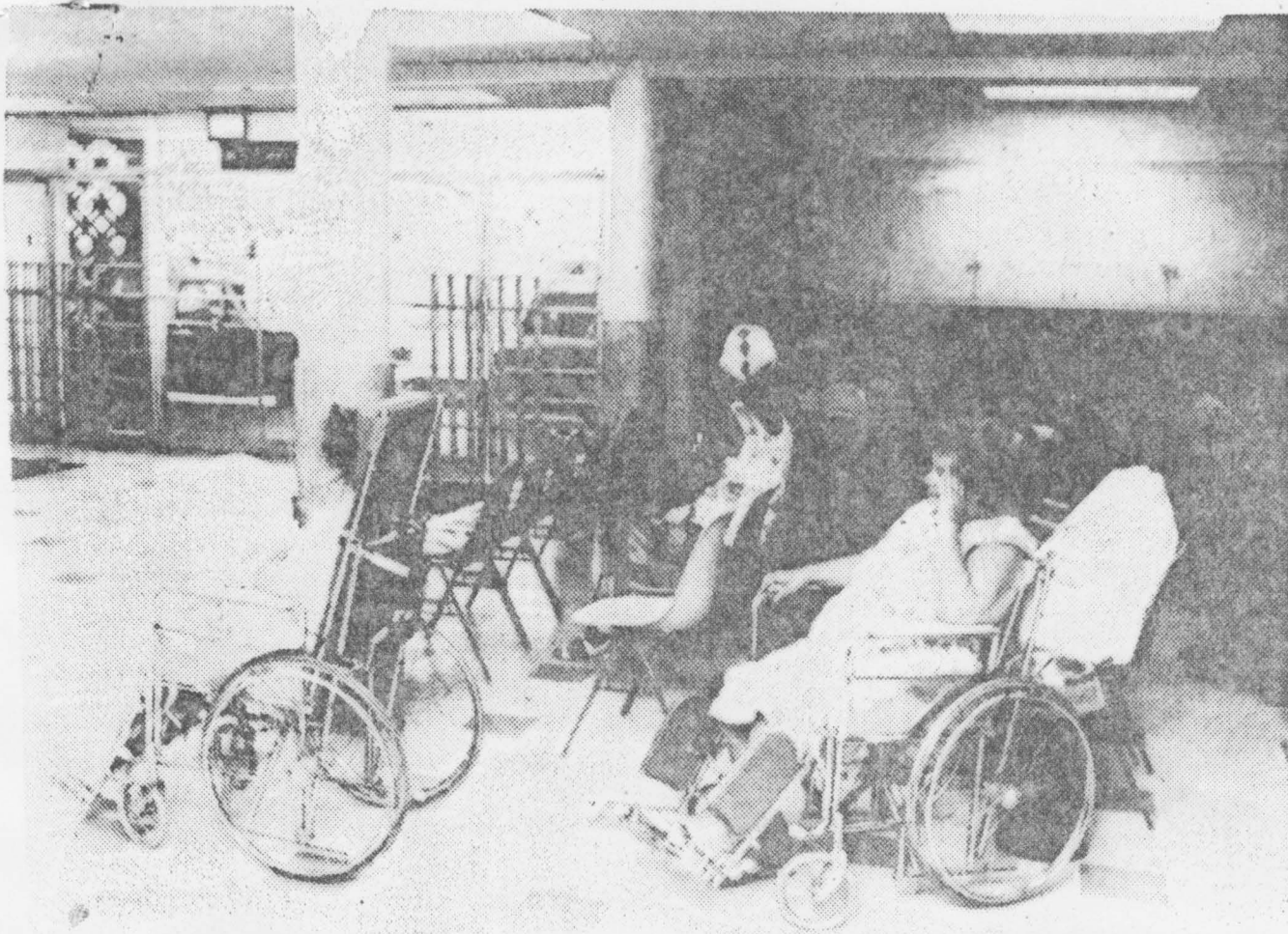

AP Photo

Elderly Wait for Space to be Found for Them in Nursing Homes

## *Old, Ill and Penniless, Two Die Unnoticed in Hospital Wheelchairs*

IAMI (AP) — Volton Jordan and  
ence Brinson were critically ill, home-  
and penniless. They died sitting in  
elchairs in a hospital emergency ward,

two days. A medical examiner said Jordan  
died last Friday of heart disease, with other  
complications. He said Brinson died last  
Tuesday of chronic pulmonary disease.

three times a day and care for any other  
needs that boarders may request.”

Officials say finding nursing home beds  
for the indigent is becoming more difficult



October 3, 1973

Representative Gerald Ford  
House of Representatives  
Washington D.C.

Dear Sir:

The enclosed article appeared in the Grand Rapids Press on  
Monday, October 1, 1973.

I was appalled to learn that such conditions exist in our  
United States. How come our government cannot provide for  
these people? They seem to have enough to send help over  
the entire world - Vietnam, Nicaragua, - where ever there  
appears to be a need - we furnish three mansions for Nixon -  
and what happens to the untold millions of dollars that  
flows through Washington? I believe it is about time we  
start looking out for our own people - the aged - the needy-  
this is truly a disgrace to our nation. I hope something  
will be done to alleviate such situations.

Sincerely,

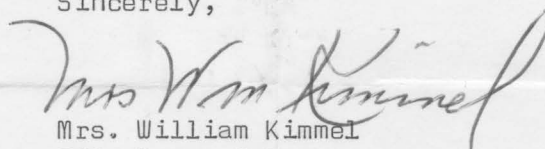

Mrs. William Kimmel  
3842 Grape N.E.  
Grand Rapids, Michigan 49505



ISSUES

"Aged"

(HUNTER, Robby)

re: "I am 8 years old. How old are you?"

October 19, 1973

Mr. Robby Hunter  
5026 Cloyce  
Fort Worth, Texas 76118

Dear Robby:

Thank you very much for your thoughtful letter. I appreciated the kind words you said on my behalf.

To answer your questions, I am the same age as President Nixon--60 years old. My first name is Gerald but I prefer to be called "Jerry." I have three sons named Jack, Mike and Steve and one daughter, Susan. I am sending you a family picture that was taken in our home last Christmas.

It was good to hear from you and I hope I continue to deserve your support and trust.

With kind regards.

Sincerely,

Gerald R. Ford, M.C.

GRF:t

Encl.





RETURN TO

Robby Hunter

ca. 5026 Cloyce

Ft. Worth, Texas, 76118

U.S. POSTAL SERVICE

Dear Mr. Ford

How do you like being  
Vice President of the U.S.A.?

How old are you? How old  
is Nixon? What is your first  
name. We have six in our  
family. How many do you  
have in your family. I am

from California. My Mother's  
Name is Maureen My father's

Name is Ron. I am eight. My  
name is Robby. I am in third

grade. I think your even  
with ~~QA~~ Nixon you are both  
nice. I bet you are gone  
to make a good Vice  
President of the U.S.A.

Your truly

friend

Robby Hunter

Right back

Please

When you have time

